

Plan W69377AM: Curb Appeal in Traditional Duplex Plan



House plans are Copyright © 2009 by our architects and designers.

- Wonderful traditional elements mark the exterior of this duplex plan and give it plenty of curb appeal. Though smaller in square footage, each side holds plenty of living space and three bedrooms. The two units are identical, though mirror imaged, with one small exception: the left-hand unit has a slightly larger master bedroom.
- A covered entry opens each plan and leads down a hall, past the open-rail staircase to a dining room and a living room. The living room contains sliding glass doors to the rear yard. The kitchen has a peninsula with double sink overlooking the living room. The single-car garage is accessed via a service entry with half-bath.
- The bedrooms are on the upper level: two family bedrooms and a master suite. Both the master salon and Bedroom 3 are vaulted. A laundry alcove is also on the upper level.

Style: Multi-Family

Total Living Area: 2904

Main Flr.: 620

2nd Flr.: 832

Total Square Feet: 3,378 sq. ft.

Attached Garage: 1 Car, 237 sq. ft.

Bedrooms: 3

Full Bathrooms: 2

Half Bathrooms: 1

Width: 20'

Depth: 53'

Maximum Ridge Height: 30'

Exterior Walls: 2x6

Ceiling Height:

Other: Vaulted MBR & BR#2

Standard Foundations: Crawl

Alternate Foundations: Slab (\$125), Basement (\$275)

Special Features: Narrow Lot, CAD Available, PDF

One Set	Five Sets	Eight Sets	Reproducible	PDF File	CAD
\$625	\$675	\$775	\$1,050	\$1,050	\$1,700

Main Level

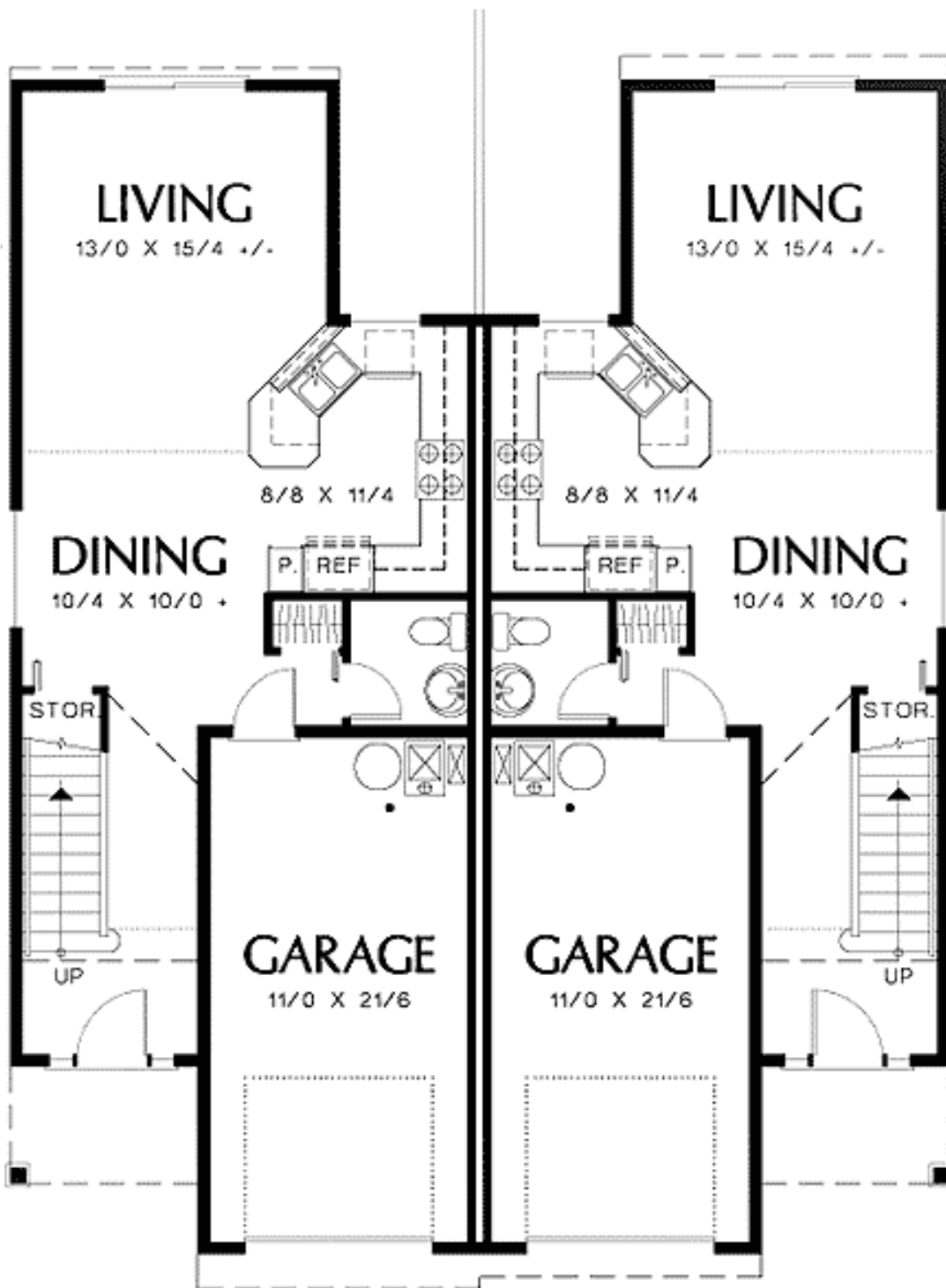

2nd Level

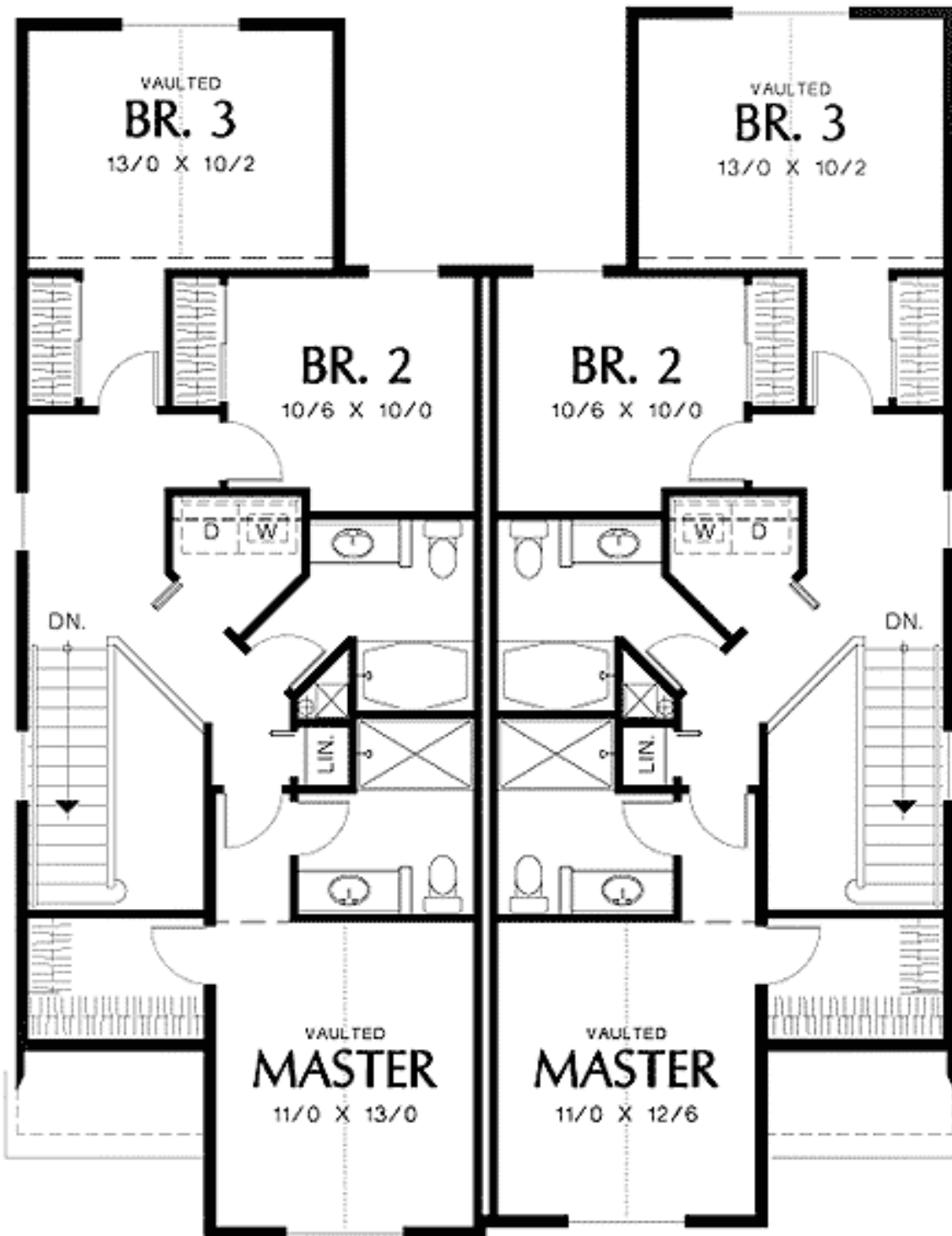

Rear View

