

Architectural Designs ...selling quality house plans for over 30 years.

Plan W40825DB



House plans are Copyright © 2009 by our architects and designers.

- NOTE: This house plan is designed for Structural Insulated Panel (SIP) construction. See plan 41013DB for the 2x4 version of this home plan.

Style: Traditional

Total Living Area: 1514

Main Flr.: 1047

2nd Flr.: 467

Bonus: 461 sq. ft.

Front Porch: 181 sq. ft.

Rear Porch: 90 sq. ft.

Total Square Feet: 2,788 sq. ft.

Attached Garage: 2 Car, 542 sq. ft.

Bedrooms: 3

Full Bathrooms: 2

Half Bathrooms: 1

Width: 45'

Depth: 55'

Maximum Ridge Height: 28'

Exterior Walls: SIP

Ceiling Height:

Main Floor: 9'

Standard Foundations: Basement

Alternate Foundations: Slab (\$150), Crawl (\$150)

Special Features: PDF, Narrow Lot, Bonus Room, 1st Floor Master Suite

One Set	Five Sets	Eight Sets	Reproducible	PDF File	CAD
\$585	\$735	\$795	\$735	\$735	\$1,035

Main Level

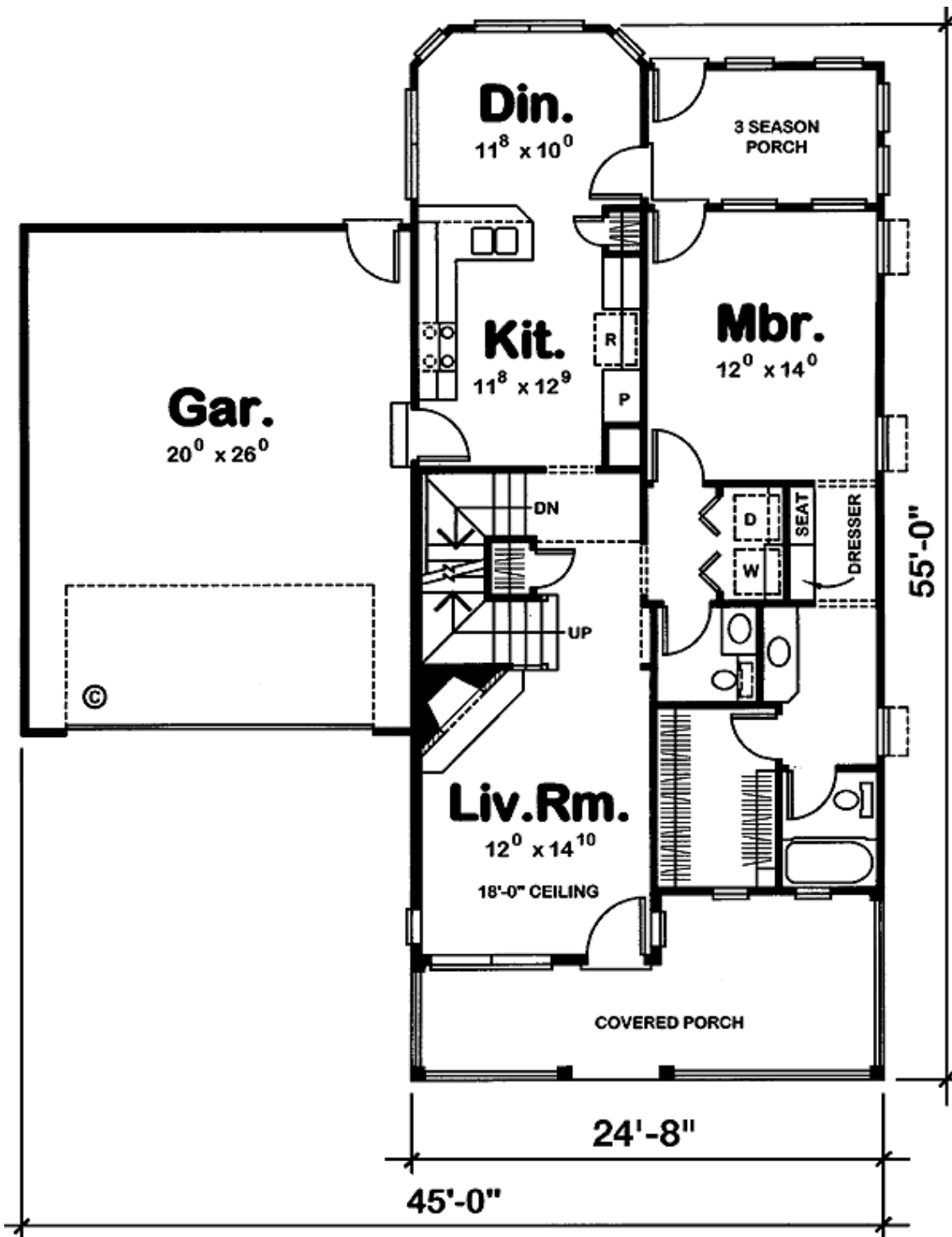

2nd Level

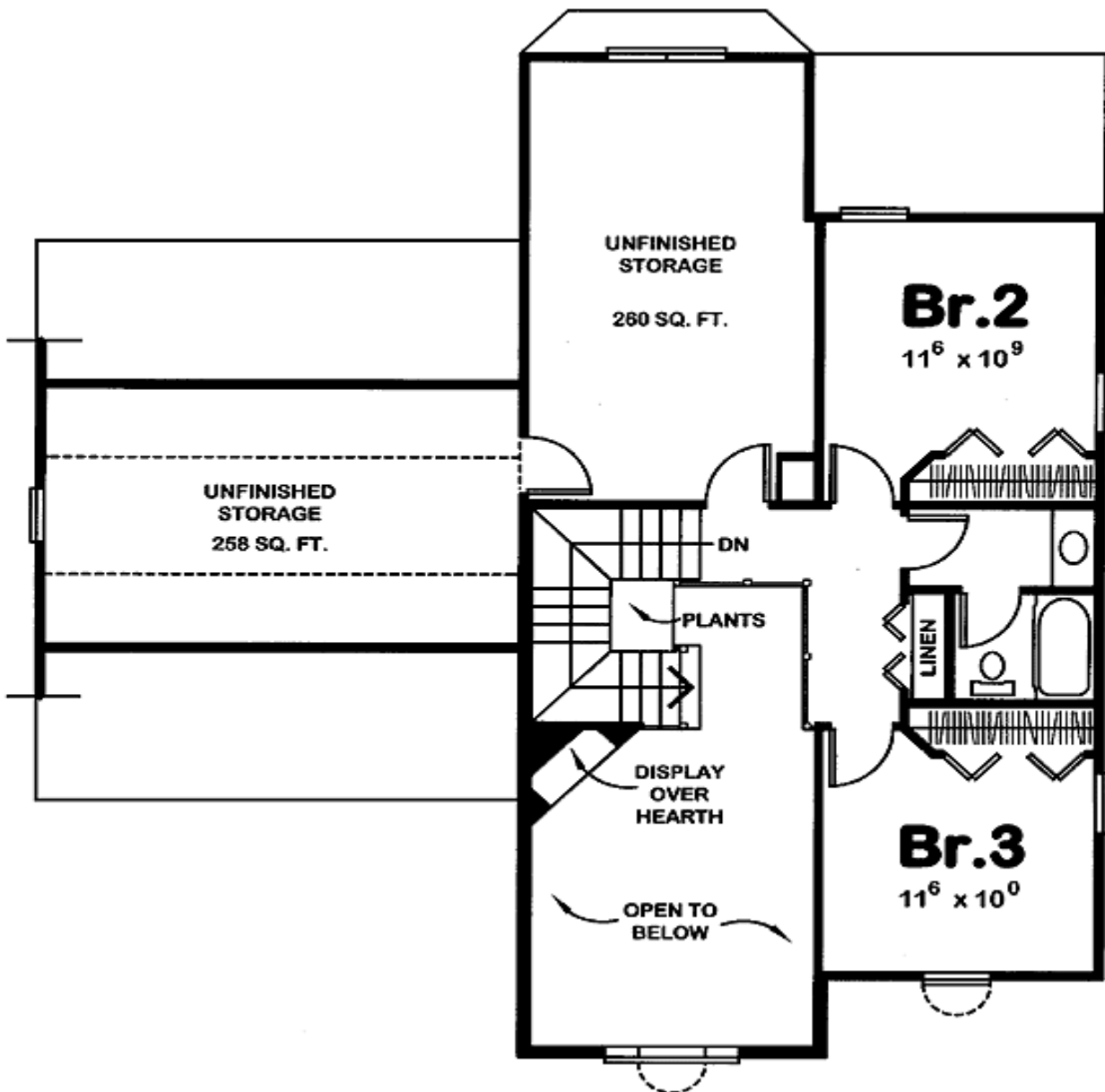

Rear View

