

Architectural Designs ...selling quality house plans for over 30 years.

Plan W6938AM: Estate-Sized Home



House plans are Copyright © 2009 by our architects and designers.

- Bordering on estate-sized, this plan borrows elements from Norman, Mediterranean and English architecture with a stone chimney on one side of the recessed entrance, and a huge arched window on the other.
- The vaulted great room joins the nook and island kitchen to form an open gathering space. Across the foyer are a more formal dining room and study with built-ins.
- Bedrooms are all to the back of the plan: two family bedrooms and a vaulted master suite with patio access. Each bedroom has its own bath.
- Notable amenities include fireplaces in the great room and master bedroom, a walk-in pantry, loads of built-ins and store space, and a bonus room with full bath over the garage.
- Ceilings: 10' standard in the non-vaulted areas.
- Foundation: crawl space.

Style: Northwest, Traditional

Total Living Area: 2973

Main Flr.: 2973

Bonus: 417 sq. ft.

Total Square Feet: 4,091 sq. ft.

Attached Garage: 3 Car, 701 sq. ft.

Bedrooms: 4, 3

Full Bathrooms: 4

Half Bathrooms: 1

Width: 108'

Depth: 59'

Maximum Ridge Height: 25'

Exterior Walls: 2x6

Ceiling Height:

Main Floor: 10'

Other: Vaulted Great Room & Master

Standard Foundations: Basement, Crawl

Alternate Foundations: Slab (\$125)

Special Features: 1st Floor Master Suite, Photo Gallery, PDF, CAD Available, Bonus Room, Butler Walk-in Pantry, Corner Lot, Den-Office-Library-Study

One Set	Five Sets	Eight Sets	Reproducible	PDF File	CAD
\$625	\$675	\$775	\$1,050	\$1,050	\$1,700

Main Level

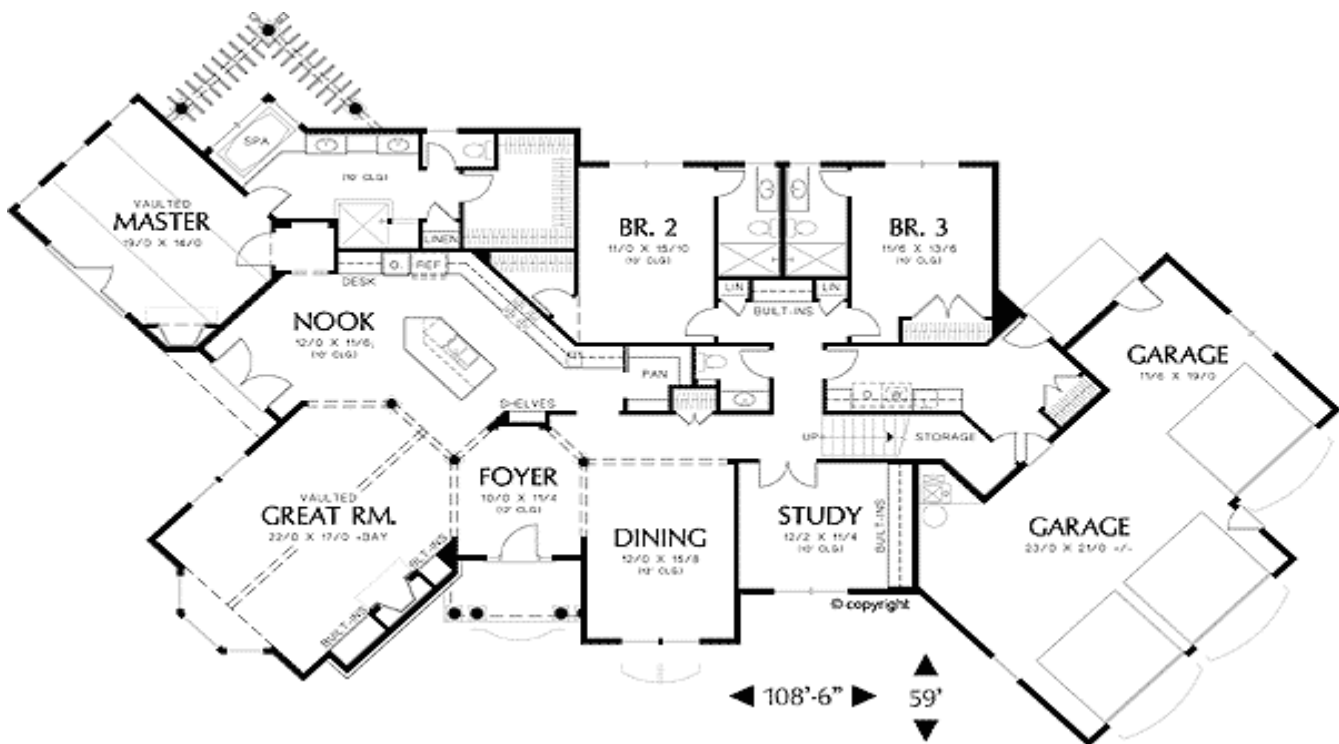

Bonus

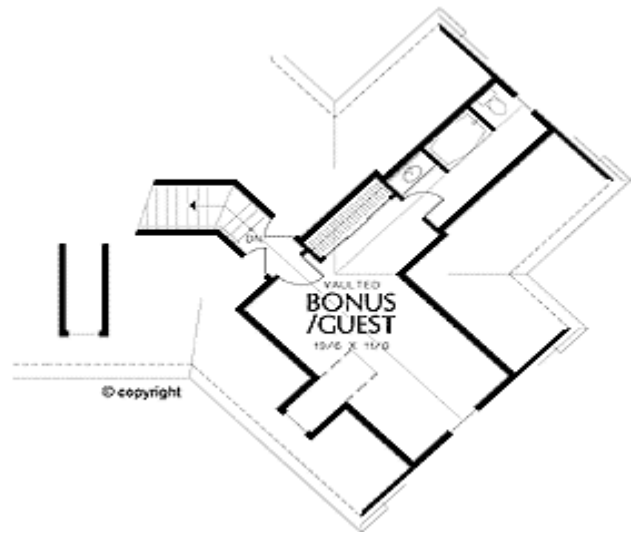

Architectural Designs ...selling quality house plans for over 30 years.

Photo



Architectural Designs ...selling quality house plans for over 30 years.

Left Side



Right Side



Rear View

