

Architectural Designs ...selling quality house plans for over 30 years.

Plan W3814JA: Farmhouse-Style Ranch



House plans are Copyright © 2009 by our architects and designers.

- A wrap-around porch and steep roofline punctuated by small dormers enhance the exterior of this farmhouse-style ranch home. Palladian head windows and doors on the exterior face the porches of the home.
- Inside, ceilings in every room but the kitchen and bathrooms receive special treatment.
- In the great room, which has an 11-foot stepped ceiling, the fireplace is flanked by two sets of transomed doors that lead to the large rear covered porch. The eat-in kitchen, in an exciting angled shape, abounds in cabinets and work space. A bayed breakfast area extends out onto the front porch.
- The master suite includes a tray ceiling, a bay-windowed sitting area, two walk-in closets and a bath. The compartmented master bath includes twin sinks, separate shower and whirlpool tub set into a semi-circular glass-block bay. Two secondary bedrooms share another full bath.
- A high roofline provides for the inclusion of a huge bonus expansion area to be finished at a later date.
- Foundation options: basement, crawl space or slab.

Style: Country, Farmhouse, Ranch

Total Living Area: 1793

Main Flr.: 1793

Basement Unfinished: 1,793 sq. ft.

Bonus: 779 sq. ft.

Front Porch: 318 sq. ft.

Rear Porch: 260 sq. ft.

Total Square Feet: 5,414 sq. ft.

Attached Garage: 2 Car, 471 sq. ft.

Bedrooms: 3

Full Bathrooms: 2

Width: 69'10"

Depth: 51'8"

Maximum Ridge Height: 24'8"

Exterior Walls: 2x4

Ceiling Height:

Other: 11' Step Great Room & Dining Room; 11' Tray MBR; Vaulted BR#2"

Standard Foundations: Slab, Basement, Crawl

Special Features: 1st Floor Master Suite, Photo Gallery, Bonus Room, PDF, MBR Sitting Area, CAD Available

Five Sets	Eight Sets	Reproducible	PDF File	CAD
\$595	\$635	\$750	\$750	\$1,250

Main Level

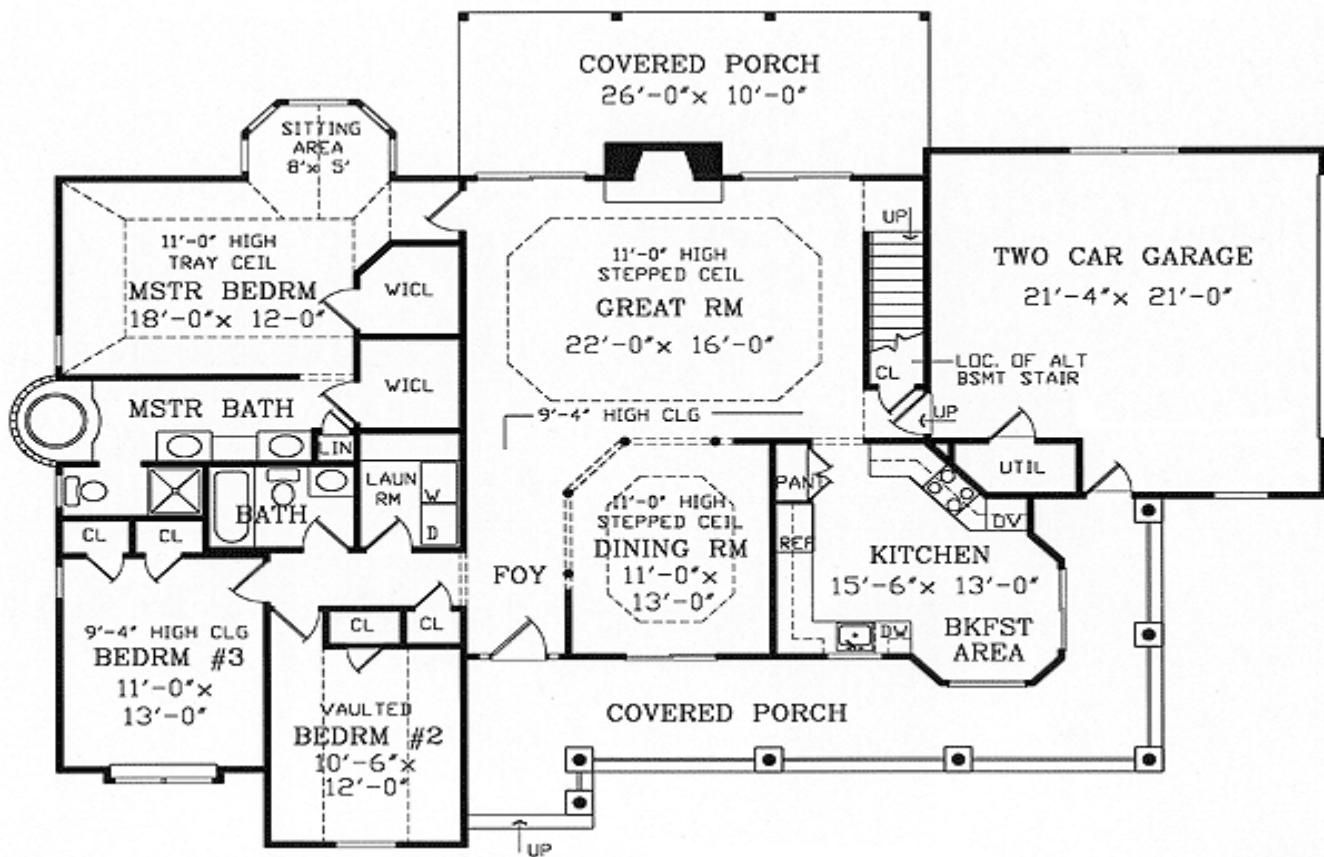

Bonus

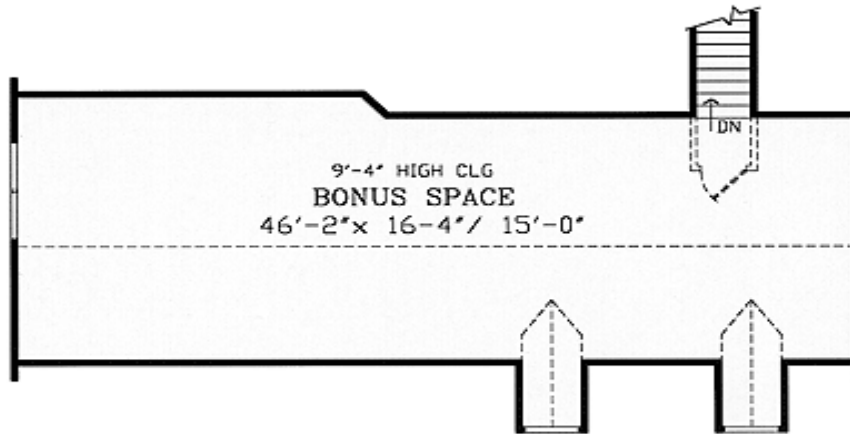

Architectural Designs ...selling quality house plans for over 30 years.

Photo



Elevation #2



Left Side



Rear View



Interior

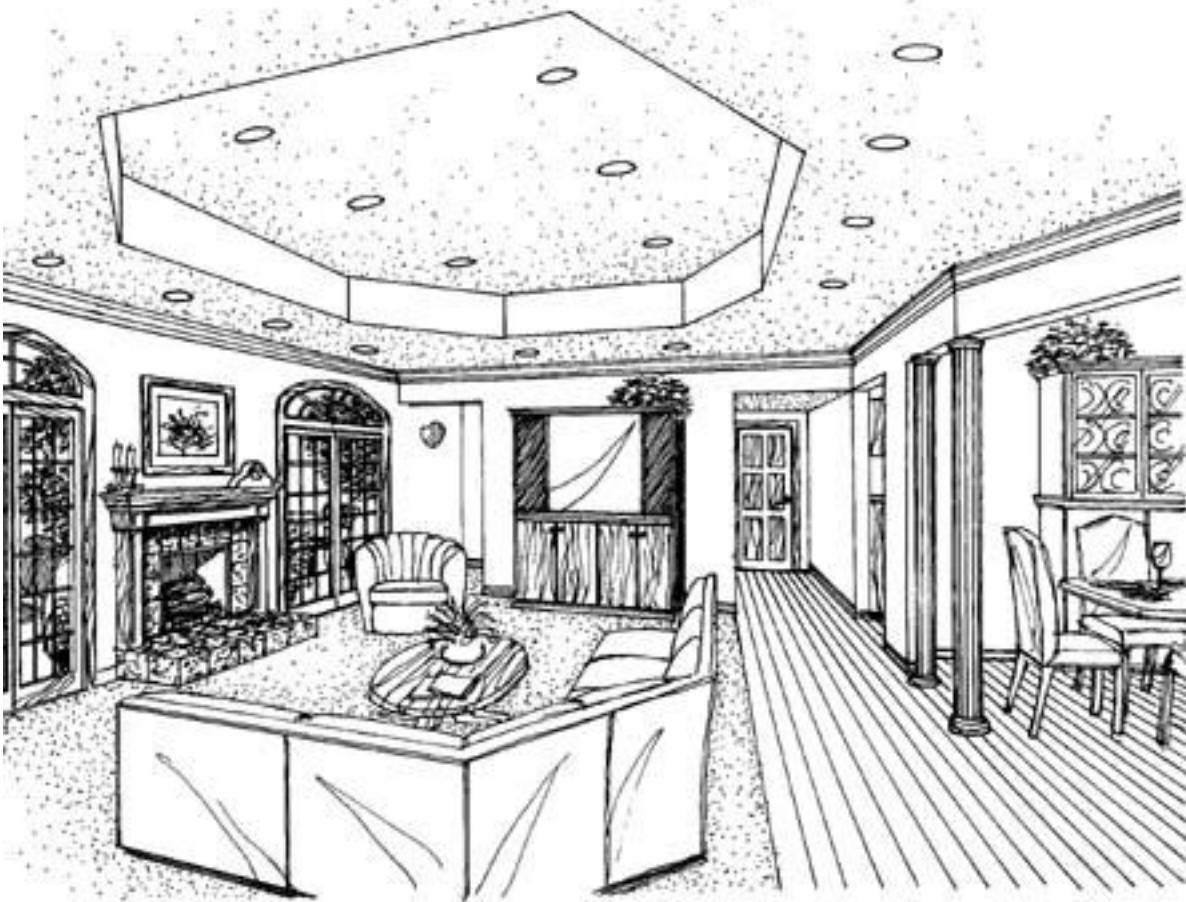

Great Room



Master BR



Master Bath

