

# Architectural Designs ...selling quality house plans for over 30 years.

Plan W9551DM: Two-Story Colonial with Open Floor Plan



House plans are Copyright © 2009 by our architects and designers.

- This two-story colonial home plan features an open floor plan for convenience and a modern flow. This home offers generous formal and informal living in a surprisingly compact footprint.
- The high center hall entry introduces you to the flanking living room and a first floor study that is perfect for a home office. The living room and dining room connect to accommodate a grand formal occasion.
- The kitchen and breakfast nook opens to an expandable family room. The master suite is on the second floor and features a large master bath with dual sinks and a separate shower and tub.

Style: Colonial, Traditional

Total Living Area: 2866

Main Flr.: 1680

2nd Flr.: 1186

Basement Unfinished: 1,680 sq. ft.

Deck: 220 sq. ft.

Entry: 32 sq. ft.

Total Square Feet: 5,295 sq. ft.

Attached Garage: 2 Car, 497 sq. ft.

Bedrooms: 4

Full Bathrooms: 2

Half Bathrooms: 1

Width: 62'6"

Depth: 48'

Maximum Ridge Height: 31'

Exterior Walls: 2x6

Ceiling Height:

Main Floor: 8'1"

2nd Floor: 8'1"

Standard Foundations: Slab, Basement, Crawl

Alternate Foundations: Basement (\$100)

One Set  
\$699

Five Sets  
\$779

Eight Sets  
\$839

Reproducible  
\$888

Main Level

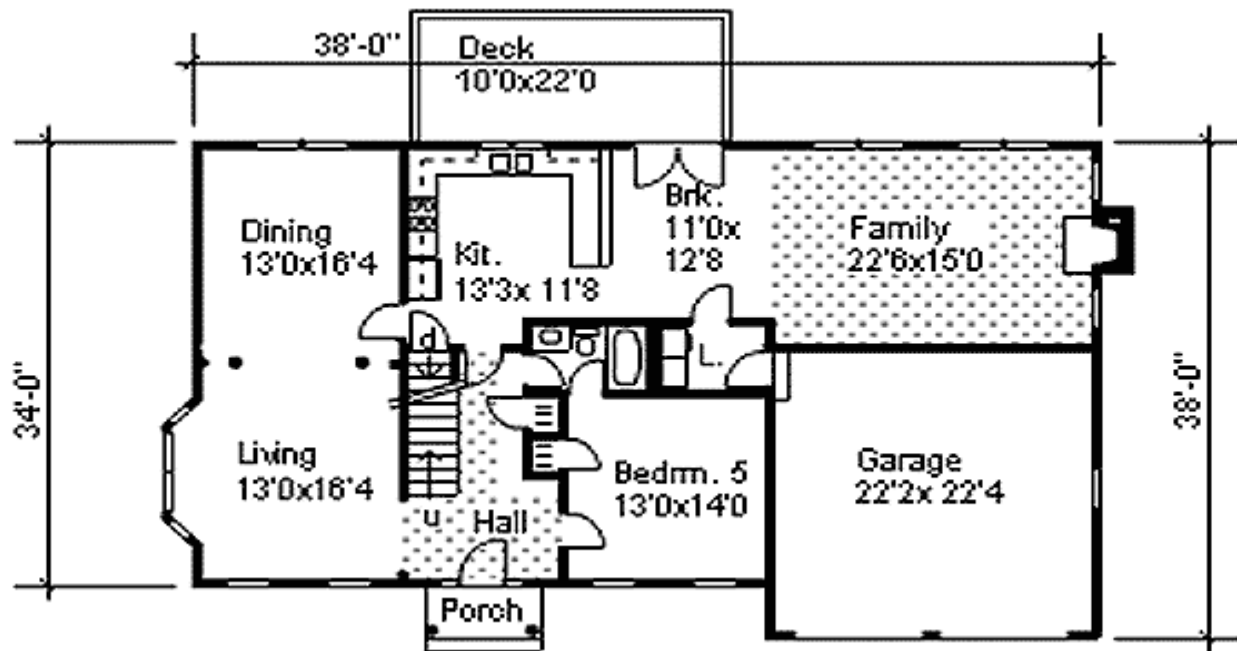

2nd Level

