

Architectural Designs ...selling quality house plans for over 30 years.

Plan W88025SH: A Wrapping Veranda Graces This Home



House plans are Copyright © 2009 by our architects and designers.

- A wide, wrapping veranda graces the front of this design and is accessed from the living room and the dining room, as well as double doors at the entry. Both the living and dining rooms have tray ceilings.
- The family room is vaulted and has a cozy fireplace as its focal point. To either side of the fireplace are double doors to the rear yard.
- The kitchen has a center cooking island, spacious counters and a pass-through to the dining room. The breakfast room serves for casual occasions.
- The main-floor master suite features a lavish master bath with a roomy walk-in closet, whirlpool spa and twin vanity.
- A den or media center is found on the second floor with three family bedrooms and two full baths.
- Ceilings: 8'.
- Foundation: basement or crawl space. Please specify your preference when ordering.

Style: Canadian, Country, Farmhouse, Southern

Total Living Area: 3141

Main Flr.: 2042

2nd Flr.: 1099

Total Square Feet: 3,141 sq. ft.

Bedrooms: 4

Full Bathrooms: 3

Half Bathrooms: 1

Width: 66'

Depth: 44'6"

Maximum Ridge Height: 27'

Exterior Walls: 2x6

Ceiling Height:

Main Floor: 8'
Standard Foundations: Basement, Crawl
Special Features: PDF, Wrap Around Porch

| | | | | | |
|---------|-----------|------------|--------------|----------|---------|
| One Set | Five Sets | Eight Sets | Reproducible | PDF File | CAD |
| \$650 | \$700 | \$740 | \$850 | \$850 | \$1,150 |

Main Level

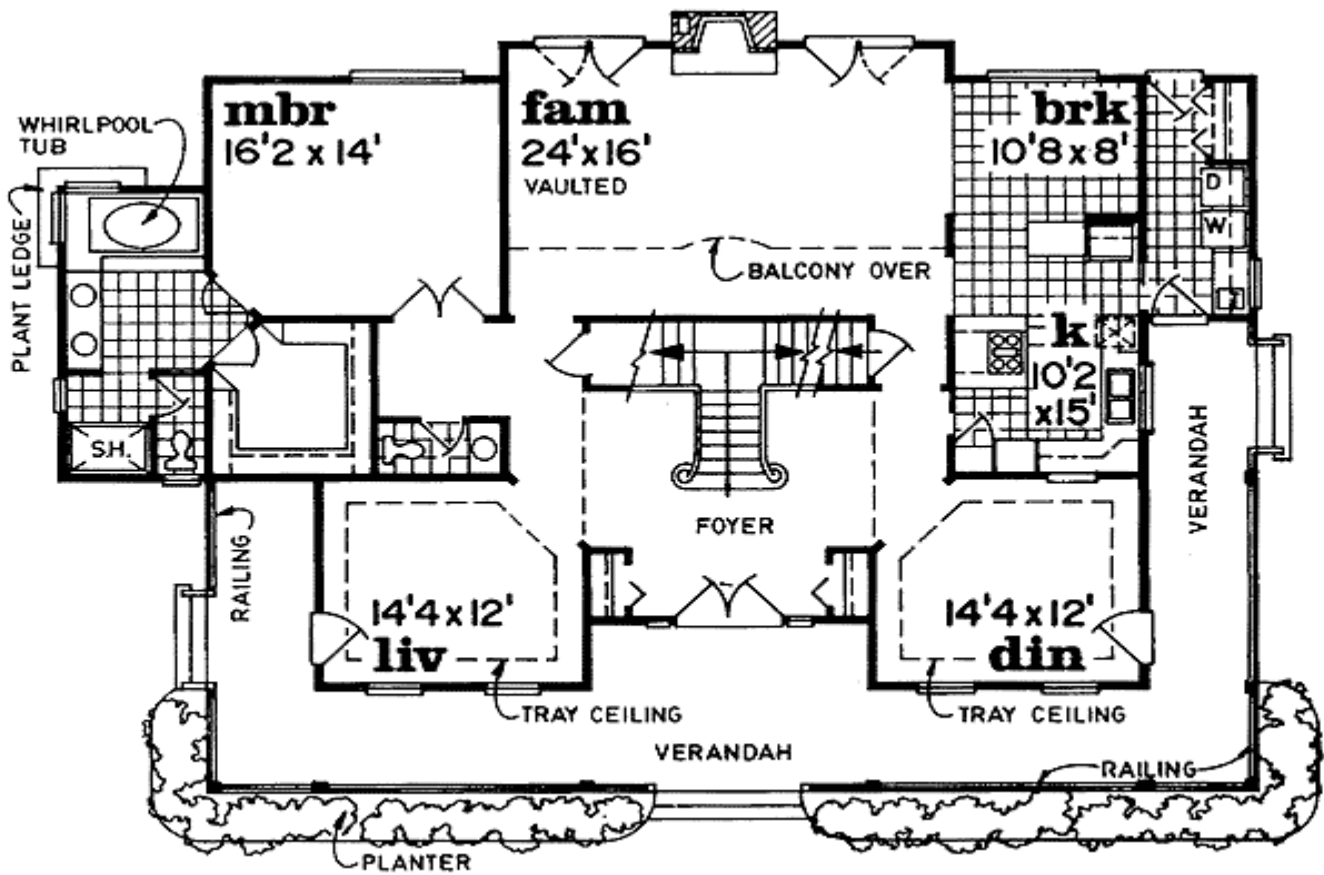

2nd Level

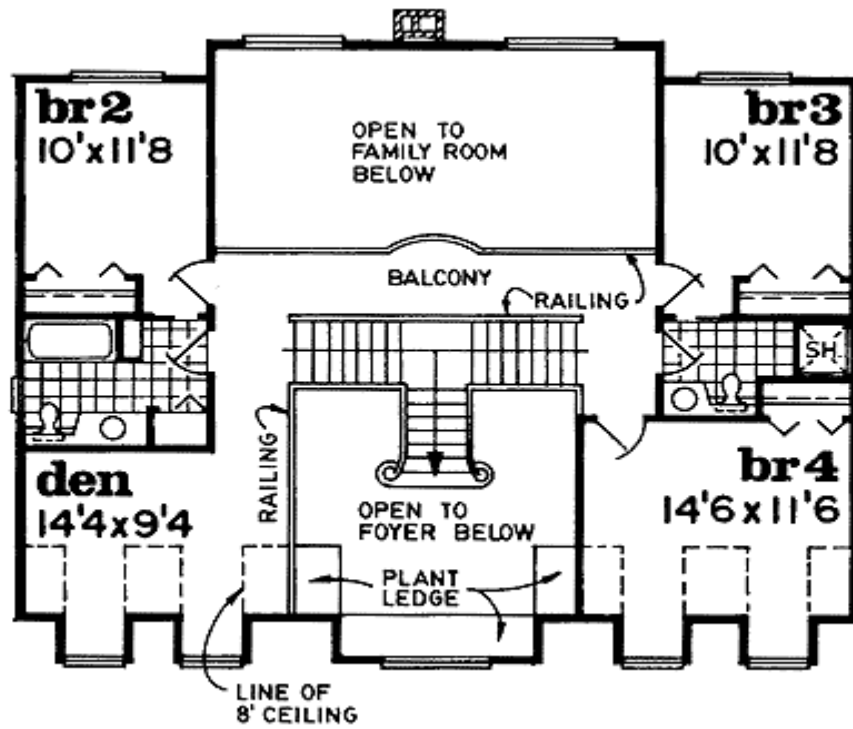

Rear View

