

# Architectural Designs ...selling quality house plans for over 30 years.

Plan W11295G



House plans are Copyright © 2009 by our architects and designers.

Style: European

Total Living Area: 2893

Main Flr.: 1523

2nd Flr.: 1370

Basement Unfinished: 1,722 sq. ft.

Bonus: 344 sq. ft.

Deck: 346 sq. ft.

Total Square Feet: 5,789 sq. ft.

Attached Garage: 2 Car, 484 sq. ft.

Bedrooms: 4

Full Bathrooms: 3

Half Bathrooms: 1

Width: 62'

Depth: 64'

Maximum Ridge Height: 36'

Exterior Walls: 2x4

Ceiling Height:

Main Floor: 9'

2nd Floor: 8'

Other: Tray MBR; Vaulted Master Bath

Standard Foundations: Basement

Alternate Foundations: Slab (\$150), Crawl (\$150)

Special Features: Jack & Jill Bath, Butler Walk-in Pantry, Bonus Room, PDF

One Set	Five Sets	Eight Sets	Reproducible	PDF File	CAD
\$645	\$725	\$755	\$895	\$895	\$1,495

## Main Level

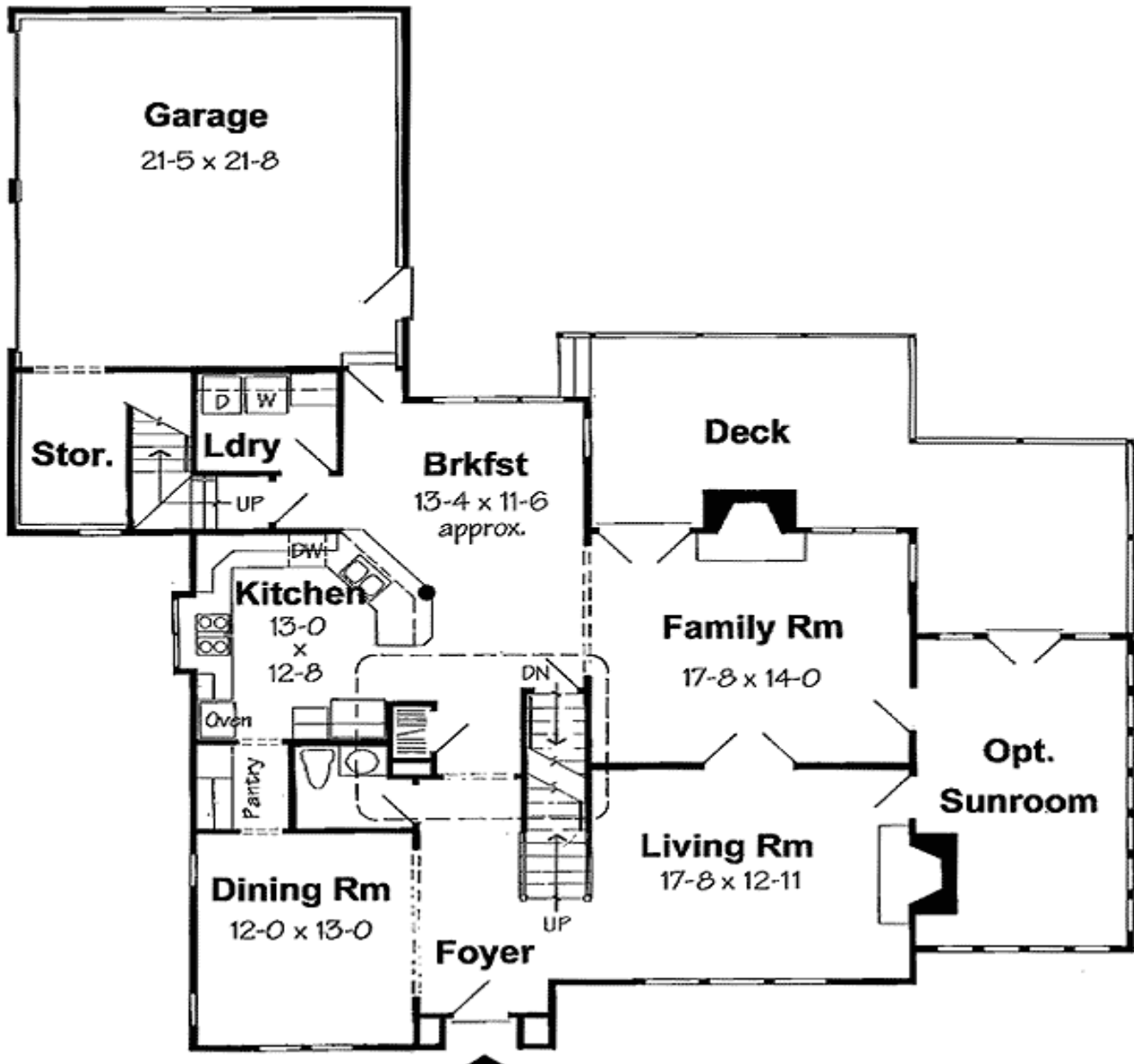

## 2nd Level

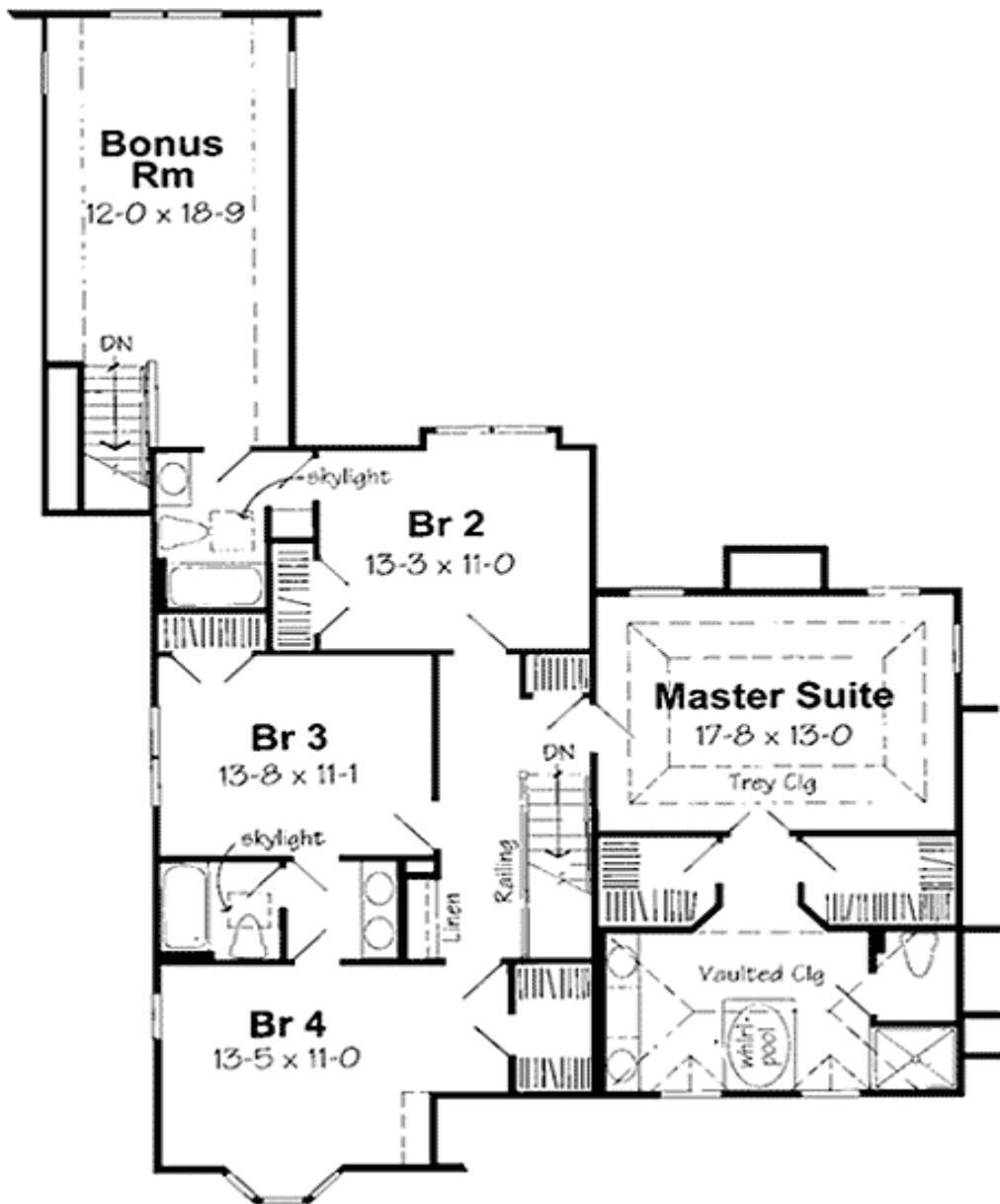

Optional

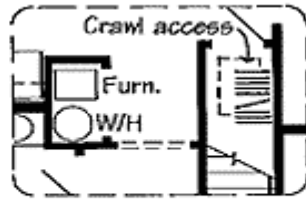

## **Alternate Foundation Option**