

Architectural Designs ...selling quality house plans for over 30 years.

Plan W72506DA: Handsome Craftsman



House plans are Copyright © 2009 by our architects and designers.

- Handsome craftsman style home with large covered front porch.
- Amenities include garage storage, mud room, and guest suite with bath.
- Vaulted great room with corner fireplace and patio access.

Style: Craftsman

Total Living Area: 2675

Main Flr.: 2067

2nd Flr.: 608

Bonus: 486 sq. ft.

Total Square Feet: 4,008 sq. ft.

Attached Garage: 3 Car, 847 sq. ft.

Bedrooms: 4

Full Bathrooms: 3

Half Bathrooms: 1

Width: 83'

Depth: 60'

Maximum Ridge Height: 27'9"

Exterior Walls: 2x6

Ceiling Height:

 Main Floor: 9'

Standard Foundations: Crawl

Special Features: CAD Available, Bonus Room, PDF, 1st Floor Master Suite

One Set	Five Sets	Eight Sets	Reproducible	PDF File	CAD
\$545	\$675	\$835	\$1,015	\$1,015	\$1,275

Main Level

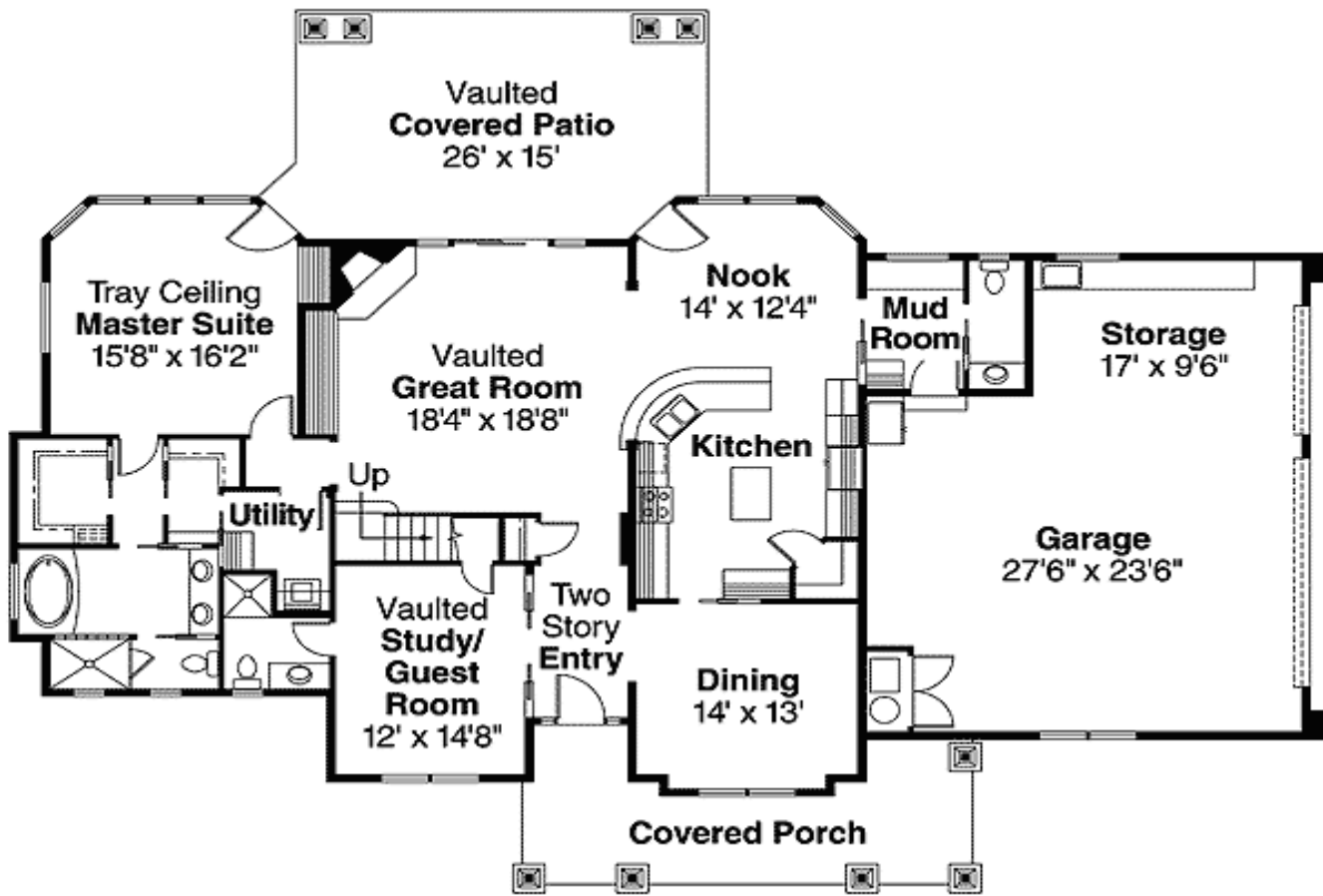

2nd Level

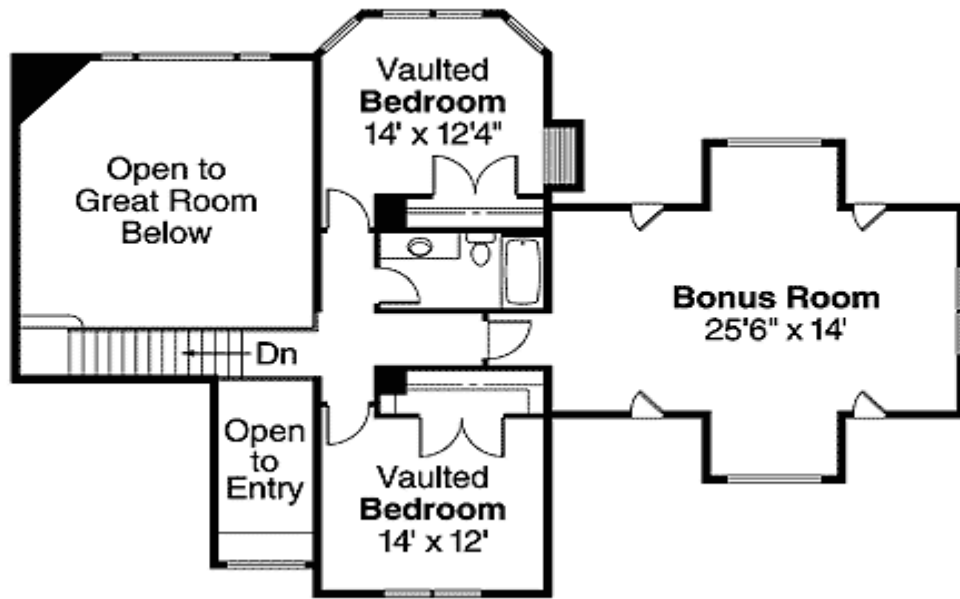

Architectural Designs ...selling quality house plans for over 30 years.

Sides/Rear

