

# Architectural Designs ...selling quality house plans for over 30 years.

Plan W2257SL: Country Vacation Classic



House plans are Copyright © 2009 by our architects and designers.

- Dormers and a large wrap-around porch extend a country feel to all who enter this 2-story country vacation home plan.
- A screened porch provides a peaceful space for relaxation.
- The efficient kitchen enjoys a pass-through window.
- The 2-story great room provides an open, airy feel. An upstairs loft provides an excellent playroom for children or an ideal home office.
- Bedrooms #2 and #3 share a full bath and overlook the great room with this house plan.

Style: Carriage, Country, Vacation

Total Living Area: 1879

Main Flr.: 1314

2nd Flr.: 565

Total Square Feet: 1,879 sq. ft.

Bedrooms: 3

Full Bathrooms: 2

Width: 50'

Depth: 42'

Maximum Ridge Height: 28'

Exterior Walls: 2x4

Optional Exterior Walls: 2x6 \$75

Ceiling Height:

Main Floor: 8'

2nd Floor: 8'

Standard Foundations: Crawl

Alternate Foundations: Slab (\$275), Basement (\$275)

Special Features: Narrow Lot, PDF, CAD Available, Wrap Around Porch

One Set	Five Sets	Eight Sets	Reproducible	PDF File	CAD
\$330	\$415	\$475	\$580	\$580	\$1,080

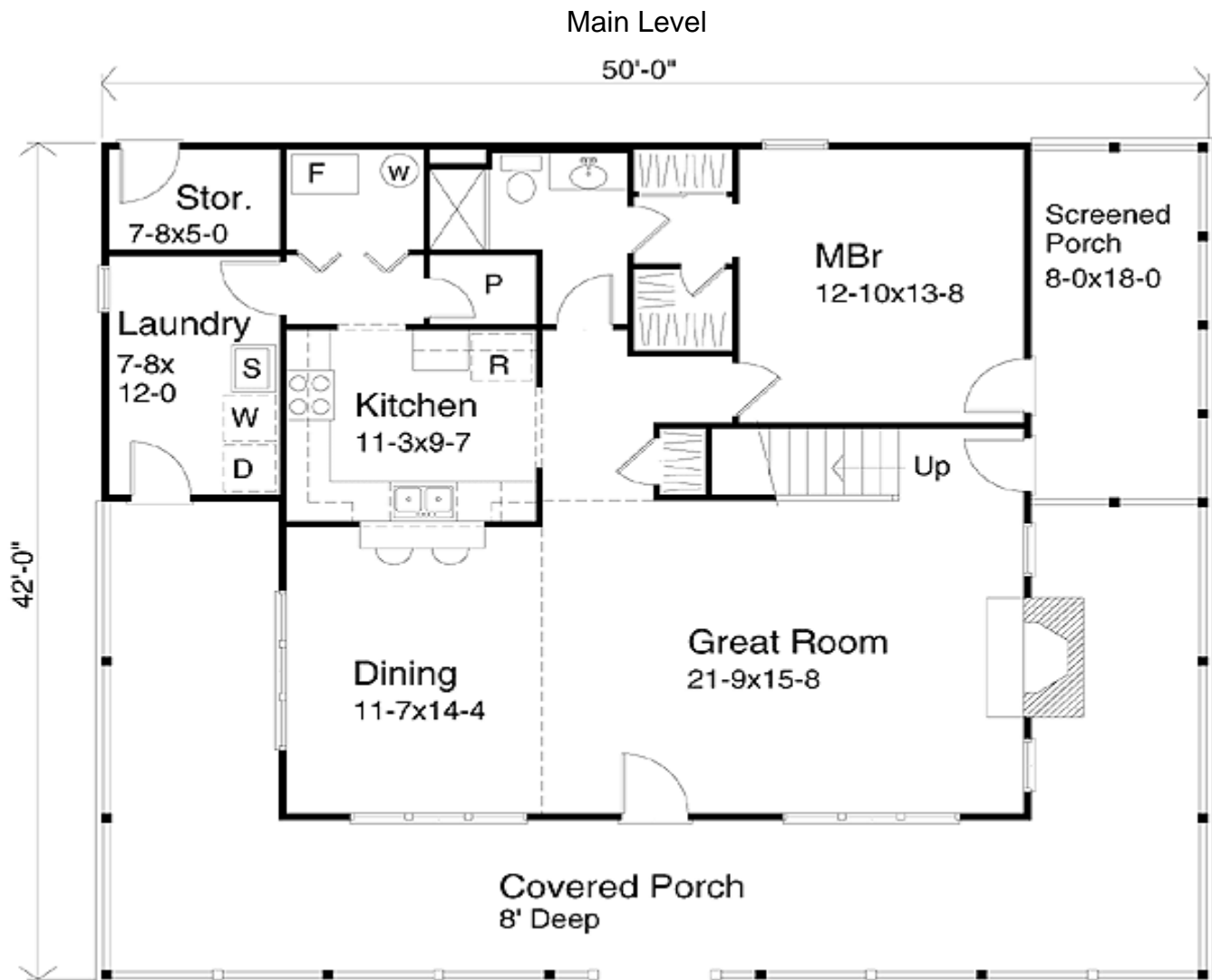

2nd Level

