

Architectural Designs ...selling quality house plans for over 30 years.

Plan W40838DB



House plans are Copyright © 2009 by our architects and designers.

Style: Traditional

Total Living Area: 1818

Main Flr.: 1302

2nd Flr.: 516

Bonus: 233 sq. ft.

Front Porch: 104 sq. ft.

Total Square Feet: 2,630 sq. ft.

Attached Garage: 2 Car, 475 sq. ft.

Bedrooms: 3

Full Bathrooms: 2

Half Bathrooms: 1

Width: 50'

Depth: 48'

Maximum Ridge Height: 28'

Exterior Walls: SIP

Ceiling Height:

Main Floor: 9'

2nd Floor: 8'

Other: 12' Cathedral Great Room; Sloped MBR & BR#2 & ##

Standard Foundations: Basement

Alternate Foundations: Slab (\$150), Walkout (no charge), Crawl (\$150)

Special Features: CAD Available, 1st Floor Master Suite, Narrow Lot, Bonus Room, Photo Gallery, PDF

One Set	Five Sets	Eight Sets	Reproducible	PDF File	CAD
\$615	\$765	\$825	\$765	\$765	\$1,065

Main Level

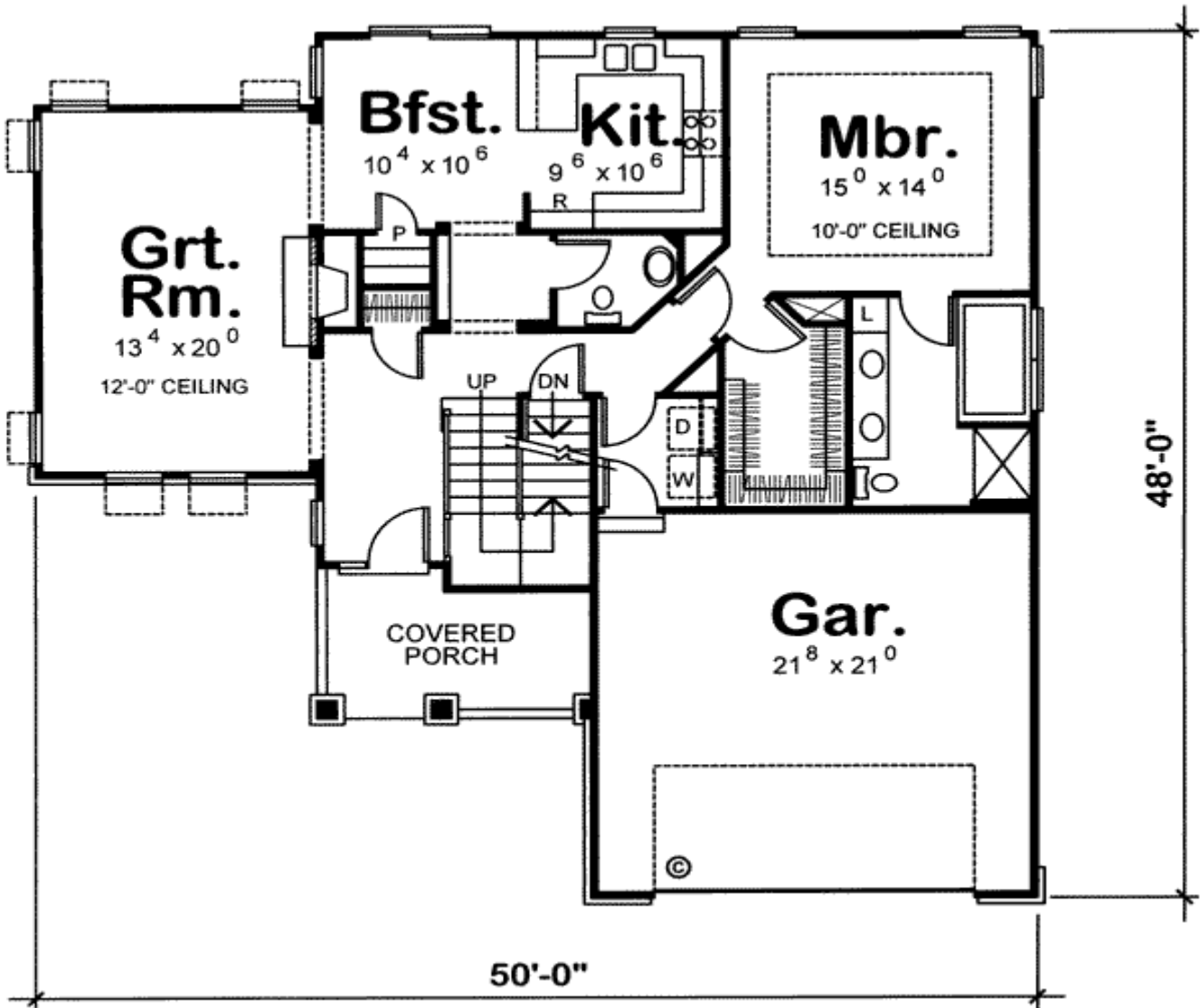

2nd Level

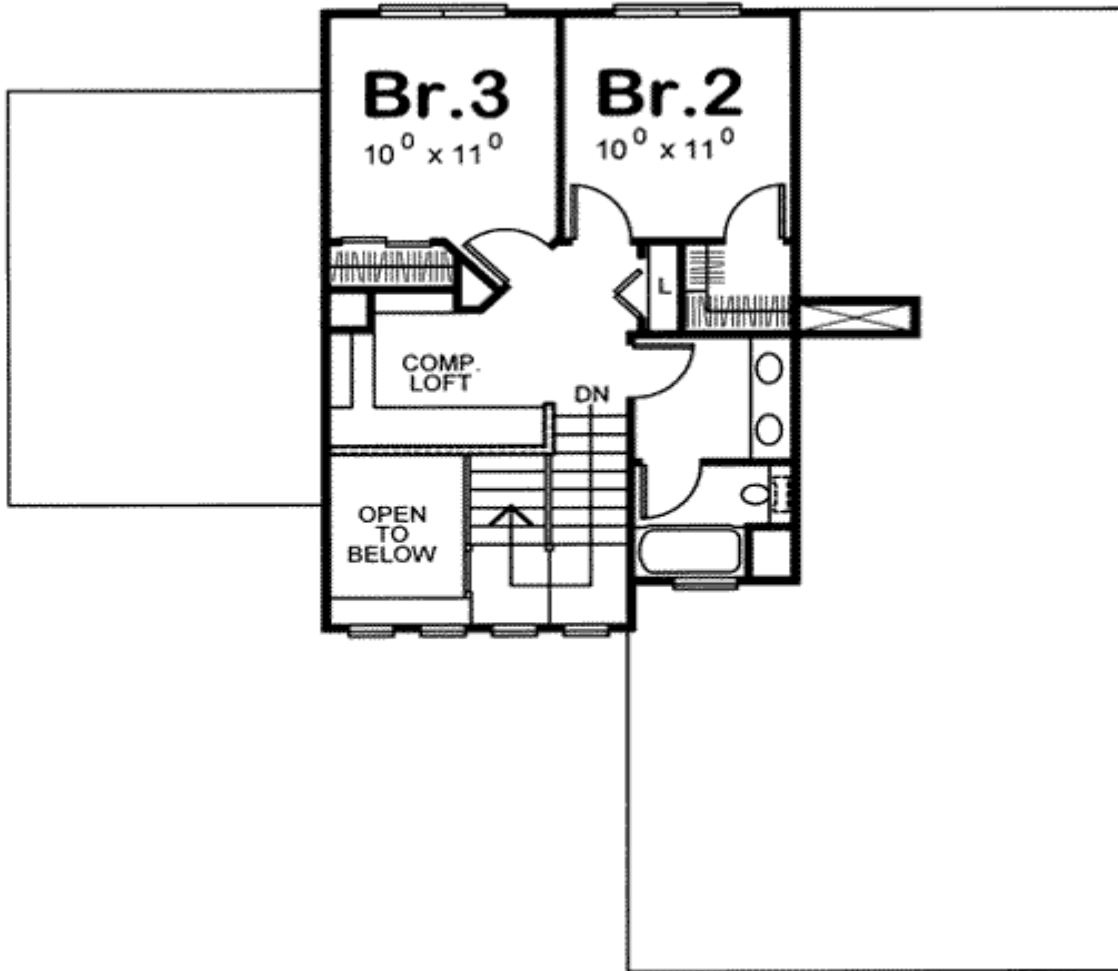

Bonus

Bonus room

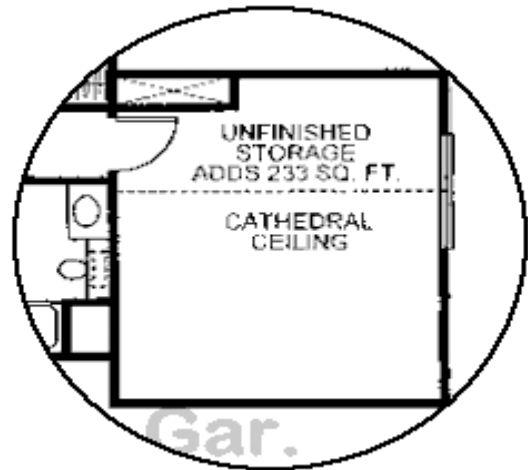

Architectural Designs ...selling quality house plans for over 30 years.

Photo



Rear View

