

Architectural Designs ...selling quality house plans for over 30 years.

Plan W72320DA: Log Cabin with Two Wings



House plans are Copyright © 2009 by our architects and designers.

- This home plan is an A-frame log cabin, expanded by two wings and a lofty V-shaped window bay. Living space is a little more than 1,200 square feet.
- Whole logs give this vacation cabin a rustic look, while the metal roof and abundance of sparkling glass add contemporary flavor
- Windows stacked four-high in the living room provide natural illumination on all but the darkest of winter days. The front section of this bright space is open to the second floor ceiling.
- A small two-section bathroom is accessible from both the master suite and the living room. Another bathroom is upstairs near the bunk room, loft and storage areas. If desired, the large storage area on the right could be outfitted as another bunk room.
- Outside, the railed deck echoes the V shape of this house plan's window bay.
- Need more space? See house plan, see 72321DA.

Style: Log, Vacation

Total Living Area: 1216

Main Flr.: 864

2nd Flr.: 352

Total Square Feet: 1,216 sq. ft.

Bedrooms: 2

Full Bathrooms: 2

Width: 40'

Depth: 27'

Maximum Ridge Height: 27'8

Exterior Walls: 2x6 or Log

Ceiling Height:

Main Floor: 8'
Standard Foundations: Crawl
Special Features: Narrow Lot, 1st Floor Master Suite, CAD Available, PDF

One Set	Five Sets	Eight Sets	Reproducible	PDF File	CAD
\$445	\$575	\$675	\$800	\$800	\$1,015

Main Level

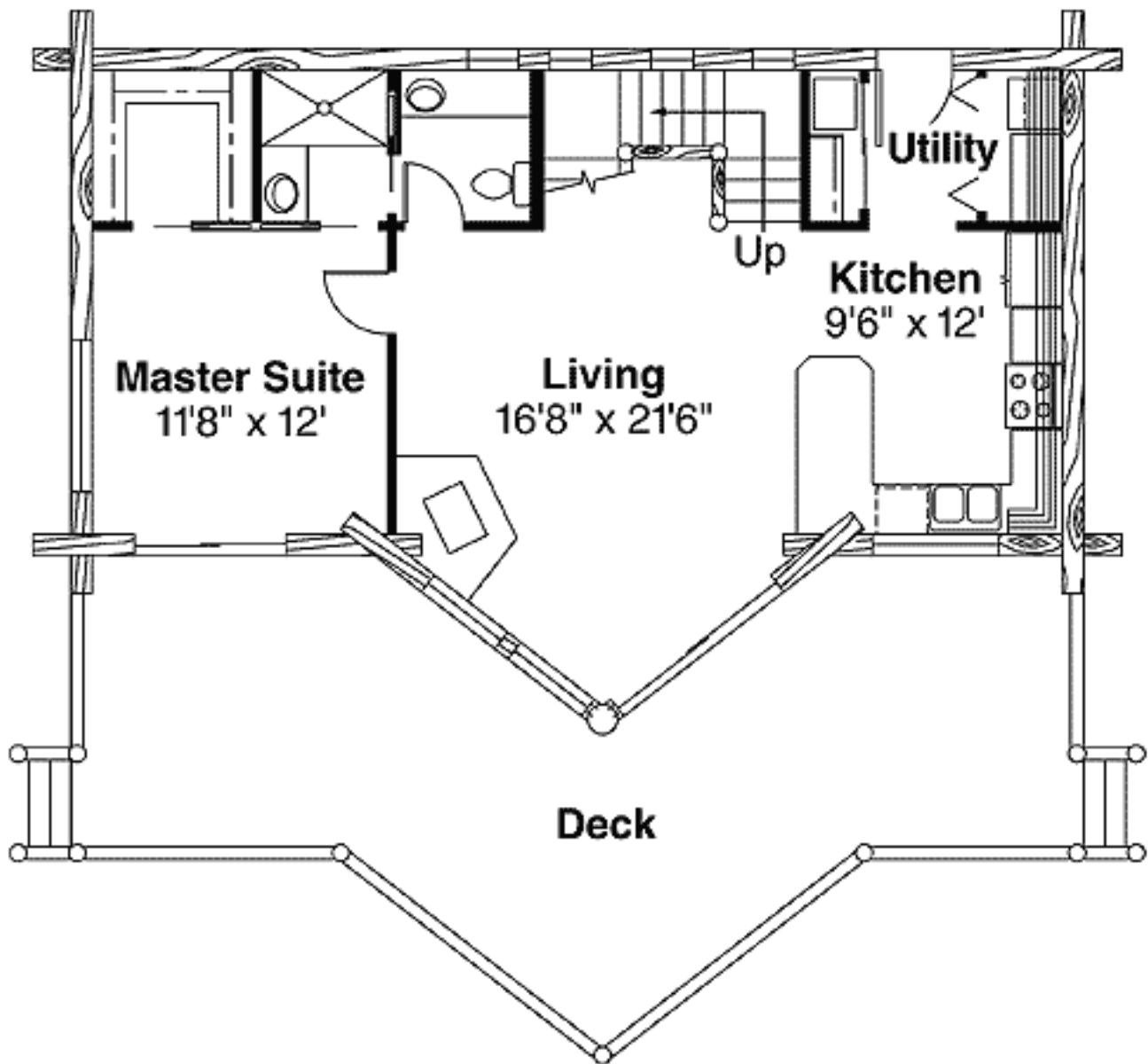

2nd Level

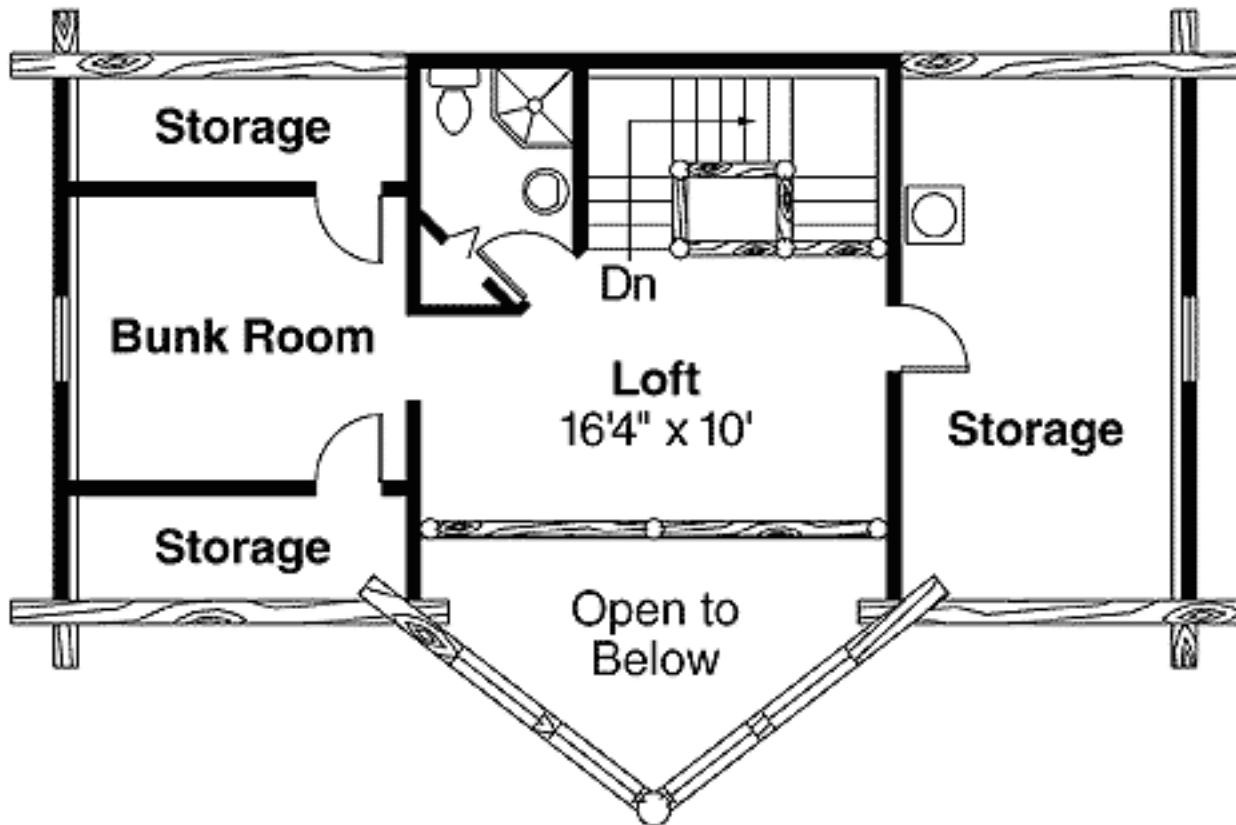

Rear View

