

Architectural Designs ...selling quality house plans for over 30 years.

Plan W59041ND: Log Home Elegance



House plans are Copyright © 2009 by our architects and designers.

- The full window view adds elegance to this log home plan with covered porches in the front and back.
- The living room with fireplace has a soaring vaulted ceiling. To the right is the dining room that opens to the kitchen with eat-at bar and access to the laundry room and breezeway to garage.
- The rear foyer, accessed from a covered porch, has ample closet space.
- The master suite includes a walk-in closet, private bath and access to the covered porch.
- The upper floor contains a loft and full bath between two bedrooms with ample closet space and access to the attic. There is also an optional bonus room above the garage.
- Ceilings: 8' standard.
- Foundation: Basement, crawl space, daylight basement. Please specify your preference when ordering.

Style: Log, Mountain

Total Living Area: 2521

Main Flr.: 1645

2nd Flr.: 876

Bonus: 462 sq. ft.

Porch, Combined: 356 sq. ft.

Total Square Feet: 4,189 sq. ft.

Attached Garage: 3 Car, 850 sq. ft.

Bedrooms: 3

Full Bathrooms: 2

Width: 106'4"

Depth: 57'8"

Maximum Ridge Height: 21'8"

Exterior Walls: Log

Ceiling Height:

Main Floor: 8'

Standard Foundations: Crawl

Alternate Foundations: Walkout (\$250), Basement (\$250)

Special Features: PDF, Bonus Room, 1st Floor Master Suite

One Set	Five Sets	Eight Sets	Reproducible	PDF File	CAD
\$605	\$710	\$750	\$970	\$970	\$1,650

Main Level

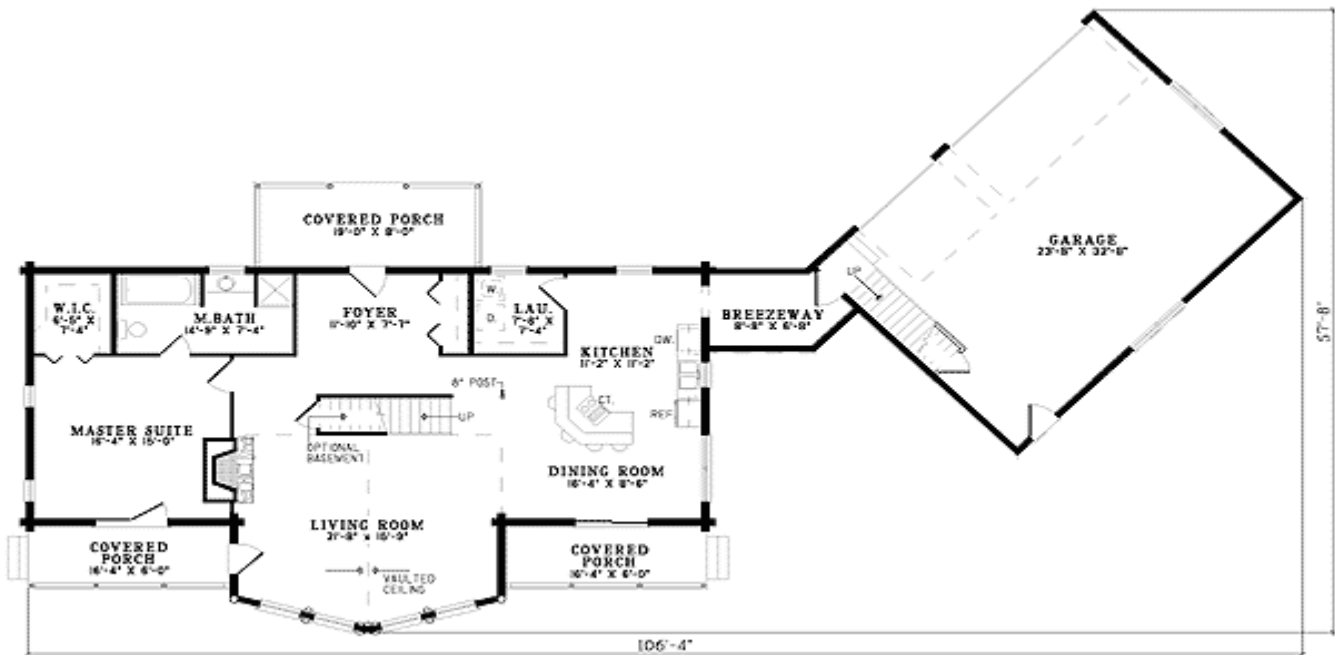

2nd Level

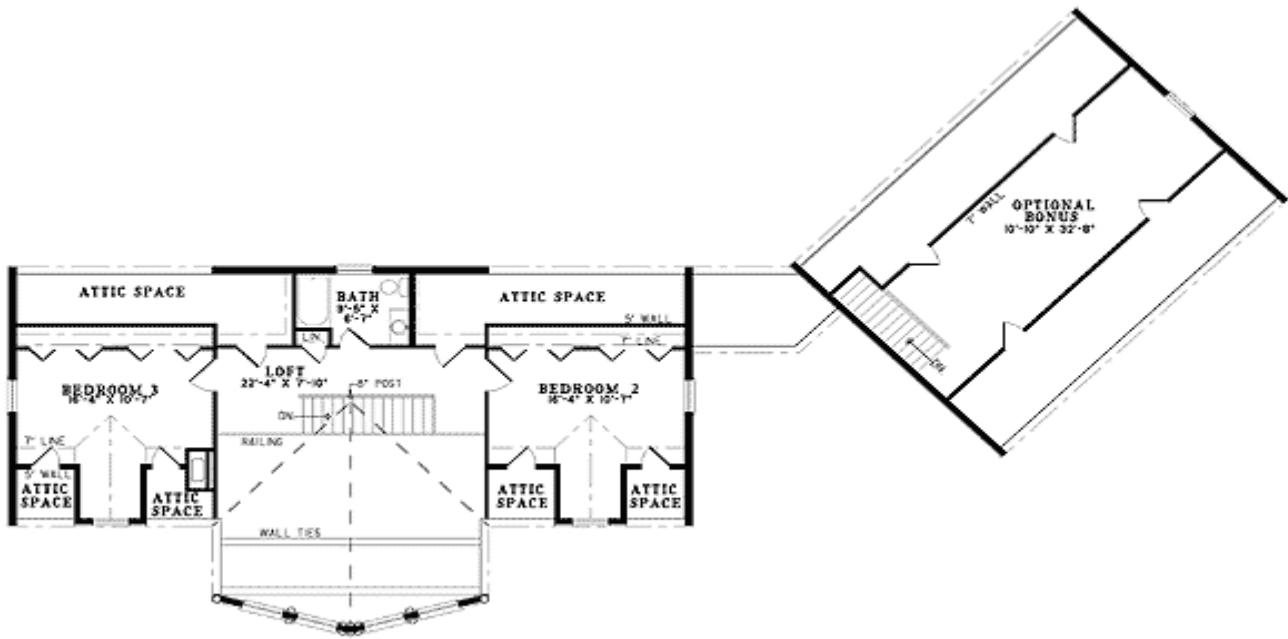

Sides/Rear



Front elevation



Left elevation



Right elevation