

Architectural Designs ...selling quality house plans for over 30 years.

Plan W66244WE: Intricate Ceiling Details



House plans are Copyright © 2009 by our architects and designers.

- Upon entering this luxury home plan, you will be captivated by the intricate ceilings and attention to detail. A wall of glass at a 90-degree angle is the first thing you see, flanked by an inviting wet bar that leads to the open family, kitchen and dinette areas.
- The master suite is conveniently located on the other side of the house featuring a walk in shower with full garden views.
- Upstairs are two guest suites each with their own baths and even a wet bar.
- One more flight up and you will find the theater room that could easily be converted into a pool/game room.

Style: Florida, Luxury, Mediterranean

Total Living Area: 5438

Main Flr.: 3919

2nd Flr.: 891

Balcony/Veranda: 237 sq. ft.

Lanai: 1,320 sq. ft.

Entry: 145 sq. ft.

Theater Room:

Total Square Feet: 8,413 sq. ft.

Attached Garage: 4 Car, 1,273 sq. ft.

Bedrooms: 4

Full Bathrooms: 5+

Half Bathrooms: 1

Width: 94'8"

Depth: 130'4"

Maximum Ridge Height: 31'7"

Exterior Walls: 2x6 & Block

Optional Exterior Walls: 2x6 \$544

Ceiling Height:

Main Floor: 12'

2nd Floor: 9'

Other: 25'8" Entry; 13' Coffered Family Room; 17' Coffered Foyer; 13'4" Double Coffered Dining Room; 10' Double Coffered Theater; 14' Double Coffered Study & MBR; 10' BR#2 & 4

Standard Foundations: Slab

Special Features: Den-Office-Library-Study, 1st Floor Master Suite, Loft, PDF, Media-Game-Home Theater, CAD Available

Five Sets	Eight Sets	Reproducible	PDF File	CAD
\$2,800	\$2,850	\$3,000	\$3,000	\$3,000

Architectural Designs ...selling quality house plans for over 30 years.

Main Level

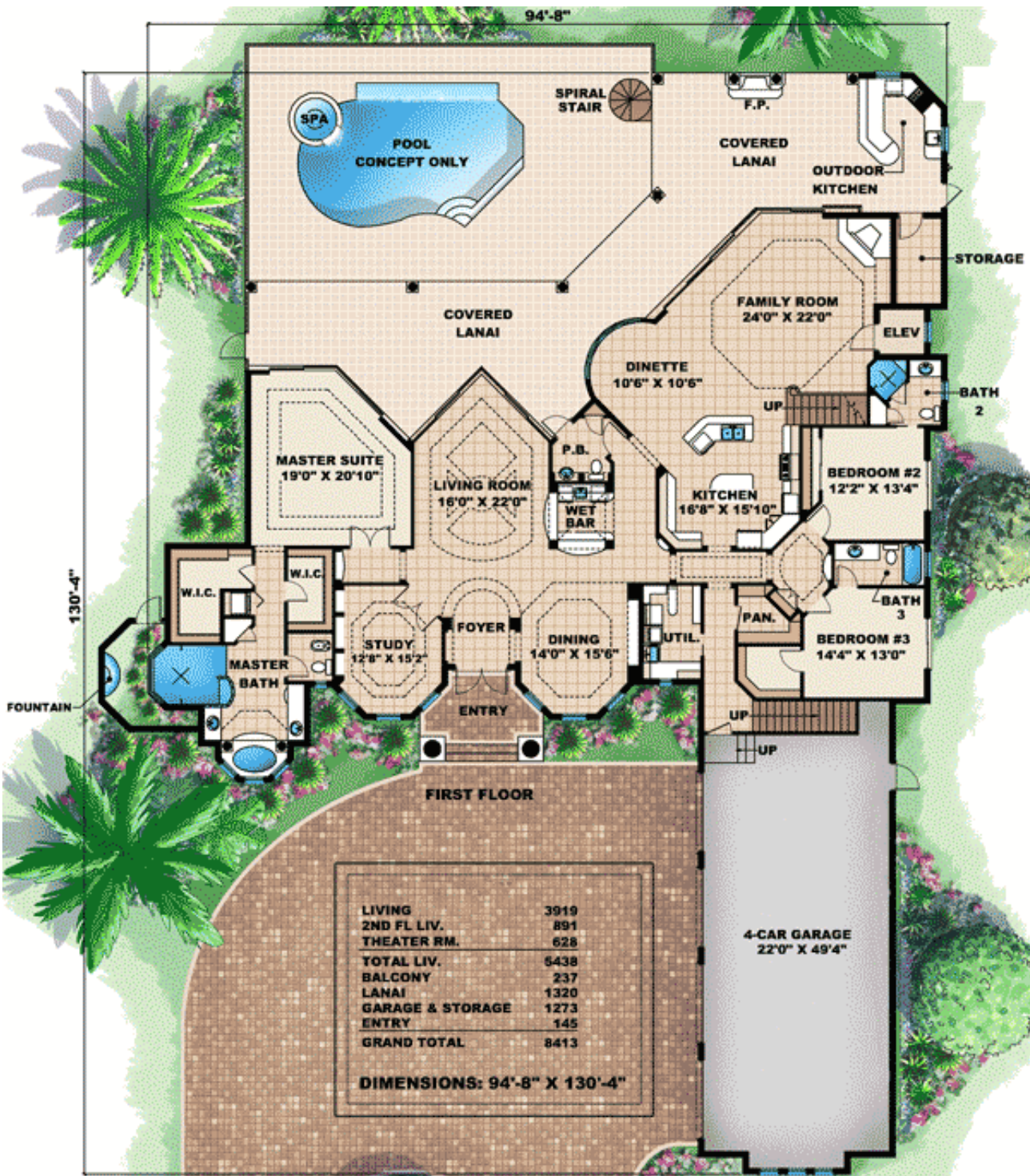

2nd Level



Third Floor

