

Architectural Designs ...selling quality house plans for over 30 years.

Plan W48125FM: Petite European Home Plan



House plans are Copyright © 2009 by our architects and designers.

- Perfect for a retired couple or family just starting out, this petite European home plan is charmingly designed for a narrow lot.
- The entry leads you into a large, open great room with warming fireplace flanked by built-ins.
- An arched opening leads to the combined kitchen and dining area. Sliding doors lead to your intimate covered patio.
- The master suite is generously-sized and enjoys a sitting area with windows on two walls and private bath with large walk-in closet.
- Two additional bedrooms share a bath.

Style: European

Total Living Area: 1442

Main Flr.: 1442

Total Square Feet: 1,822 sq. ft.

Attached Garage: 2 Car, 380 sq. ft.

Bedrooms: 3

Full Bathrooms: 2

Width: 40'

Depth: 53'3"

Maximum Ridge Height: 22'

Exterior Walls: 2x4

Ceiling Height:

Main Floor: 8'

Other: 8'-9' Vaulted MBR

Standard Foundations: Slab

Alternate Foundations: Basement (\$400), Crawl (\$400)

Special Features: Narrow Lot, Corner Lot, MBR Sitting Area, 1st Floor Master Suite

One Set
\$650

Five Sets
\$700

Eight Sets
\$790

Reproducible
\$900

Architectural Designs ...selling quality house plans for over 30 years.

Main Level

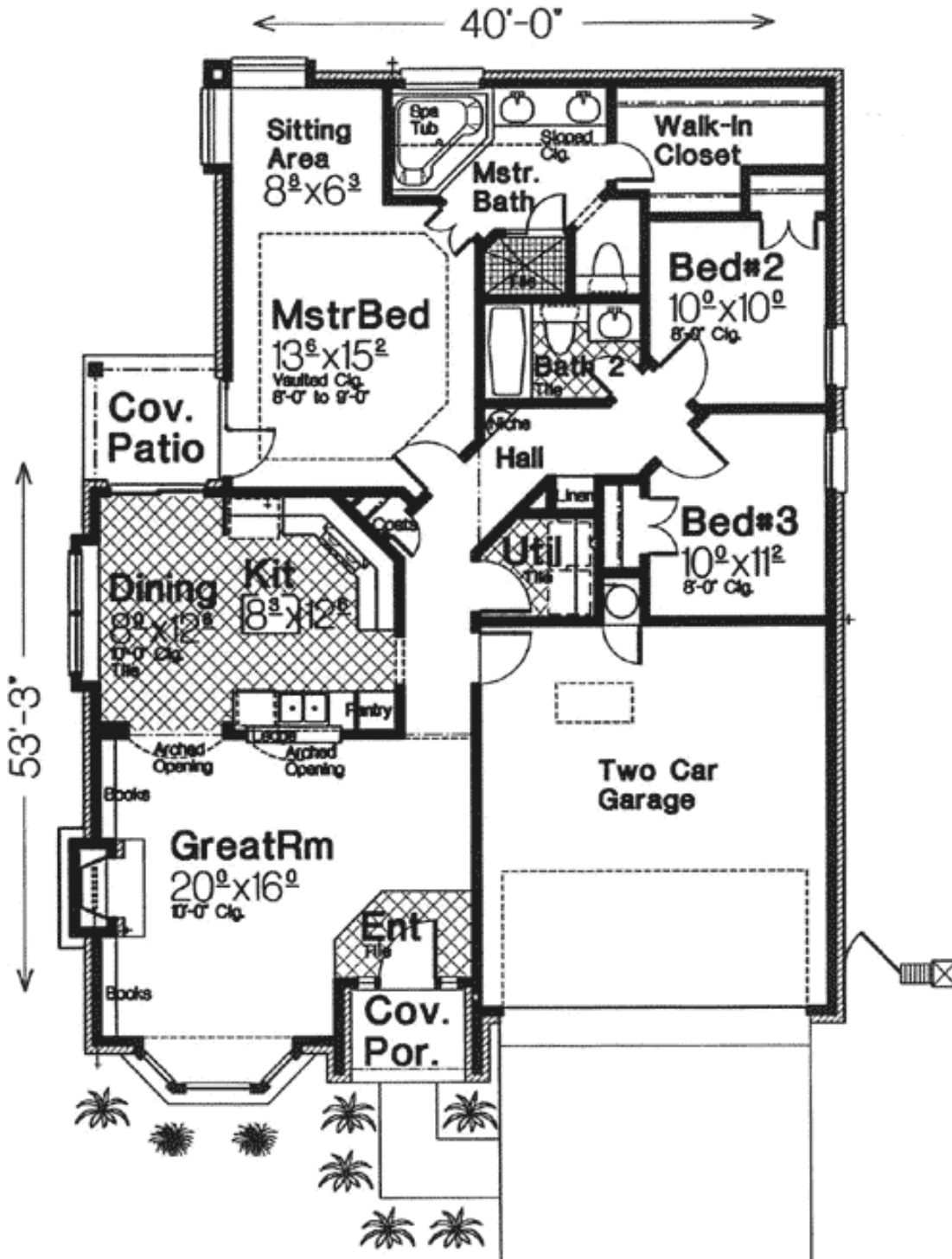

Rear View

