

Plan W9815SW: Getaway Awash with Windows



House plans are Copyright © 2009 by our architects and designers.

- Shingle siding highlighted with fishscale accents and traditional double-hung windows borrow from pleasing Craftsman styling while the heavy timber porch and deck framing topped with a clean lined glass railing bring a modern touch to the exterior of this unique home plan.
- The main level easily transforms itself into a mother-in-law or private guest suite complete with a separate access.
- Covered front porches, screened rear porch or the open sundeck on both levels ensures outdoor activities endure regardless of the prevailing weather.
- The second level is totally dedicated to fulfilling the needs of the vaulted Master Suite part of which is a multi-purpose reading, hobby or exercise room and a massive sundeck.
- Access to a floating library overlooking the living/dining room is via a connecting bridge. Glass railings, exposed truss timber framing and floor beams make this a totally special and reflective space.

Style: Canadian, Cottage, Northwest, Vacation

Total Living Area: 1923

Main Flr.: 1169

2nd Flr.: 754

Porch, Combined: 268 sq. ft.

Deck: 754 sq. ft.

Screen Porch:

Total Square Feet: 3,041 sq. ft.

Bedrooms: 3, 2

Full Bathrooms: 2

Width: 49'6"

Depth: 43'6"

Maximum Ridge Height: 31'6"

Exterior Walls: 2x6

Ceiling Height:

Main Floor: 8'

Other: 23' Vaulted Living & Dining Room; 17' 2-Story Foyer; 13' Vaulted Library; 10' MBR

Standard Foundations: Crawl

Special Features: Narrow Lot, Loft, PDF, Den-Office-Library-Study

One Set	Five Sets	Eight Sets	Reproducible	PDF File	CAD
\$450	\$505	\$550	\$670	\$670	\$870

## Main Level

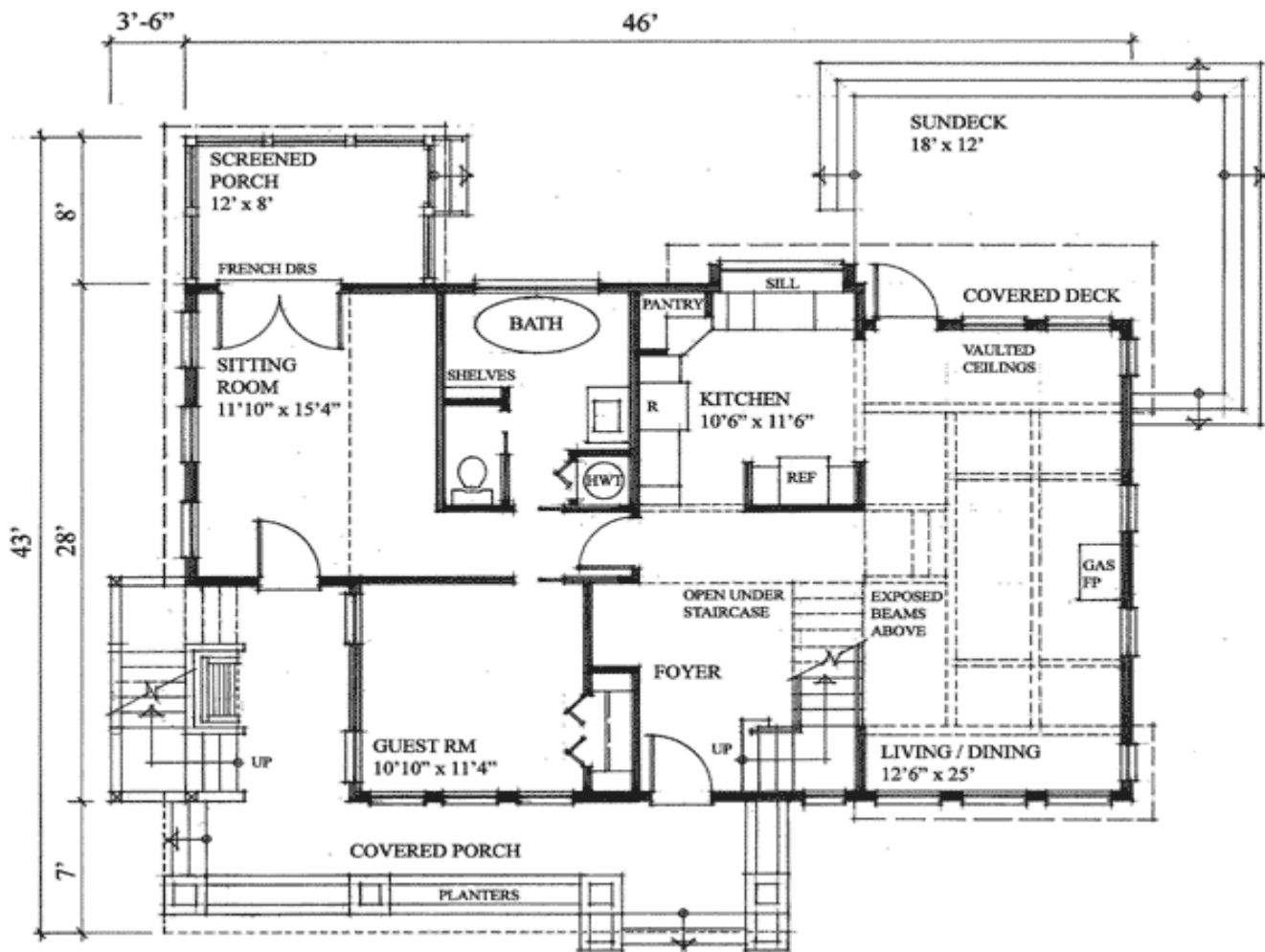

## 2nd Level

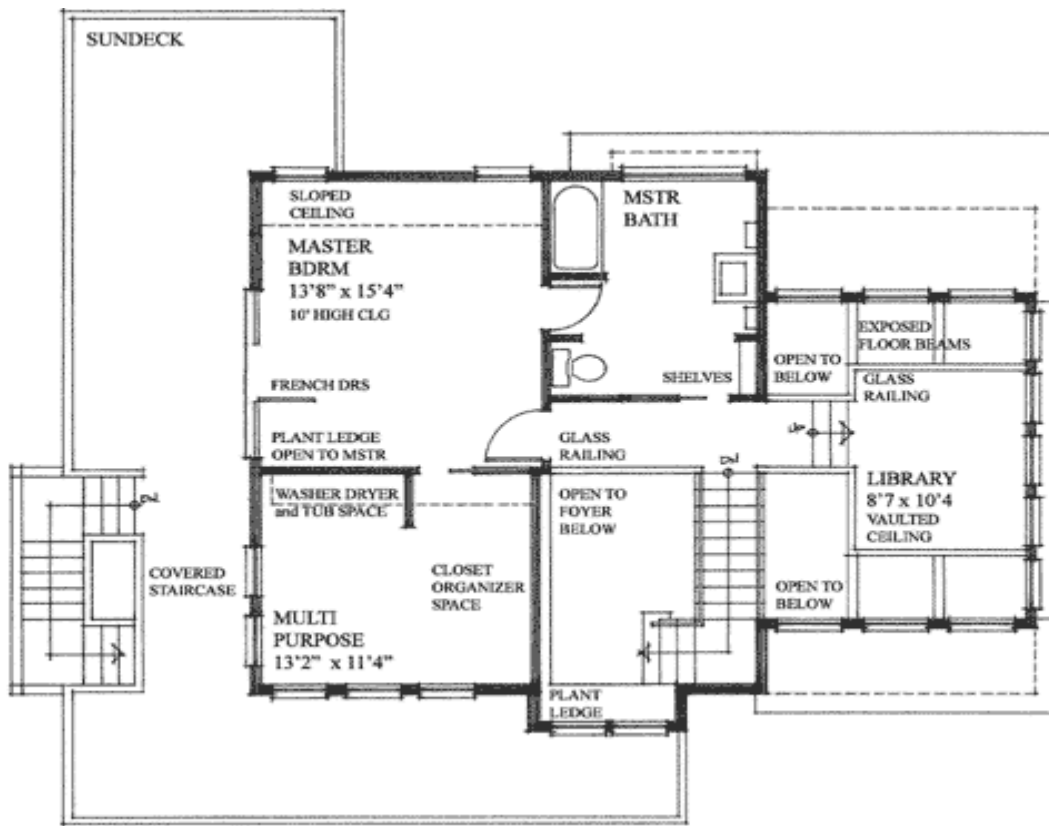

Sides/Rear



Rear elevation



Left elevation



Right elevation