

Architectural Designs ...selling quality house plans for over 30 years.

Plan W59031ND: Charming Front Porch



House plans are Copyright © 2009 by our architects and designers.

- Just imagine watching a sunset on the charming front porch of this log home plan.
- An open floor plan allows viewing the great room fireplace from both dining room and kitchen adding to the true enjoyment of this authentic log design.
- French doors in the dining room lead to a grilling porch with a handy eat-at bar to use as a buffet.
- Just off the kitchen you'll find a mud room to store your dirty gear.
- The master suite privately located on the main level and is complete with a soothing whirlpool tub.
- The upstairs loft area leads to two additional bedrooms with ample closet space plenty of natural light.

Style: Log, Mountain

Total Living Area: 2046

Main Flr.: 1440

2nd Flr.: 606

Porch, Combined: 640 sq. ft.

Total Square Feet: 2,686 sq. ft.

Bedrooms: 2

Full Bathrooms: 2

Half Bathrooms: 1

Width: 40'

Depth: 52'

Exterior Walls: Log

Ceiling Height:

Main Floor: 8'

Other: Vaulted Great Room

Standard Foundations: Crawl

Alternate Foundations: Walkout (\$250), Basement (\$250)
Special Features: PDF, 1st Floor Master Suite, Narrow Lot

One Set	Five Sets	Eight Sets	Reproducible	PDF File	CAD
\$575	\$660	\$695	\$880	\$880	\$1,500

Main Level

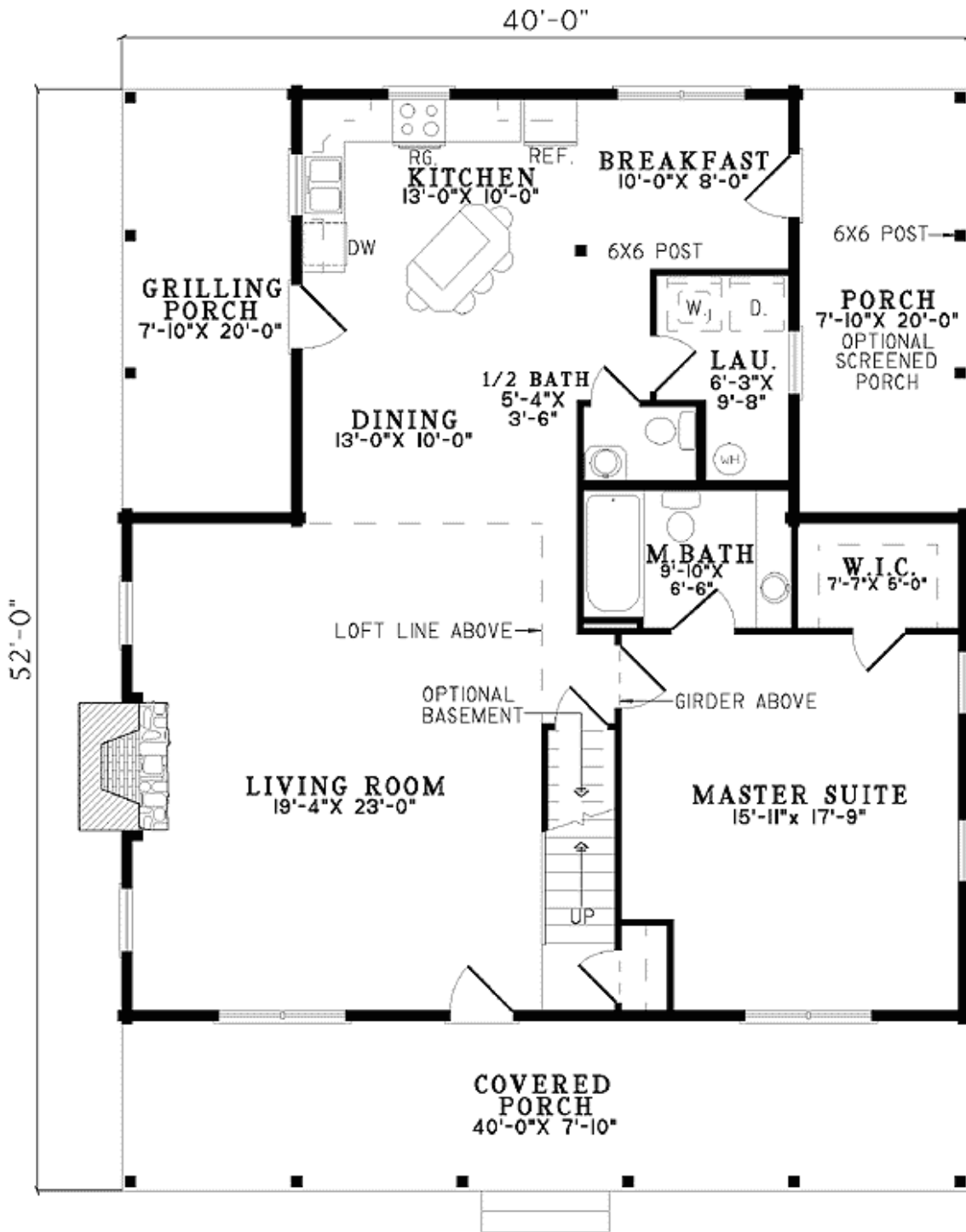

2nd Level

