

## Plan W8730GM: Country Relaxation



House plans are Copyright © 2009 by our architects and designers.

- The perfect spot for relaxing, a covered porch with columns and railings wraps around three sides of this country-style home. An open plan and nine-foot ceilings on the first floor communicate a spacious feeling in a compact floor plan.
- The family room with fireplace, the dining room and the L-shaped kitchen form one large living area. Access to the deck or patio in back is from the dining room. A laundry room serves as a transition between the kitchen and the walk to the detached garage.
- Privately situated on the first floor, the master suite contains a large walk-in closet and a bathroom with separate shower and tub. Upstairs, the secondary bedrooms share a compartmented bath. The built-in desk in the hall is a nice extra.
- Foundation: basement.

Style: Country, Farmhouse

Total Living Area: 1597

Main Flr.: 982

2nd Flr.: 615

Basement Unfinished: 982 sq. ft.

Front Porch: 308 sq. ft.

Entry: 24 sq. ft.

Total Square Feet: 3,459 sq. ft.

Detached Garage: 2 Car, 548 sq. ft.

Bedrooms: 4

Full Bathrooms: 2

Half Bathrooms: 1

Width: 71'

Depth: 42'6"

Maximum Ridge Height: 27'

Exterior Walls: 2x4

Ceiling Height:

Standard Foundations: Basement

Special Features: 1st Floor Master Suite

One Set  
\$450

Five Sets  
\$505

Eight Sets  
\$550

Reproducible  
\$670

## Main Level

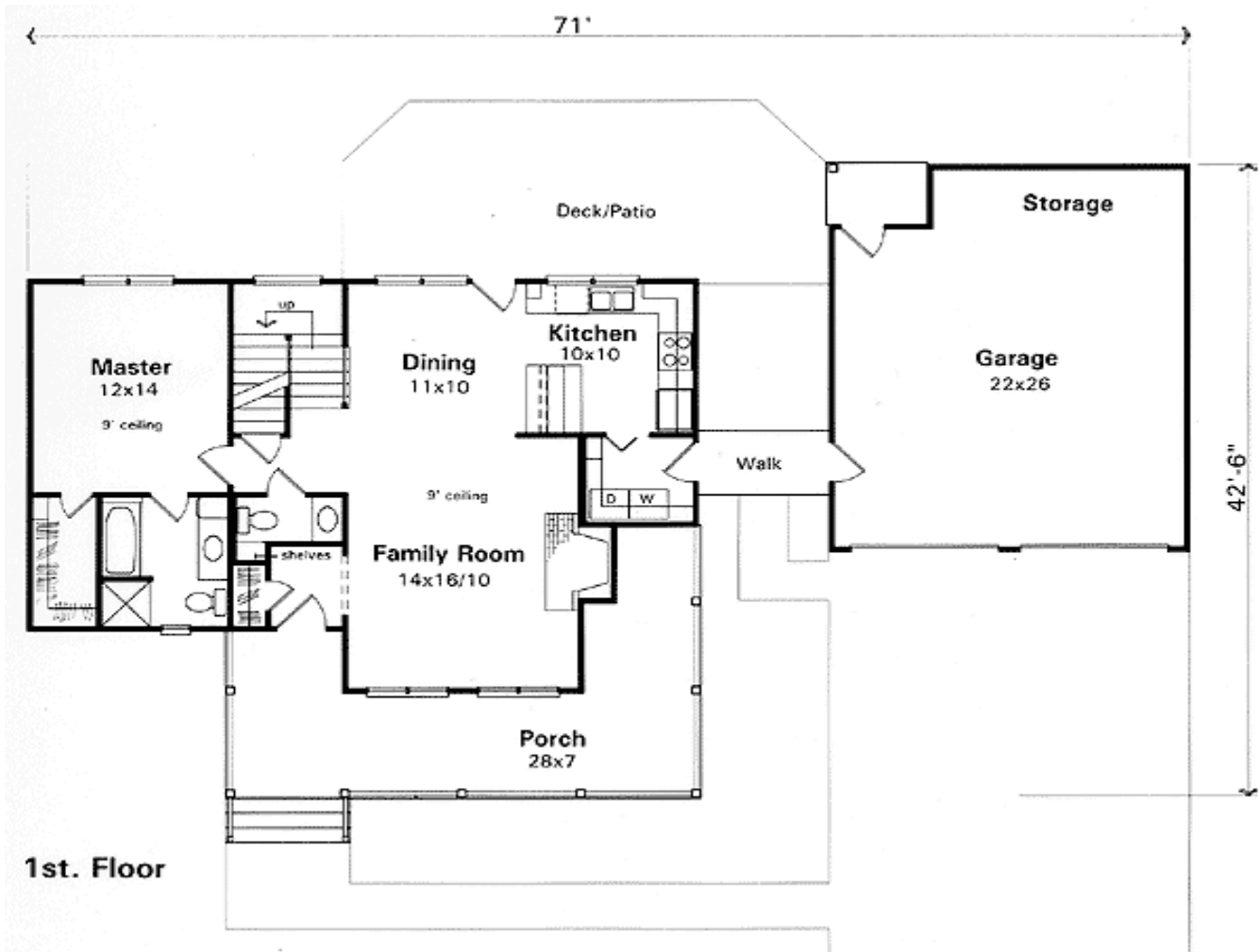

1st. Floor

2nd Level

