

Architectural Designs ...selling quality house plans for over 30 years.

Plan W77004LD: Space, Comfort and Elegance



House plans are Copyright © 2009 by our architects and designers.

- Covered porches and decks wrap almost entirely around this brick-faced country ranch, while the spacious interior offers both comfort and elegance.
- Natural light is creatively provided by skylights and solar tubes. In the open kitchen, note the walk-in pantry and the angled island with cooktop and raised eating bar.
- Each of the two rear bedrooms has a private covered deck and a walk-in clothes closet.
- On the opposite side of the home, you find the master suite and the adjacent living room. With the optional spa, this room can become a sunroom.
- The master suite features an oversized walk-in closet and a luxurious bath.
- Ceilings: 10' standard; 16' vaulted.
- Foundation: crawl space.

Style: Country, Northwest, Ranch

Total Living Area: 2778

Main Flr.: 2778

Porch, Combined: 980 sq. ft.

Deck: 316 sq. ft.

Total Square Feet: 5,071 sq. ft.

Attached Garage: 3 Car, 933 sq. ft.

Bedrooms: 3

Full Bathrooms: 2

Half Bathrooms: 1

Width: 84'

Depth: 63'6"

Maximum Ridge Height: 23'3"

Exterior Walls: 2x6

Ceiling Height:

Main Floor: 8'

Other: 10'-16'7" Vaulted Great Room; 11'8" Sunroom

Standard Foundations: Crawl

Alternate Foundations: Slab (\$250), Basement (\$250)

Special Features: 1st Floor Master Suite, CAD Available, PDF, In-Law Suite

One Set	Five Sets	Eight Sets	Reproducible	PDF File	CAD
\$665	\$740	\$810	\$1,000	\$1,000	\$1,735

Main Level

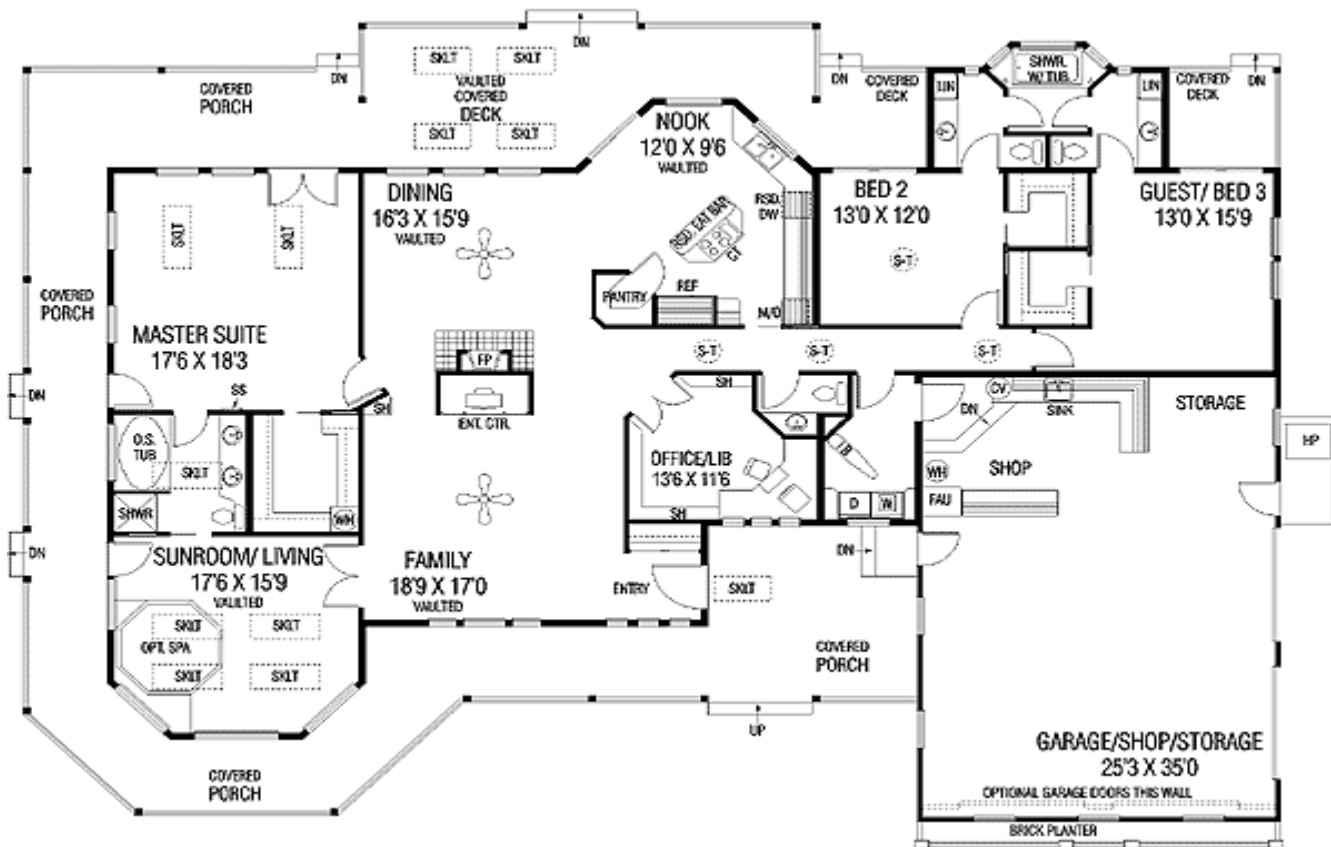

Rear View

