

Plan W11731HZ: French Country Split Plan



House plans are Copyright © 2009 by our architects and designers.

- This gorgeous 3 bed 2 bath French country split plan is loaded with extras. The painted brick exterior, arch top door and window give this home plan plenty of character and charm.
- You are greeted by a large foyer and open dining room and great room when you enter the door. The oversized great room has a fireplace with cabinets on each side and large windows and a French door leading to the spacious rear covered porch.
- A large kitchen with island is conveniently located next to great room for all those holiday gatherings.
- The luxurious master suite offers a whirlpool tub, large shower, compartmented toilet, make-up area, two linen closets, and large walk-in closet.
- Related Plan: For a slightly smaller version, see house plan 11742HZ.

Style: European, French Country, Metric

Total Living Area: 1800

Main Flr.: 1800

Front Porch: 33 sq. ft.

Rear Porch: 128 sq. ft.

Storage: 67 sq. ft.

Total Square Feet: 2,602 sq. ft.

Attached Garage: 2 Car, 574 sq. ft.

Bedrooms: 3

Full Bathrooms: 2

Width: 54'10"

Depth: 59'6"

Maximum Ridge Height: 24'1"

Exterior Walls: 2x4

Optional Exterior Walls: 2x6 \$225

Ceiling Height:

Main Floor: 9'

Other: 10' Great Room & Foyer; 11' Dining Room; 10' Tray MBR

Standard Foundations: Slab, Crawl

Alternate Foundations: Basement (\$225)

Special Features: Corner Lot, CAD Available, 1st Floor Master Suite, Split Bedrooms, PDF

One Set	Five Sets	Eight Sets	Reproducible	PDF File	CAD
\$495	\$625	\$695	\$795	\$795	\$1,145

Main Level

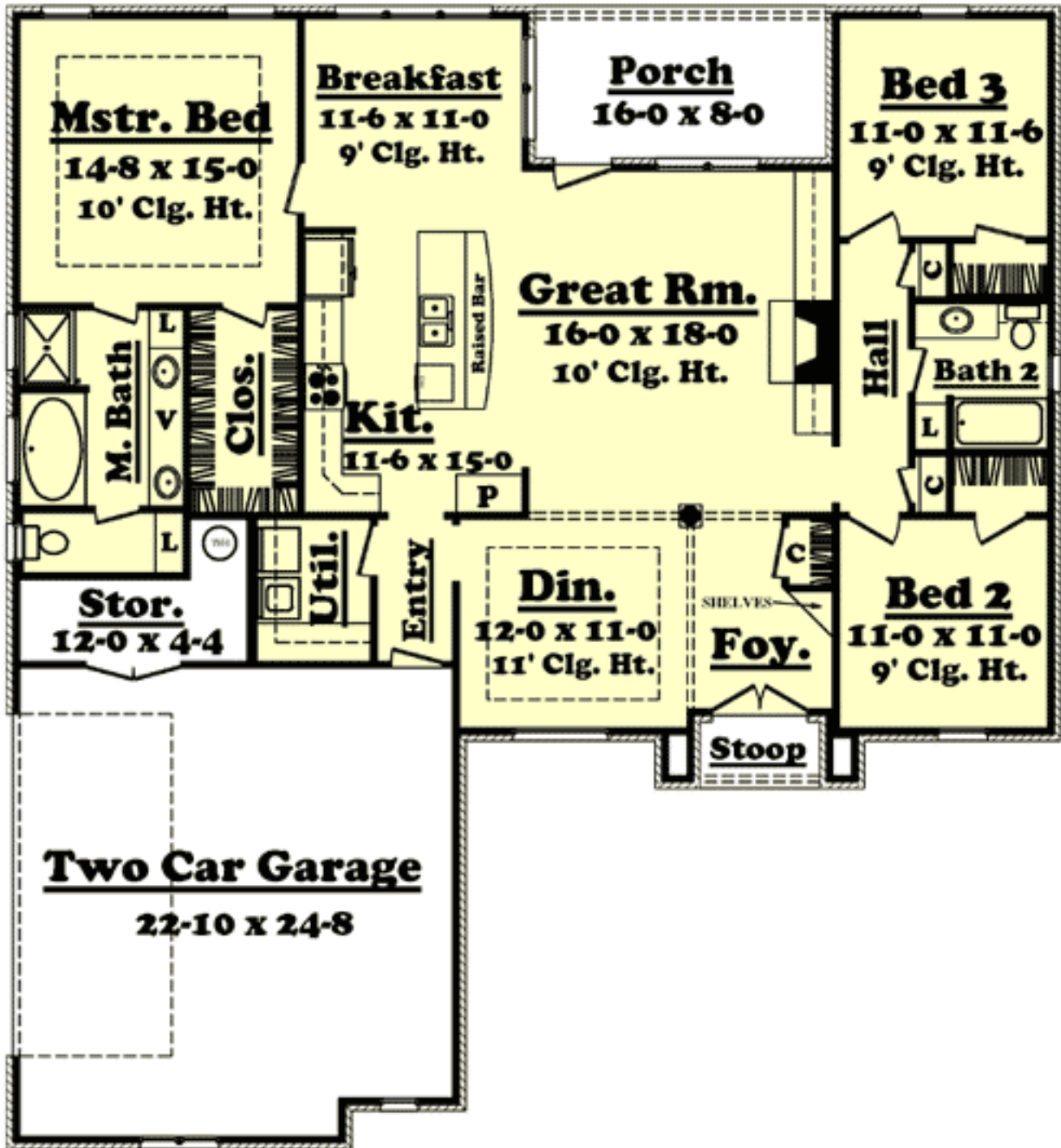

Rear View

