

Architectural Designs ...selling quality house plans for over 30 years.

Plan W3820JA: Victorian Styling in a Small Package



House plans are Copyright © 2009 by our architects and designers.

- This modest one-story plan nevertheless provides authentic Victorian styling, including high ceilings in most rooms, gables trimmed with gingerbread, a dramatic turret, oval and round windows and a covered front porch.
- A corner fireplace dominates the great room, also notable for its 10-foot stepped ceiling. A convenient pass-through separates the great room from the galley-style kitchen. Both the adjacent dining room and the great room overlook the backyard. The turreted breakfast room could easily be used as a family room. Nearby, the good-sized laundry room contains a pantry closet.
- Secluded on one side of the house and in back, the master suite is a true retreat. A 10-foot stepped ceiling and a cozy window seat are features of the bedroom, while the compartmented bath includes a walk-in closet, a dressing area, two sinks, garden tub and separate shower. Two other bedrooms share a full bath.
- Foundation: basement, slab or crawl space.

Style: Cottage, Victorian

Total Living Area: 1466

Main Flr.: 1466

Basement Unfinished: 1,498 sq. ft.

Deck: 231 sq. ft.

Total Square Feet: 3,678 sq. ft.

Attached Garage: 2 Car, 483 sq. ft.

Bedrooms: 3

Full Bathrooms: 2

Width: 60'

Depth: 39'10"

Maximum Ridge Height: 25'6"

Exterior Walls: 2x4

Ceiling Height:

Main Floor: 9'

Other: 10' Great Room; 16' Breakfast; 10' Step Master; Vaulted BR#2"

Standard Foundations: Slab, Basement, Crawl

Special Features: PDF, Photo Gallery, 1st Floor Master Suite, Split Bedrooms

Five Sets	Eight Sets	Reproducible	PDF File	CAD
\$495	\$530	\$645	\$645	\$1,145

Main Level

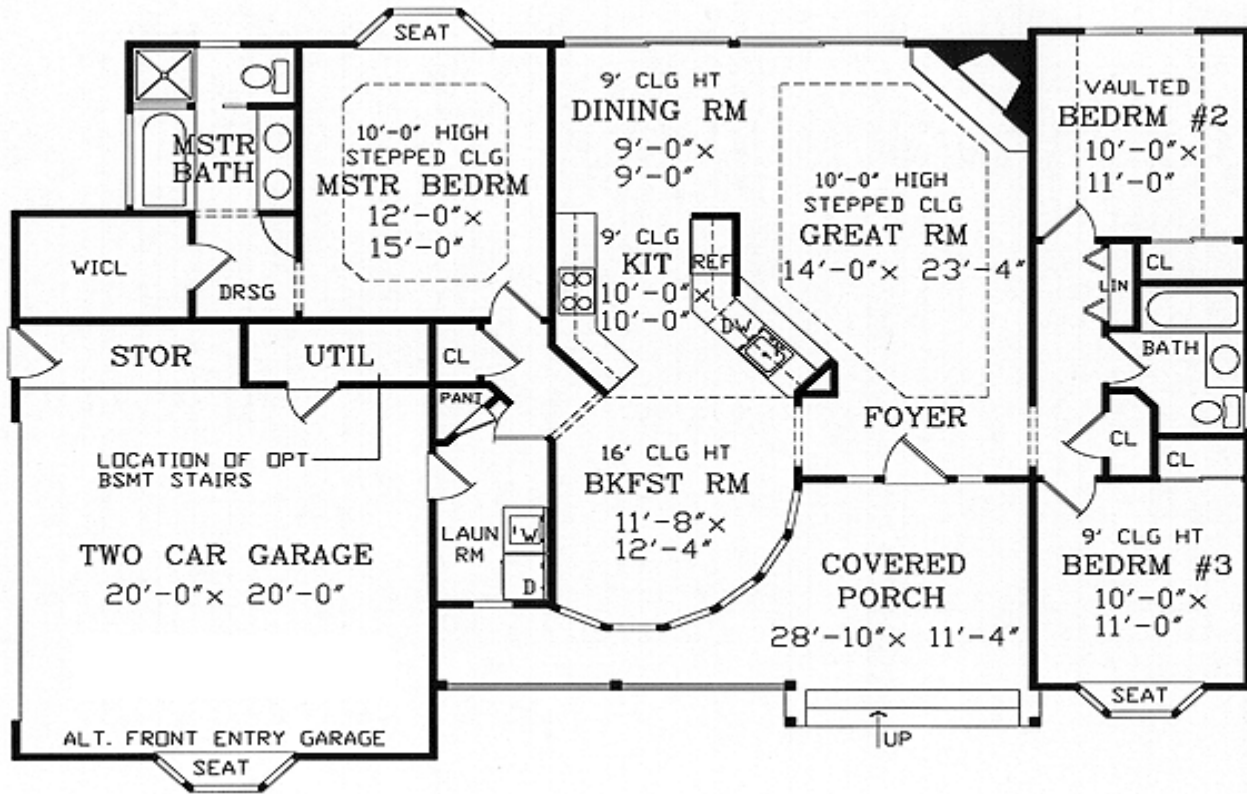

Architectural Designs ...selling quality house plans for over 30 years.

Photo



Photo #2



Rear View



Great Room



Architectural Designs ...selling quality house plans for over 30 years.

Kitchen



Nook

