

Architectural Designs ...selling quality house plans for over 30 years.

Plan W5310Q: For an Urban or Country Setting



House plans are Copyright © 2009 by our architects and designers.

- This comfortable contemporary home, suitable for a sloping site with a view, features a vaulted sunroom for collecting and storing passive solar energy.
- To the left of the two-story hall, the great room spans the full depth of the house. Bay windows brighten the living area; the island kitchen fills an end wall.
- French doors flanking the wood stove regulate the flow of solar-warmed air from the two-story, skylighted sun room. A masonry wall backing the wood stove and a masonry floor serve as heat storage in the sunroom. Glass shutters in the bedrooms also allow the sunroom to warm the upper floor.
- The vaulted master bedroom and a second bedroom, each with a private bath, complete the upstairs. Both bedrooms have skylights.
- The full daylight basement has a third bedroom and full bath as well as a large recreation room with a sitting room and access to the porch.
- Foundation: crawl space. See house plan 5391Q for a version with a full daylight basement.

Style: Contemporary, Northwest, Vacation

Total Living Area: 1505

Main Flr.: 863

2nd Flr.: 642

Attached Garage: 2 Car, 445 sq. ft.

Bedrooms: 2

Full Bathrooms: 2

Half Bathrooms: 1

Width: 60'5"

Depth: 32'

Maximum Ridge Height: 27'

Exterior Walls: 2x6

Ceiling Height:

Main Floor: 8'

2nd Floor: 8'

Other: 12' BR#2 & MBR 16' Sun Room

Standard Foundations: Crawl
Special Features: Sloping Lot

One Set
\$450

Five Sets
\$505

Eight Sets
\$550

Reproducible
\$670

Main Level

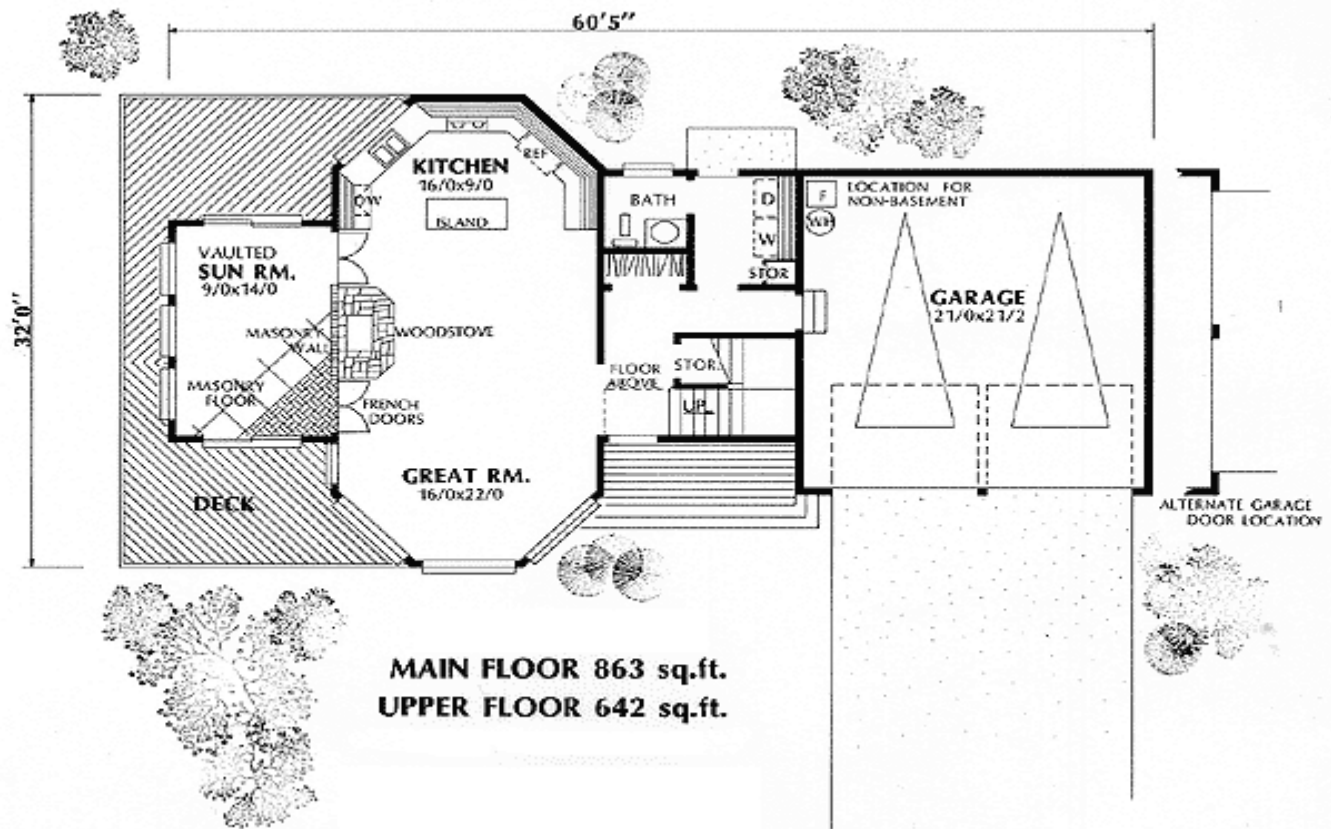

2nd Level

