

# Architectural Designs ...selling quality house plans for over 30 years.

Plan W35023GH



House plans are Copyright © 2009 by our architects and designers.

Style: Log, Metric, Mountain

Total Living Area: 2616

Main Flr.: 1895

2nd Flr.: 721

Basement Unfinished: 841 sq. ft.

Total Square Feet: 3,457 sq. ft.

Bedrooms: 3

Full Bathrooms: 2

Width: 66'

Depth: 44'11"

Maximum Ridge Height: 24'11"

Exterior Walls: Log

Ceiling Height:

Main Floor: 11'6"

2nd Floor: 9'

Standard Foundations: Combo Basement-Crawl

Special Features: PDF, CAD Available, Drive Under Garage, Loft, Sloping Lot

Five Sets	Eight Sets	Reproducible	PDF File	CAD
\$725	\$820	\$750	\$900	\$900

## Main Level

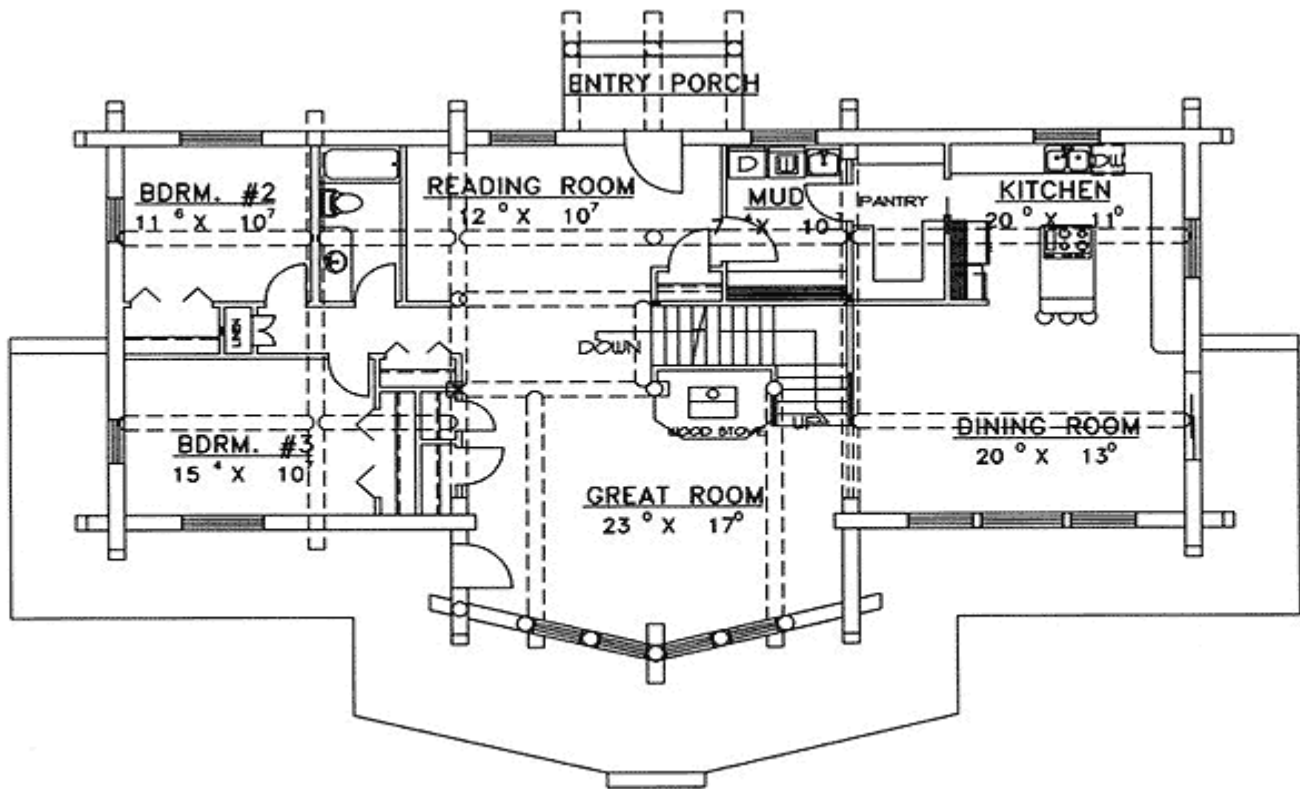

## 2nd Level

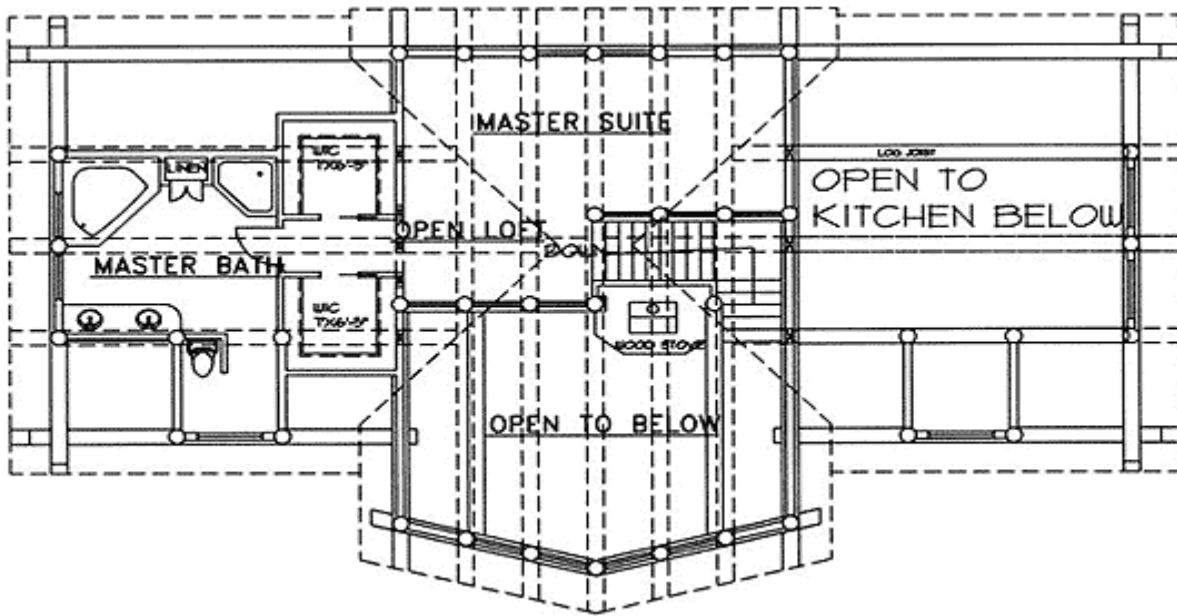

Lower Level

