

# Architectural Designs ...selling quality house plans for over 30 years.

Plan W14465RK: Beamed Great Room



House plans are Copyright © 2009 by our architects and designers.

- Beams in the great room of this stunning Craftsman home plan make a dramatic impression.
- A domed ceiling in the foyer sets the stage for what is to come and allows views straight back to the deck in the rear.
- The gourmet kitchen has all the counter space you could ask for with two islands.
- Both the vaulted breakfast nook and the hearth room are open to the kitchen for a wonderful flow.
- The master suite has a vaulted tray ceiling and its own sitting area that opens to the deck through sliding glass doors.
- Send everyone down to the huge level to play in the billiards room with large wet bar or the theater room that will hold any crowd.
- Three bedrooms and an exercise room complete this luxurious level.

Style: Craftsman, Luxury, Premium Collection, Ranch

Total Living Area: 4790

Main Flr.: 2588

Lower Level: 2202

Total Square Feet: 5,794 sq. ft.

Attached Garage: 4 Car, 1,004 sq. ft.

Bedrooms: 4

Full Bathrooms: 3

Width: 101'3"

Depth: 79'4"

Maximum Ridge Height: 25'6"

Exterior Walls: 2x6

Ceiling Height:

Main Floor: 10'

Lower Floor: 9'

Other: 14' Beamed Great Room; Tray MBR; 11'6" Theater

Standard Foundations: Walkout

Alternate Foundations: Slab (\$350), Crawl (\$350)

Special Features: 1st Floor Master Suite, Den-Office-Library-Study, Butler Walk-in Pantry, Media-Game-Home Theater, Sloping Lot, Jack & Jill Bath, Photo Gallery, CAD Available, PDF

One Set	Five Sets	Eight Sets	Reproducible	PDF File	CAD
\$700	\$800	\$890	\$900	\$900	\$995

## Main Level

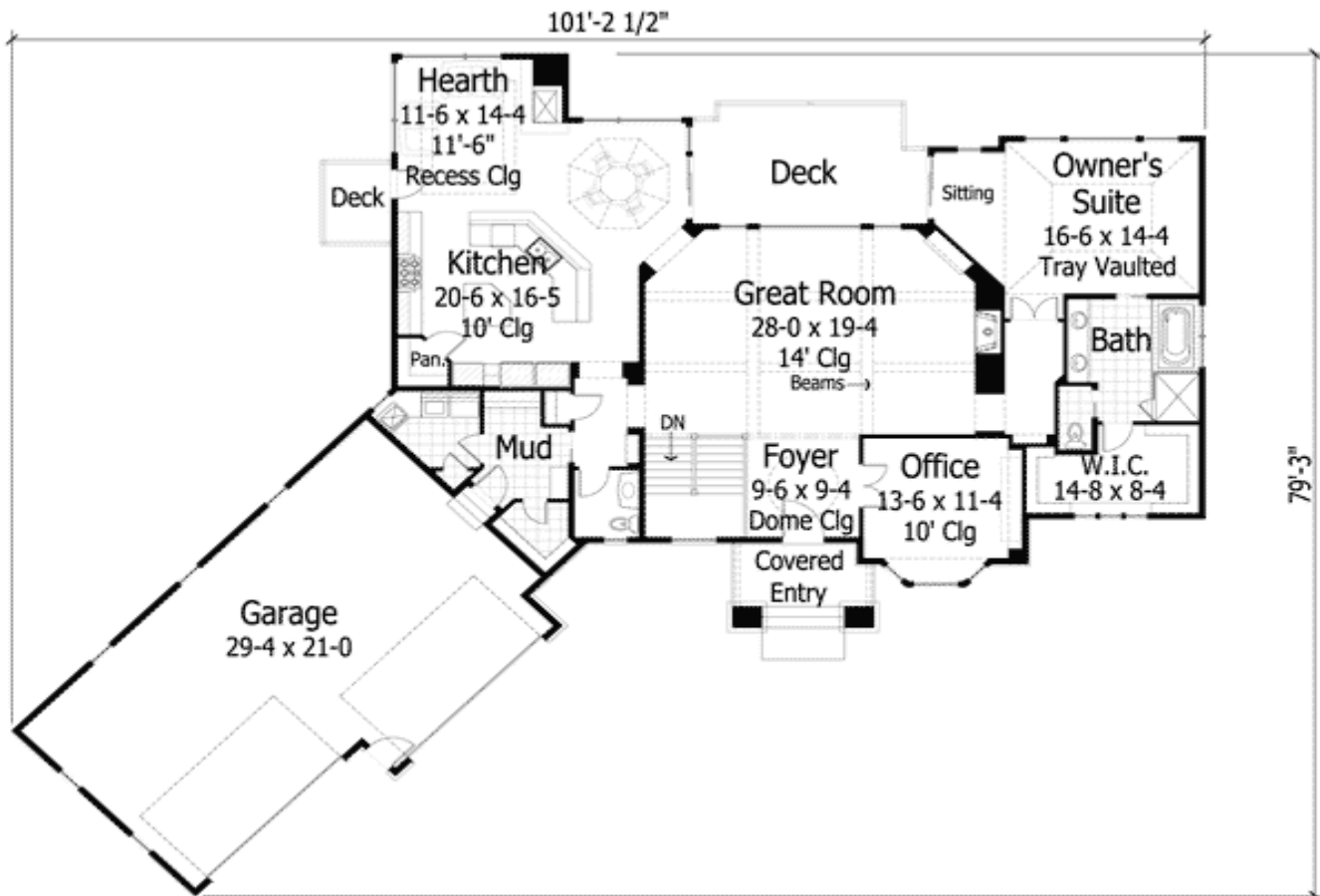

## Lower Level

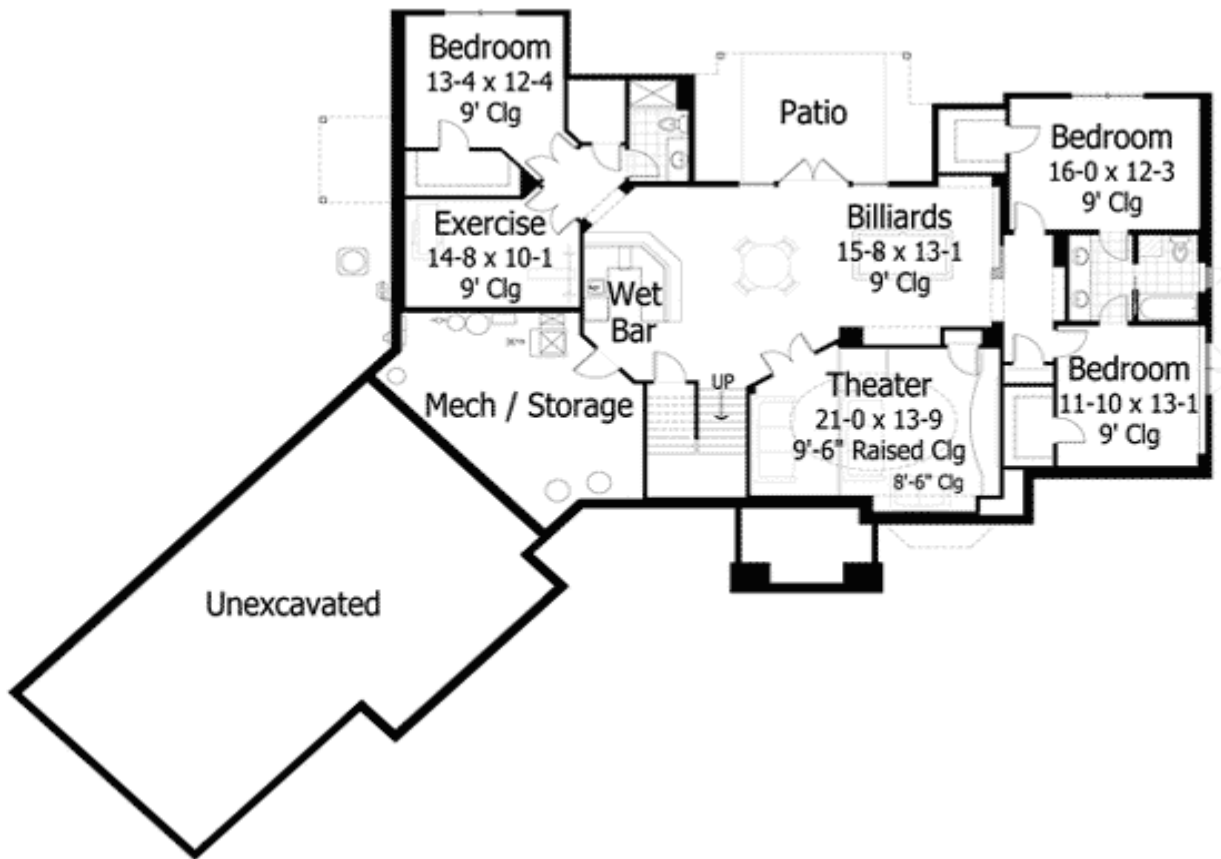

# Architectural Designs ...selling quality house plans for over 30 years.

Photo



Rear View



Foyer



Great Room



Great Rm Vw2



Kitchen



Sunroom



## Theater

