

# Architectural Designs ...selling quality house plans for over 30 years.

Plan W48084FM: House Plan with Two Exteriors



House plans are Copyright © 2009 by our architects and designers.

- This three bedroom house plan comes in two versions giving you the ability to choose the right look for you. Both share the same basic layout and large central great room with fireplace and rear patio access.
- The kitchen is at the hub of activity with a bar ledge open from the great room and sight lines across that room and out the back. A nearby utility room is off the three-car garage which gives you convenient access for bringing in the groceries.
- The master suite is secluded and has its own private outdoor area. Dual sinks and a walk-in closet are nice touches.
- Two more bedrooms and a study complete this home plan.
- Related Plan: For an alternate elevation, see house plan 48171FM.

Style: Southern

Total Living Area: 2061

Main Flr.: 2061

Total Square Feet: 2,705 sq. ft.

Attached Garage: 3 Car, 644 sq. ft.

Bedrooms: 3

Full Bathrooms: 2

Half Bathrooms: 1

Width: 88'

Depth: 40'9"

Maximum Ridge Height: 26'

Exterior Walls: 2x4

Ceiling Height:

Main Floor: 9'

Other: 10' Great Room, Study & BR#3; 8'-10' Sloped MBR

Standard Foundations: Slab, Crawl

Special Features: 1st Floor Master Suite, Corner Lot, Den-Office-Library-Study, Split Bedrooms

One Set  
\$760

Five Sets  
\$800

Eight Sets  
\$920

Reproducible  
\$1,070

## Main Level

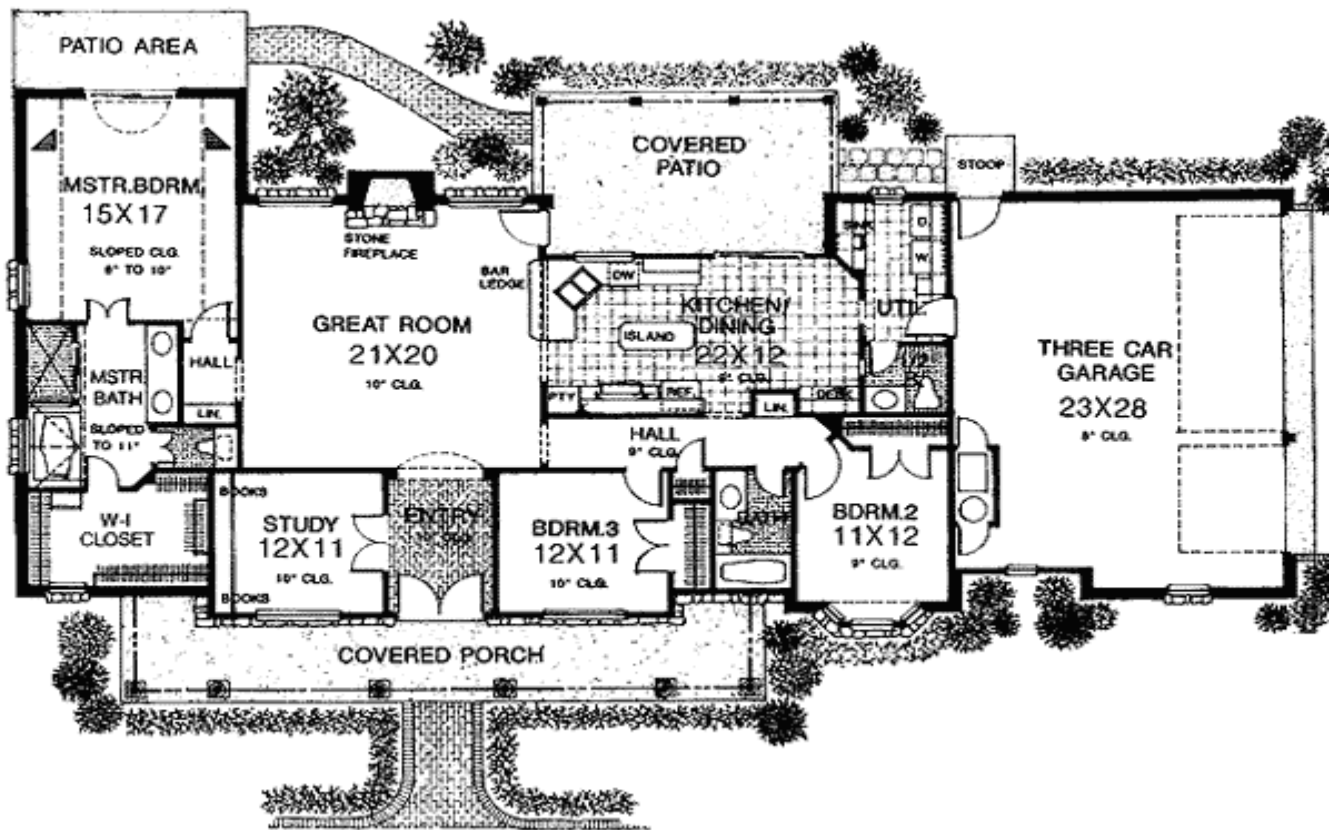

Rear View

