

# Architectural Designs ...selling quality house plans for over 30 years.

Plan W3083D: Vacation or City Home



House plans are Copyright © 2009 by our architects and designers.

- With its slender footprint, this country/Victorian home with an open plan works well on a narrow lot, as in-fill housing or as a vacation home in a resort community.
- Covered porches in both front and back offer outdoor living space.
- The formal dining room is accessed from either the entry foyer or the kitchen with its pantry closet. An angled eating bar divides the kitchen from the bayed morning room and the spacious living room with built-in cabinets.
- A walk-in closet and a private bath are featured in the master suite, while the other bath is placed between bedrooms two and three.
- Ceilings: 10' standard.
- Foundation options: basement, slab or crawl space. Specify when ordering.
- Related Plan: For a larger version of this house plan, see 31088D.

Style: Country, Vacation, Victorian

Total Living Area: 1544

Main Flr.: 1544

Basement Unfinished: 1,544 sq. ft.

Front Porch: 202 sq. ft.

Deck: 142 sq. ft.

Total Square Feet: 3,432 sq. ft.

Bedrooms: 3

Full Bathrooms: 2

Width: 39'

Depth: 54'

Maximum Ridge Height: 26'

Exterior Walls: 2x4

Ceiling Height:

Main Floor: 10'

Standard Foundations: Slab, Basement, Crawl

Special Features: Narrow Lot, CAD Available, 1st Floor Master Suite, Photo Gallery

One Set	Five Sets	Eight Sets	Reproducible	CAD
\$510	\$565	\$620	\$795	\$1,765

## Main Level

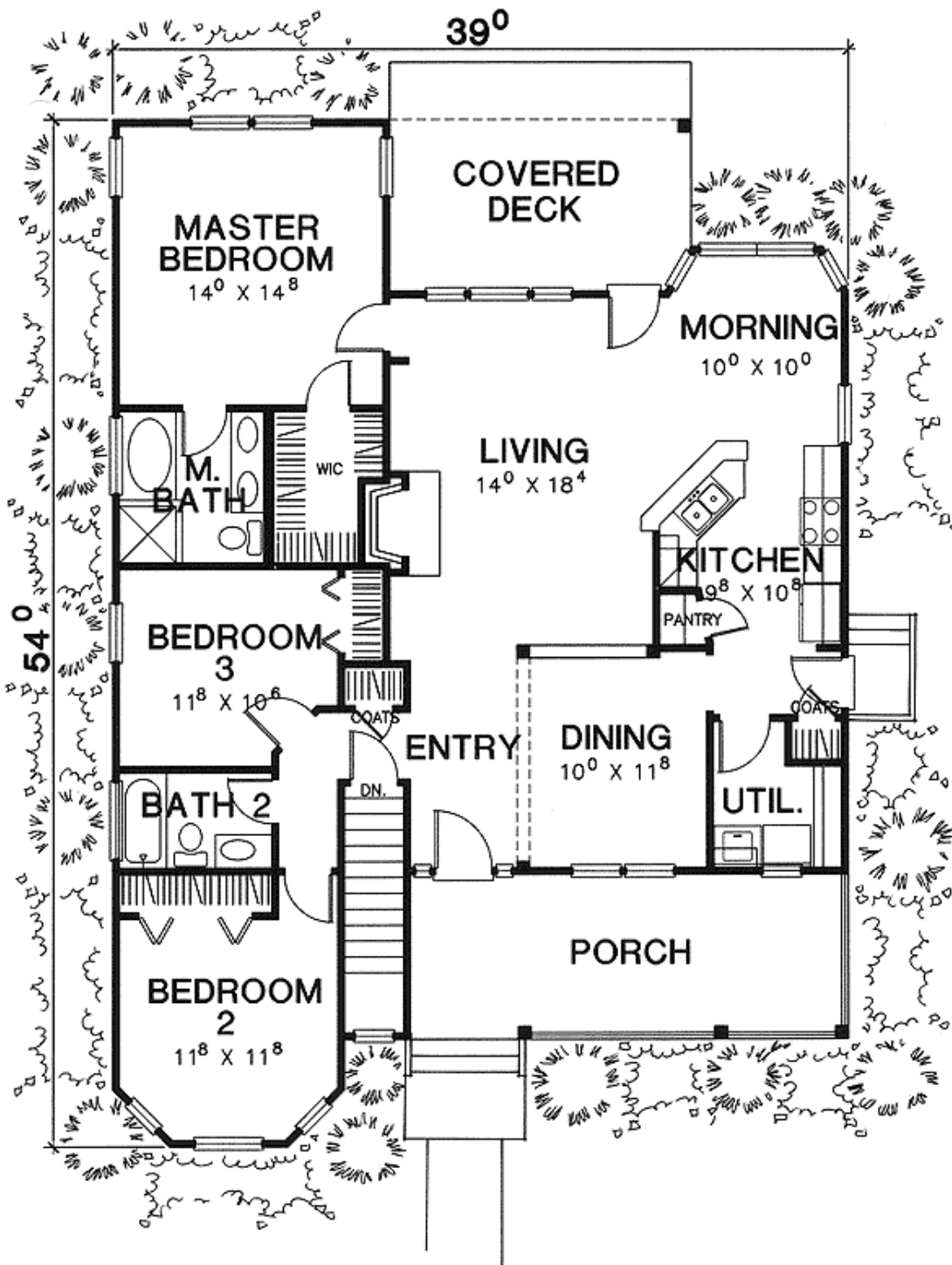

# Architectural Designs ...selling quality house plans for over 30 years.

Photo



Rear View

