

Architectural Designs ...selling quality house plans for over 30 years.

Plan W7606MC: French Country Design on One Level

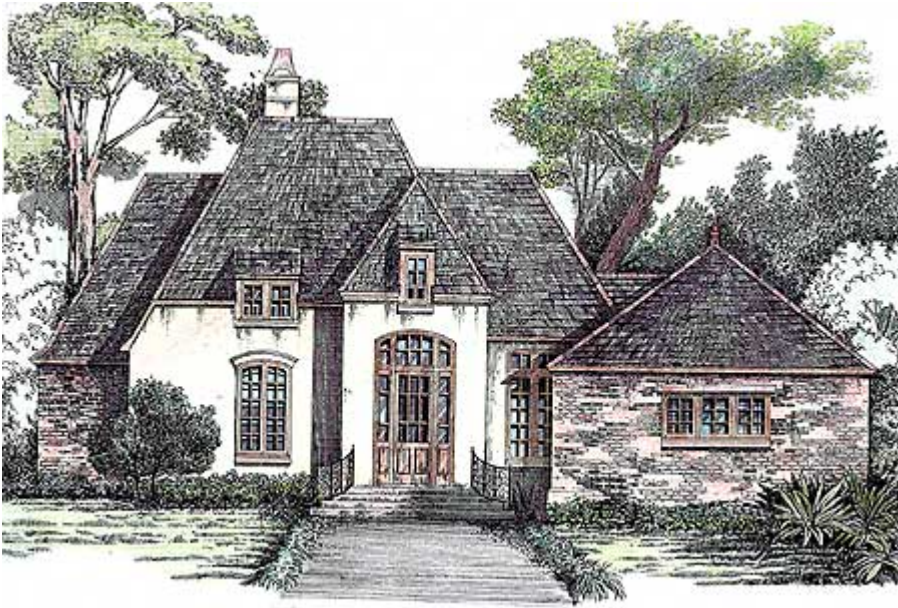

House plans are Copyright © 2009 by our architects and designers.

- Although of relatively modest square footage and built entirely on one level, this French country house plan gives the impression of a larger dwelling.
- Surrounded by glass, the front door takes you into the foyer. From here, you see the dining room on one side and the family room ahead.
- The family room forms one large space with the breakfast room and kitchen. In the kitchen, note the angled eating bar and the walk-in pantry.
- Isolated in back, the master suite includes a garden tub, separate shower, spacious walk-in closet and two vanities separated by a make-up area.
- The second full bath is located close to bedrooms two and three, while the third bath can be entered from either the side hall or bedroom four. This bedroom could be used by an in-law, a teenager or guests.
- With the addition of double doors to the foyer, bedroom three could be a study or home office.
- House plan foundation: slab.

Style: European, French Country

Total Living Area: 2300

Main Flr.: 2300

Total Square Feet: 2,793 sq. ft.

Attached Garage: 2 Car, 493 sq. ft.

Bedrooms: 4

Full Bathrooms: 3

Width: 58'10"

Depth: 83'

Maximum Ridge Height: 26'

Exterior Walls: 2x4

Ceiling Height:

Main Floor: 9'

Other: 12' Foyer; 11' Family, Kitchen, Breakfast, Dining, Rear Porch, Pantry and BR#3; 10' MBR

Standard Foundations: Slab

Special Features: 1st Floor Master Suite

One Set	Five Sets	Eight Sets	Reproducible
\$732	\$814	\$891	\$1,100

Main Level

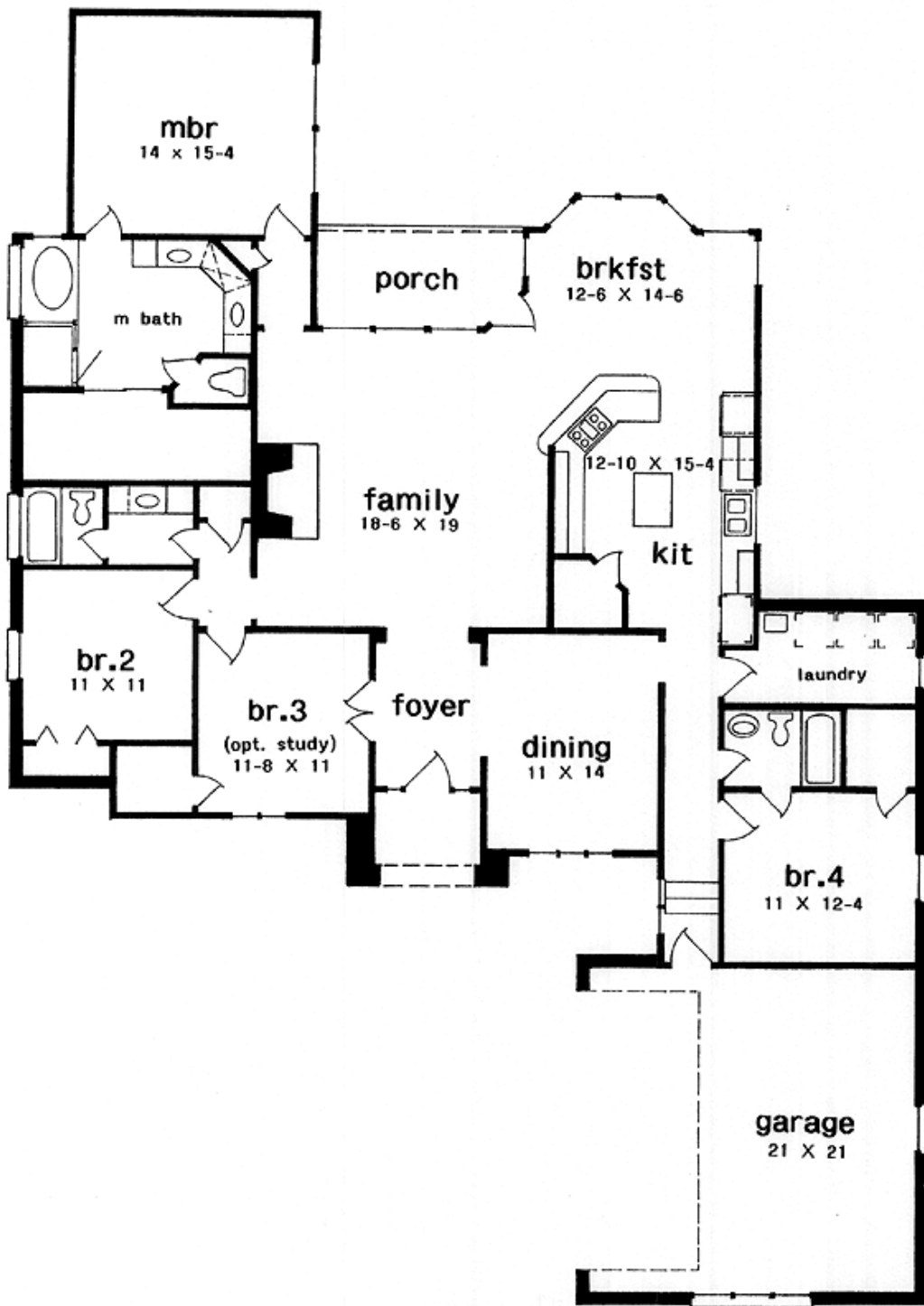

Rear View



Rear Elevation