

# Architectural Designs ...selling quality house plans for over 30 years.

Plan W11068G: Perfect Duplex for Family Living



House plans are Copyright © 2009 by our architects and designers.

- A family can easily spread out in one of these duplex units.
- There is an efficient U-shape kitchen, which includes a double sink and ample cabinet and closet space.
- The dining room, with arched entries on three sides, is graced with a large front window.
- In close proximity to the kitchen and the dining room, the sloped ceiling living room is excellent for entertaining.
- The bedrooms are located for privacy in the rear of the home.
- This duplex home plan is designed with basement, slab, and crawlspace foundation options.

Style: Multi-Family

Total Living Area: 2860

Main Flr.: 1430

Front Porch: 90 sq. ft.

Total Square Feet: 3,682 sq. ft.

Attached Garage: 1 Car, 321 sq. ft.

Bedrooms: 3

Full Bathrooms: 2

Width: 84'

Depth: 56'8"

Maximum Ridge Height: 21'

Exterior Walls: 2x4 or 2x6

Ceiling Height:

Main Floor: 8'

Standard Foundations: Slab, Basement, Crawl

Special Features: CAD Available, PDF

One Set	Five Sets	Eight Sets	Reproducible	PDF File	CAD
\$645	\$725	\$755	\$895	\$895	\$1,495

## Main Level

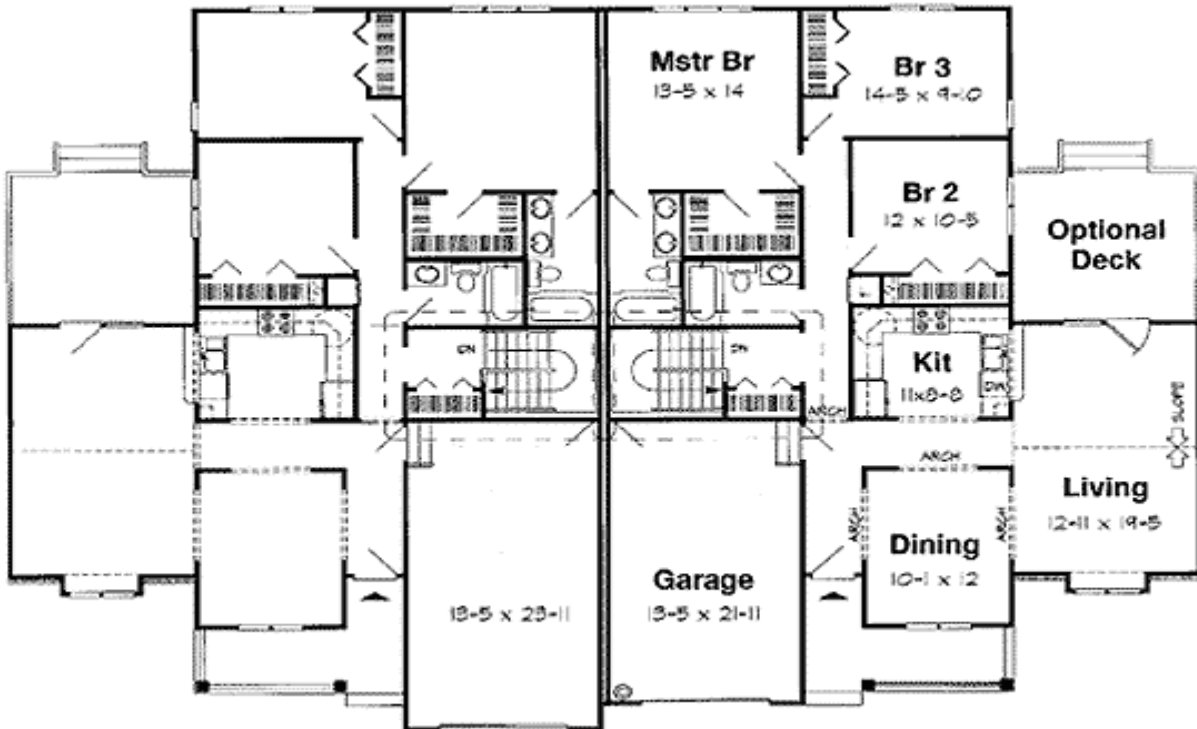

Rear View

