

## Plan W6273V: Split-Bedroom Privacy



House plans are Copyright © 2009 by our architects and designers.

- Traditional in style, this home sports a trio of lovely window treatments in front. Four sturdy columns support the sheltered front porch, where guests make their way into the foyer.
- The foyer leads either to the great room or to the two family bedrooms and their shared bath. In the great room, built-in cabinets surround the fireplace, and a cathedral ceiling opens up the space.
- Through a wide opening, you find the open dining-kitchen combination. Notice the island snack bar and the pantry closet. This area accesses a laundry room and the covered porch in back.
- Placed in its own wing for privacy, the master suite includes a walk-in closet and a bathroom with a garden tub and a separate shower.
- Foundation options: basement, slab or crawl space.

Style: Country, Farmhouse, Ranch

Total Living Area: 1626

Main Flr.: 1626

Basement Unfinished: 1,626 sq. ft.

Front Porch: 168 sq. ft.

Rear Porch: 142 sq. ft.

Total Square Feet: 4,100 sq. ft.

Carport Garage: 2 Car, 538 sq. ft.

Bedrooms: 3

Full Bathrooms: 2

Width: 58'

Depth: 57'8"

Maximum Ridge Height: 23'

Exterior Walls: 2x4

Ceiling Height:

Main Floor: 9'

Standard Foundations: Slab, Basement, Crawl

Special Features: 1st Floor Master Suite, Carport, PDF, Butler Walk-in Pantry, Corner Lot, Split Bedrooms, Carport

One Set	Five Sets	Eight Sets	Reproducible	PDF File
\$505	\$565	\$595	\$735	\$735

# Architectural Designs ...selling quality house plans for over 30 years.

## Main Level

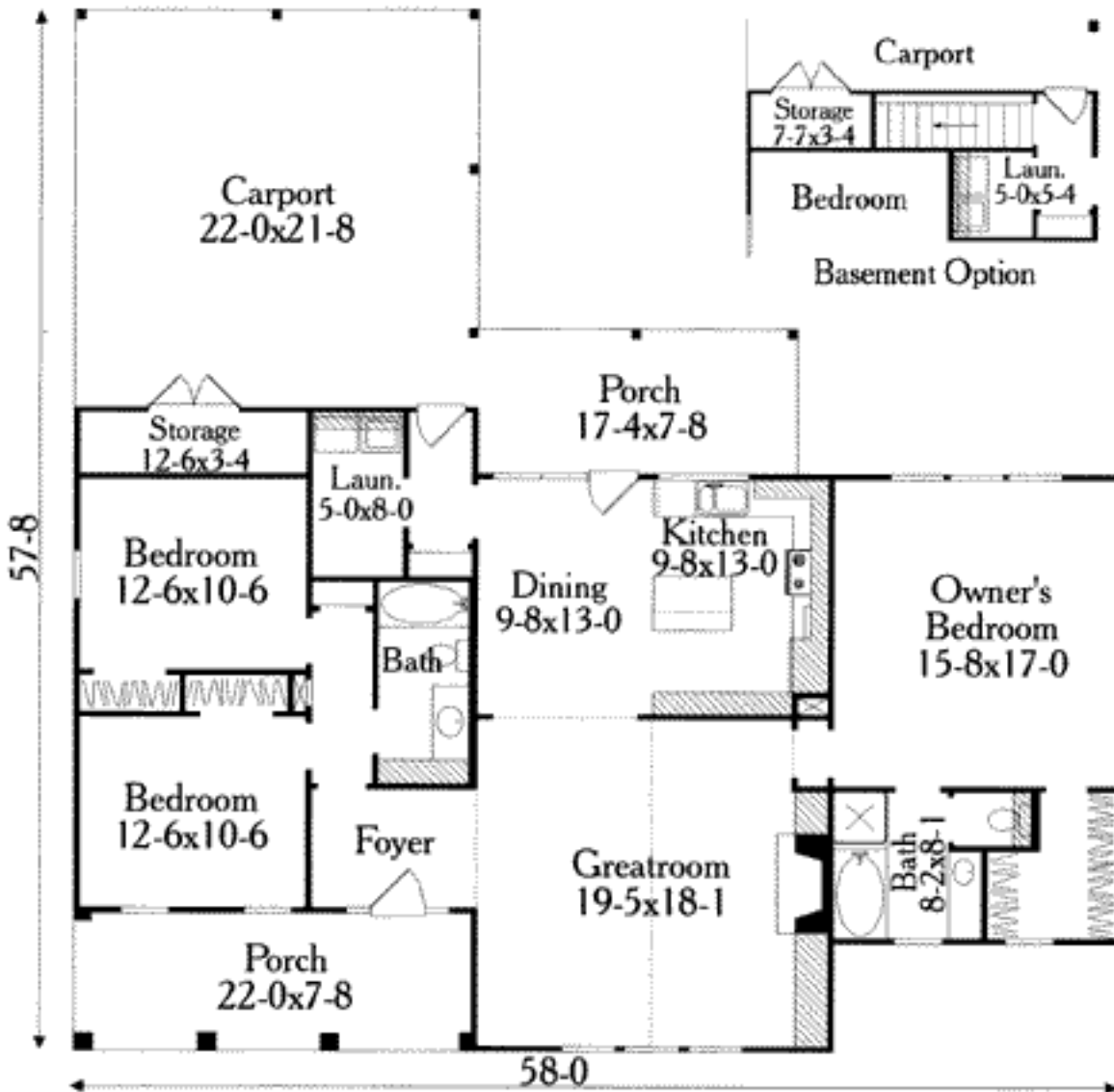

Rear View

