

# Architectural Designs ...selling quality house plans for over 30 years.

Plan W88110SH: Two Perfect Designs



House plans are Copyright © 2009 by our architects and designers.

- Two distinct exteriors can be built from the details for this plan.
- The grand entry allows for a twelve-foot ceiling in the foyer. Open planning calls for columns to separate the formal living and dining rooms from the foyer and central hall. Both rooms have tray ceilings, the living room has a fireplace and double door access to the skylit lanai.
- The modified U-shaped kitchen has an attached breakfast room and steps down to the family room with fireplace and optional wet bar.
- A lovely octagonal foyer introduces family bedrooms and their private baths.
- A den with tray ceiling and full bath sits to the right of the foyer, doubling as guest room space as needed.
- The master suite has access to the rear yard, a walk-in closet and a full bath with whirlpool tub, double vanity, compartmented toilet and separate shower. The whirlpool overlooks a private garden. Note the two-car garage just beyond the laundry area.
- Ceilings: 10'.
- Foundation: basement or crawl space, please specify preference when ordering.

Style: Canadian, Florida, Southern

Total Living Area: 3018

Main Flr.: 3018

Total Square Feet: 3,582 sq. ft.

Attached Garage: 2 Car, 564 sq. ft.

Bedrooms: 3

Full Bathrooms: 4

Width: 76'

Depth: 82'

Maximum Ridge Height: 26'

Exterior Walls: 2x6

Ceiling Height:

Main Floor: 10'

Standard Foundations: Basement, Crawl

Special Features: PDF

One Set	Five Sets	Eight Sets	Reproducible	PDF File	CAD
\$650	\$700	\$740	\$850	\$850	\$1,150

## Main Level

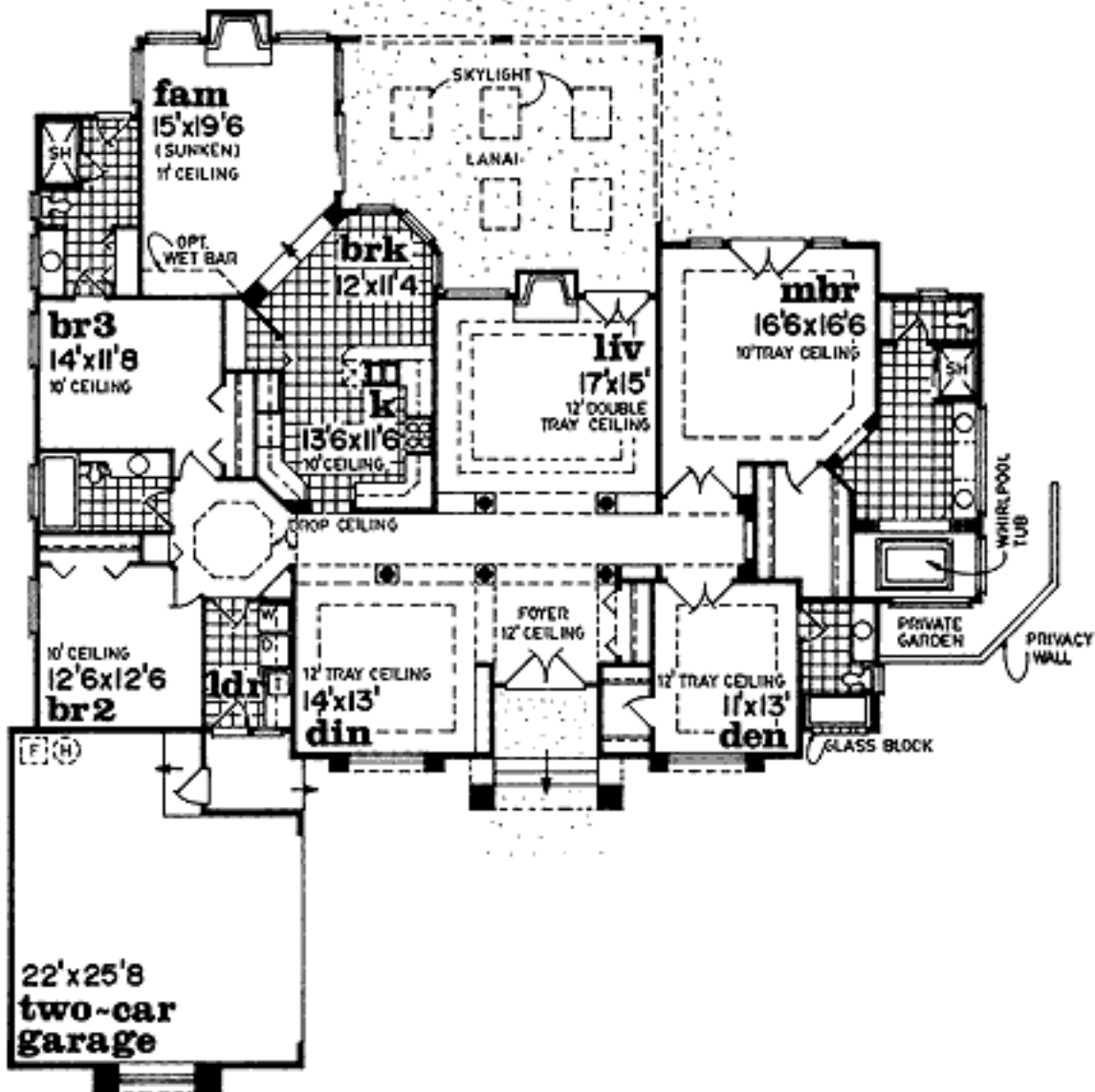

Rear View

