

Architectural Designs ...selling quality house plans for over 30 years.

Plan W59046ND: Unbelievable Views



House plans are Copyright © 2009 by our architects and designers.

- This two story plan has an unbelievable view in the Great room with vaulted ceiling and windows two stories high.
- The Great room and dining room open into the kitchen making a great area for large furniture and gatherings.
- Two bedrooms and a bathroom are located on the main level with a convenient laundry closet near the garage entry.
- A beautiful staircase leads to the upper level master suite and roomy loft area with spectacular view through the great room windows.
- Ceilings: 8' standard.
- Foundation: Basement, crawl space, daylight basement. Please specify your preference when ordering.

Style: Log, Mountain

Total Living Area: 1896

Main Flr.: 1202

2nd Flr.: 694

Deck: 216 sq. ft.

Entry: 64 sq. ft.

Total Square Feet: 2,752 sq. ft.

Attached Garage: 2 Car, 576 sq. ft.

Bedrooms: 3

Full Bathrooms: 2

Width: 49'8"

Depth: 63'8"

Exterior Walls: Log

Ceiling Height:

Main Floor: 8'

Other: 2-Story Vaulted Great Room

Standard Foundations: Crawl

Alternate Foundations: Walkout (\$250), Basement (\$250)

Special Features: PDF, Narrow Lot

One Set	Five Sets	Eight Sets	Reproducible	PDF File	CAD
\$545	\$610	\$640	\$790	\$790	\$1,350

Main Level

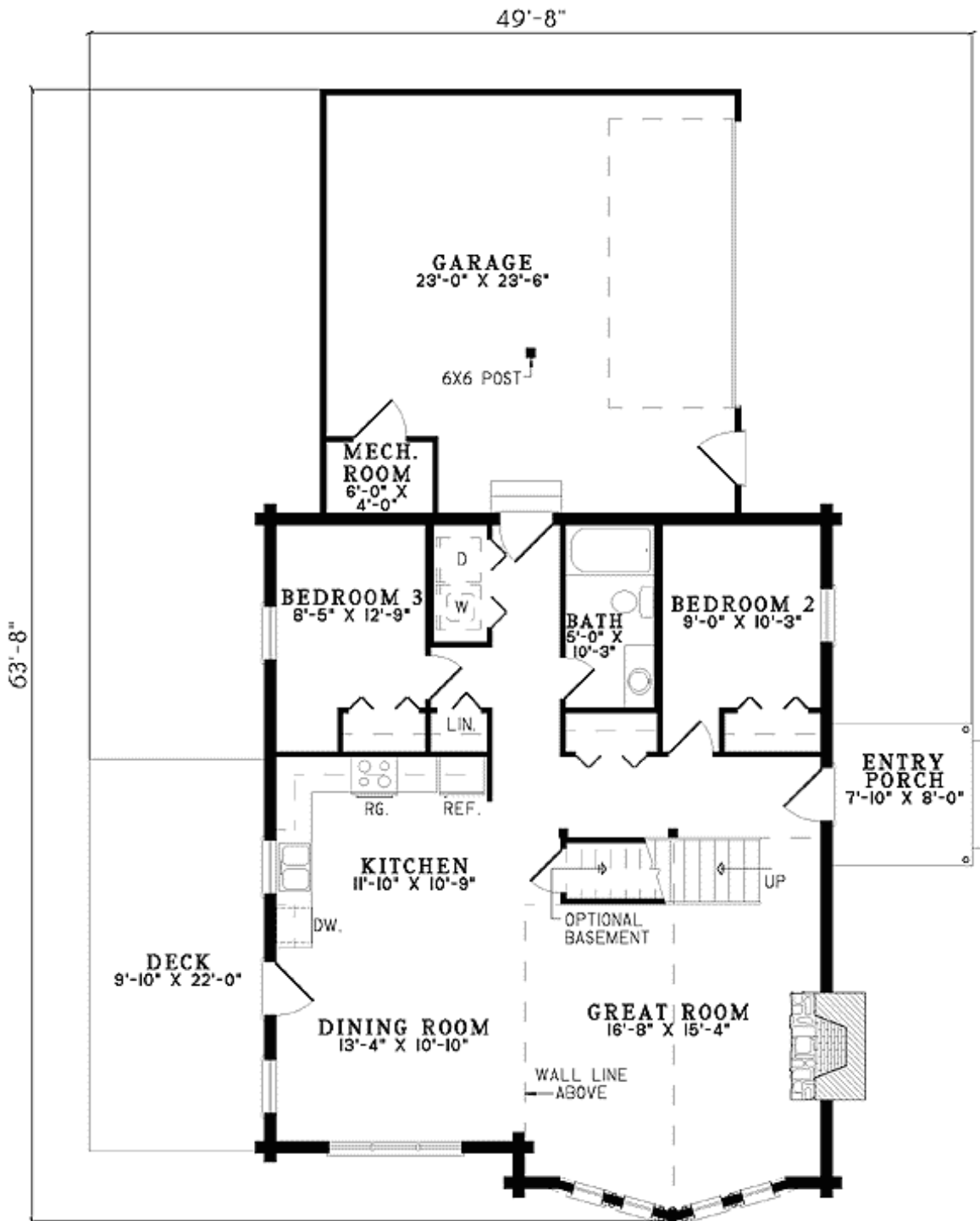

2nd Level

