

Architectural Designs ...selling quality house plans for over 30 years.

Plan W57098HA: Cottage with Screened Porch, Garage and Shop



House plans are Copyright © 2009 by our architects and designers.

- Integrated open and screened front porches guarantee comfortable summer enjoyment.
- Oversized garage includes area for shop and miscellaneous storage.
- U-shaped kitchen and breakfast area is adjacent to vaulted living room and has access to screened porch through sliding glass doors.
- 345 square feet of optional living area on the lower level including a third bedroom and a bath.
-

Style: Country, Traditional

Total Living Area: 1072

Main Flr.: 1072

Basement Unfinished: 1,072 sq. ft.

Total Square Feet: 2,715 sq. ft.

Attached Garage: 2 Car, 571 sq. ft.

Bedrooms: 2

Full Bathrooms: 2

Width: 52'

Depth: 40'

Maximum Ridge Height: 22'

Exterior Walls: 2x4

Ceiling Height:

Main Floor: 9'

2nd Floor: 0

Other: Vaulted MBR

Standard Foundations: Basement

Special Features: CAD Available, PDF, Corner Lot, 1st Floor Master Suite

One Set	Five Sets	Eight Sets	Reproducible	PDF File	CAD
\$410	\$510	\$610	\$695	\$695	\$1,250

Main Level

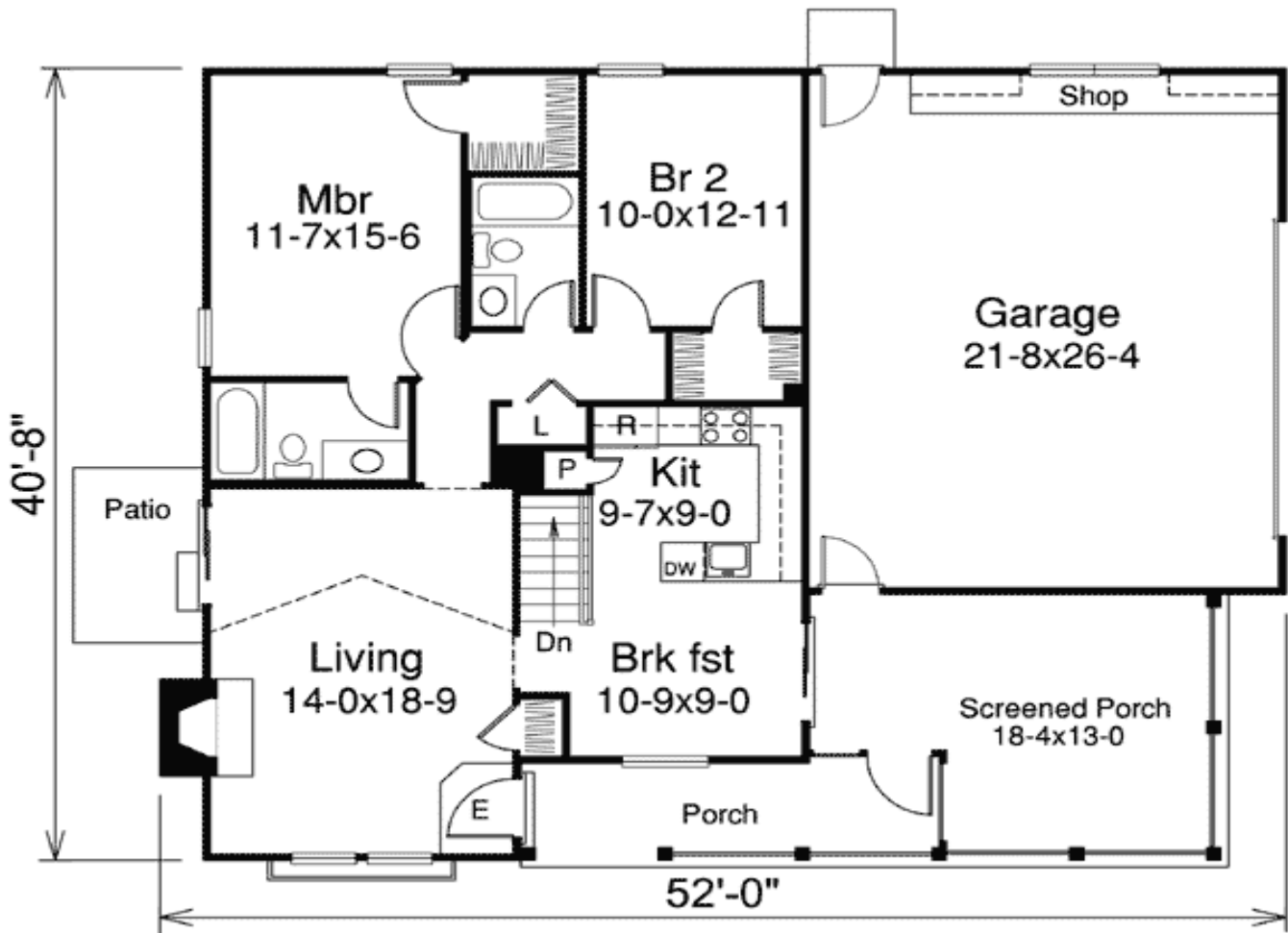

Lower Level

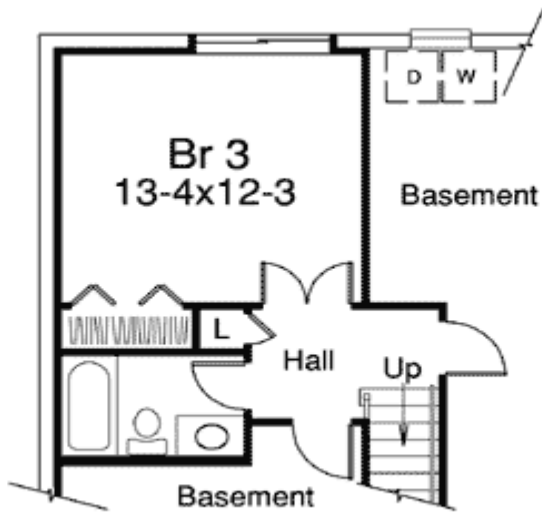

Sides/Rear

