

Architectural Designs ...selling quality house plans for over 30 years.

Plan W9105GU: Decks and Porches



House plans are Copyright © 2009 by our architects and designers.

- With decks and porches to enjoy the cool breezes, this coastal Southern home plan is a true delight.
- A T-shaped staircase catches your eye right away.
- Inside, an open floor plan allows for great traffic flow and beautiful views. Lots of windows bring in the light while a warm fireplace makes for a cozy feel.
- The kitchen features both an island and a breakfast bar for quick meals. The formal dining room lies close by for convenience.
- The master suite can be found on the first floor with two walk-in closets and a large bath with double sinks and a whirlpool tub.
- A bridge connects the two bedrooms on the upper level and offers views into both the foyer and the great room below.
- Ceilings: 9' first floor; 8' second floor.

Style: Low Country, Southern

Total Living Area: 2237

Main Flr.: 1656

2nd Flr.: 581

Front Porch: 322 sq. ft.

Deck: 240 sq. ft.

Total Square Feet: 4,455 sq. ft.

Attached Garage: 3 Car, 1,656 sq. ft.

Bedrooms: 3

Full Bathrooms: 2

Half Bathrooms: 1

Width: 46'

Depth: 55'

Maximum Ridge Height: 32'3"

Exterior Walls: 2x4

Ceiling Height:

Main Floor: 9'

2nd Floor: 8'

Standard Foundations: Slab

Special Features: CAD Available, 1st Floor Master Suite, Narrow Lot

One Set	Five Sets	Eight Sets	CAD
\$700	\$800	\$875	\$1,400

Main Level

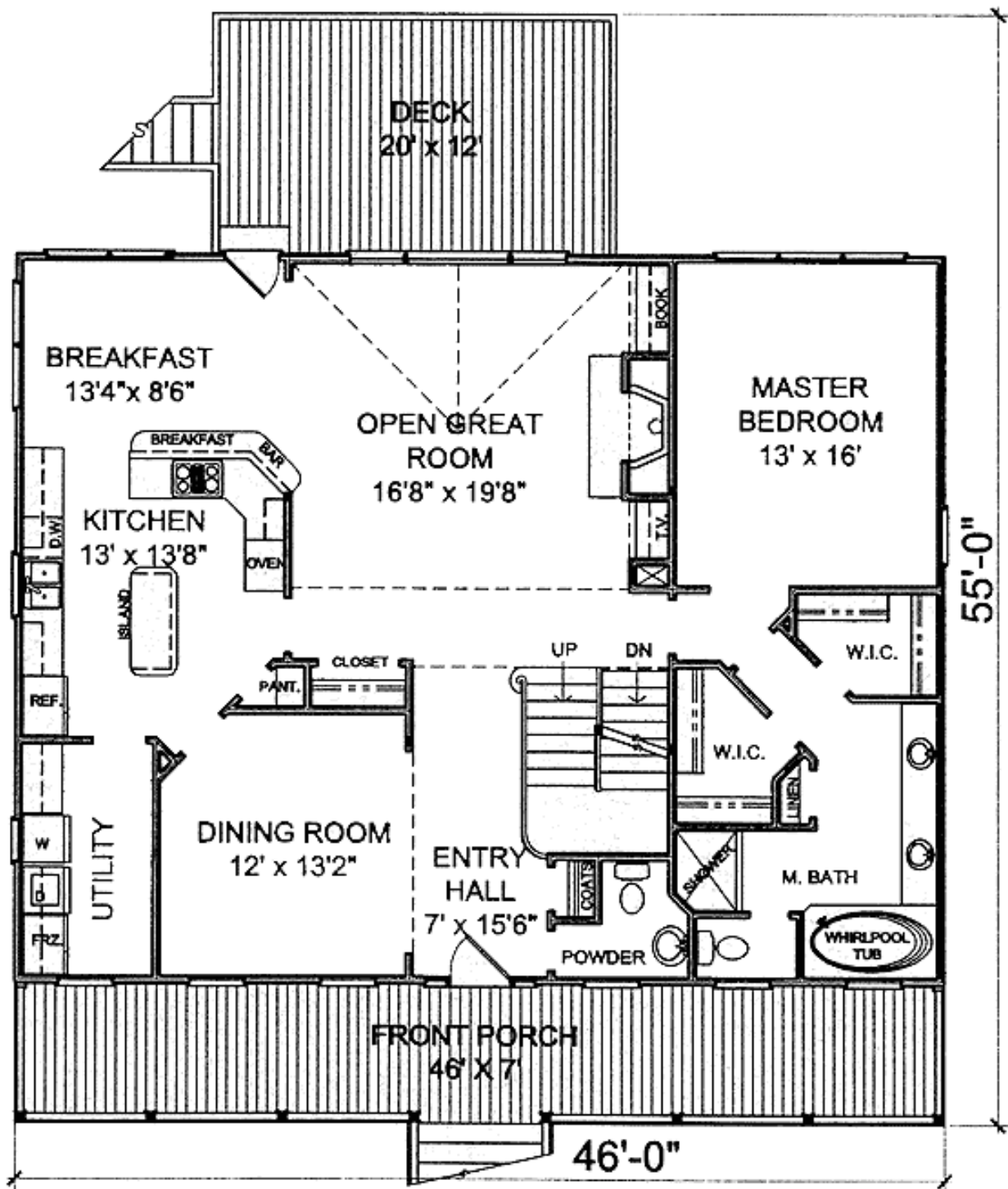

2nd Level

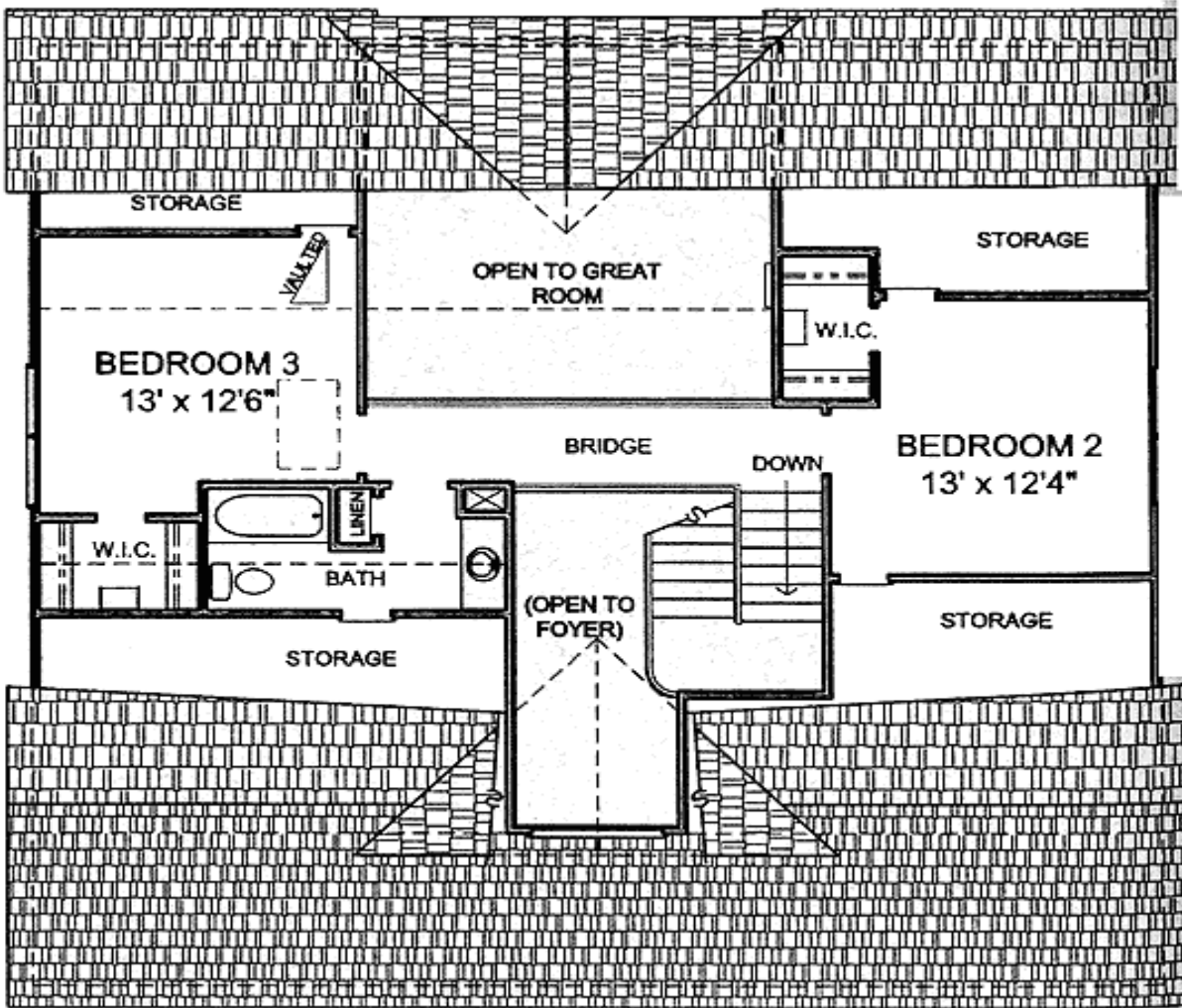

Lower Level

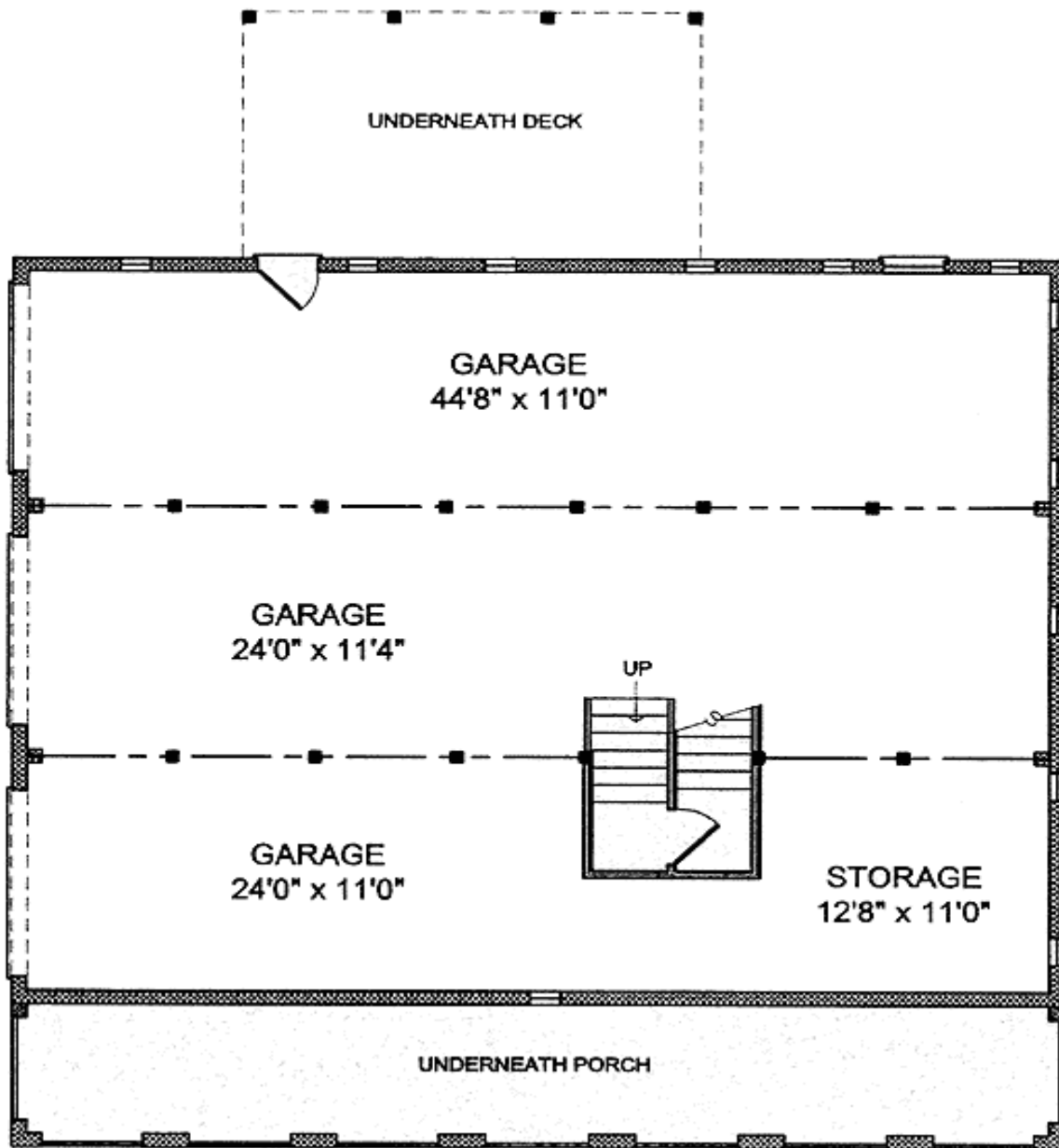

Rear View

