

Plan W2238SL: RV Garage Plan



House plans are Copyright © 2009 by our architects and designers.

- Front facing gables accent this RV garage with attached two-car garage.
- A 12'x14' door and a 16' ceiling accommodates an RV or motor home.
- A convenient pass-thru leads to the two-car garage featuring a 16'x8' overhead door and a 9' ceiling.
- Interior stairs lead to the second level loft, perfect for storage, and flexible to suite your needs.

Style: Garage

Total Living Area: 0

Storage: 413 sq. ft.

Total Square Feet: 1,494 sq. ft.

Detached Garage: 3 Car, 1,588 sq. ft.

Bedrooms: None

Full Bathrooms:

Width: 44'

Depth: 40'

Maximum Ridge Height: 25'

Exterior Walls: 2x6

Ceiling Height:

Main Floor: 9'

2nd Floor: 8'

Other: 16' RV Garage

Standard Foundations: Slab

Special Features: Narrow Lot, CAD Available, PDF

One Set	Five Sets	Eight Sets	Reproducible	PDF File	CAD
\$150	\$240	\$330	\$350	\$350	\$450

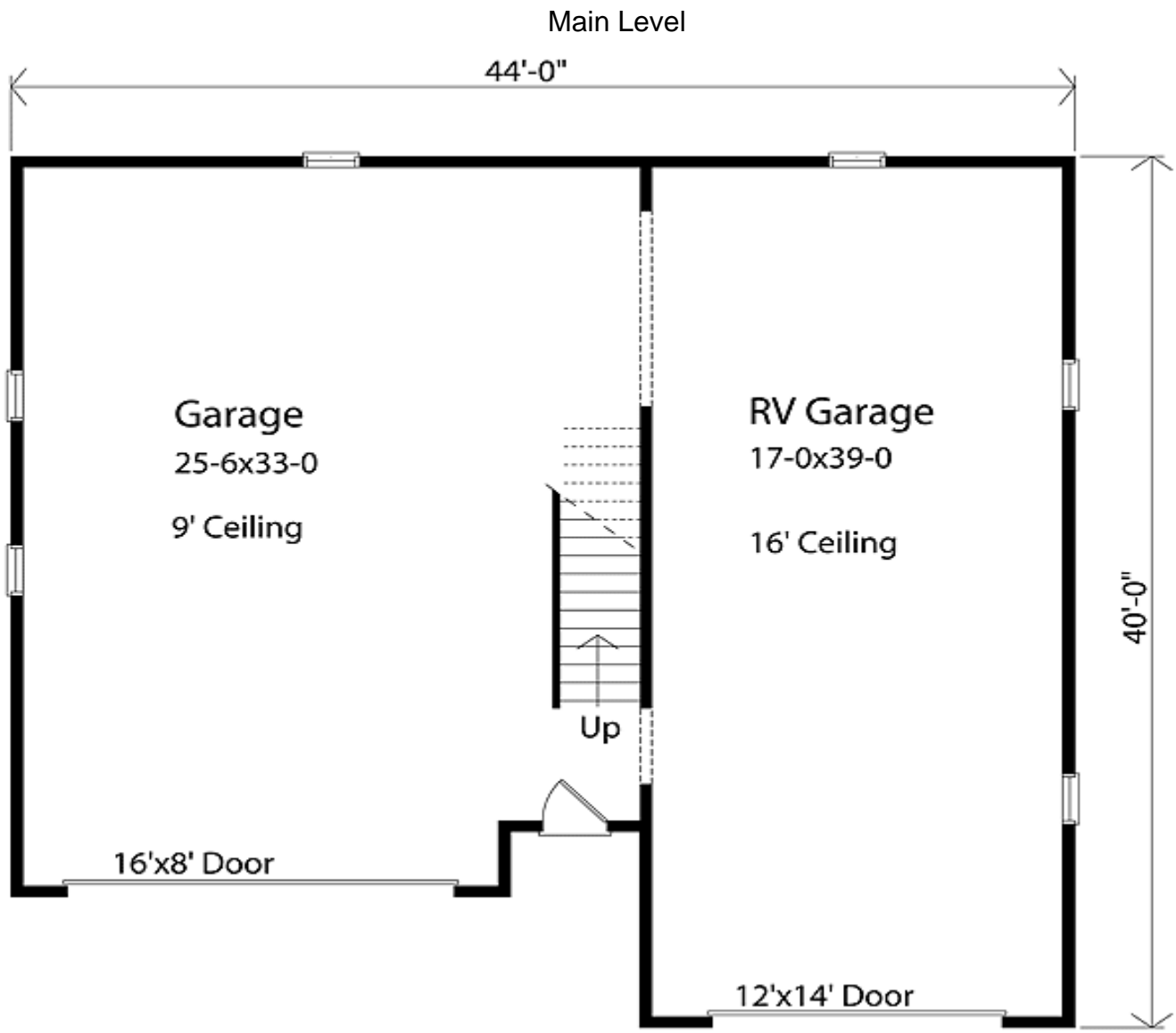

2nd Level

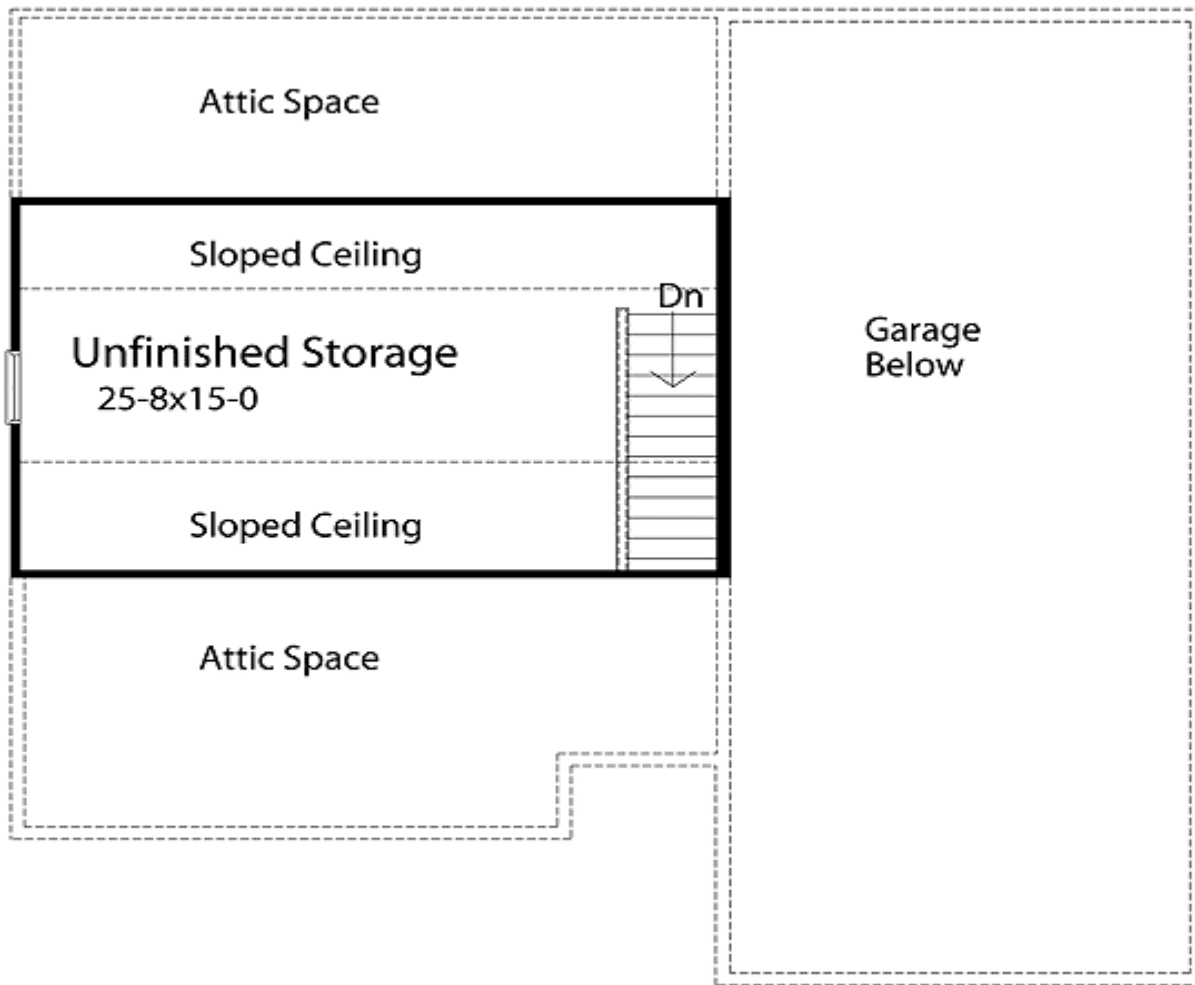

Sides/Rear



Rear elevation



Left elevation



Right elevation