

## Plan W81366W: Centerpiece Sunken Gathering Room



House plans are Copyright © 2009 by our architects and designers.

- Loaded with custom features, this house plan is designed to delight the imagination. The foyer enters directly into the commanding sunken gathering room. Framed by an elegant railing, this centerpiece for entertaining is open to both the study and the formal dining room, and offers sliding glass doors to the terrace.
- A full bar further extends the entertaining possibilities of this room.
- The country-style kitchen contains an efficient work area, as well as a morning room and sitting area--ideal for family gatherings around the cozy fireplace.
- The grand master suite has a private terrace, fireplace alcove with built-in seats and a huge spa-style bath.

Style: Florida, Luxury, Mediterranean, Premium Collection, Southwest

Total Living Area: 3505

Main Flr.: 3505

Total Square Feet: 4,294 sq. ft.

Attached Garage: 3 Car, 789 sq. ft.

Bedrooms: 3

Full Bathrooms: 2

Half Bathrooms: 1

Width: 110'7"

Depth: 66'11"

Maximum Ridge Height: 20'

Exterior Walls: 2x6

Ceiling Height:

Standard Foundations: Slab

Special Features: Butler Walk-in Pantry, Unusual Shape, 1st Floor Master Suite, Photo Gallery, MBR Sitting Area, PDF

One Set  
\$785

Five Sets  
\$845

Eight Sets  
\$910

Reproducible  
\$1,145

PDF File  
\$1,145

## Main Level

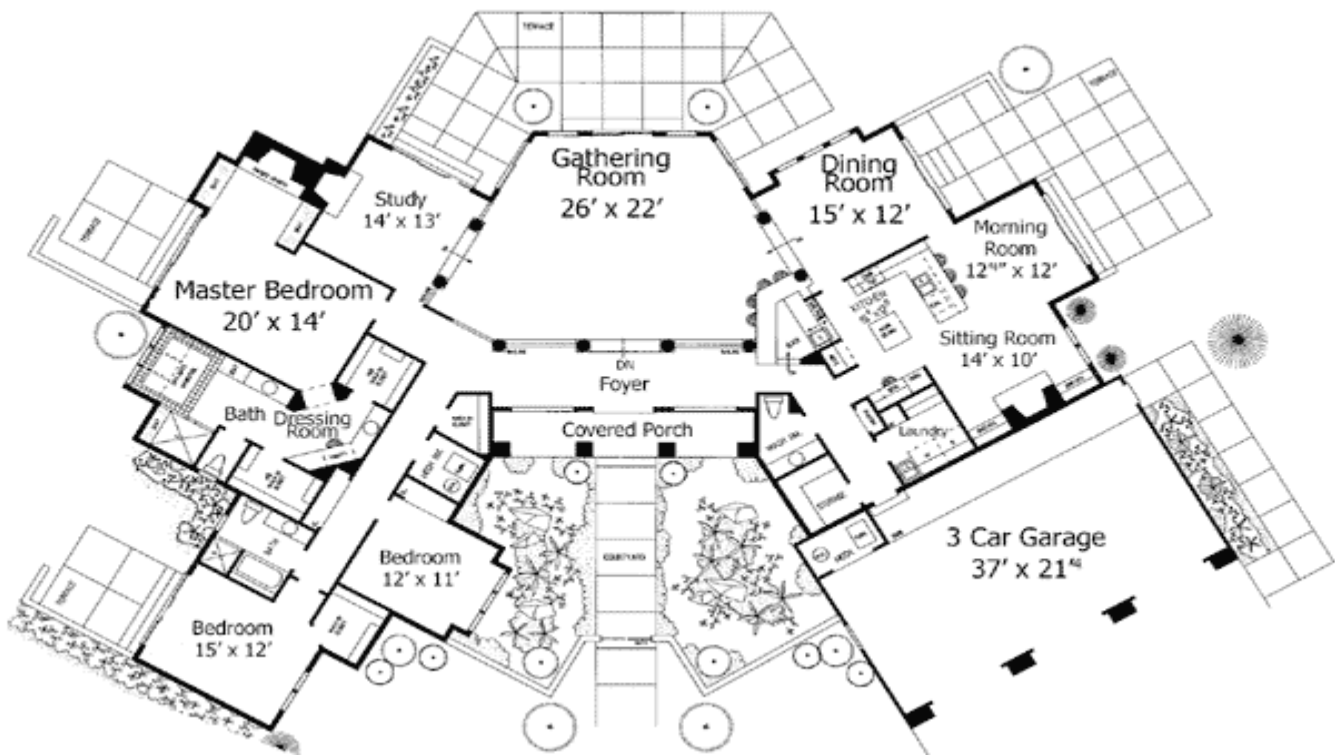

Elevation #2



Entry/Foyer



Great Room



Kitchen

