

# Architectural Designs ...selling quality house plans for over 30 years.

Plan W63112HD: Exquisite Frank Lloyd Wright-Style House Plan



House plans are Copyright © 2009 by our architects and designers.

- Living/dining spaces embrace each other to share spectacular view of pool.
- Master suite with raised sitting area complete with bar shares view of the rear yard as does the architectural bed wall capped by a triple stepped ceiling treatment, and a mitered bow window.
- The master bath is lavish, and is split with private vanities, and huge walk in closets.

Style: Contemporary

Total Living Area: 3200

Main Flr.: 2531

2nd Flr.: 669

Total Square Feet: 3,856 sq. ft.

Attached Garage: 2 Car, 656 sq. ft.

Bedrooms: 4

Full Bathrooms: 4

Width: 82'4"

Depth: 70'

Maximum Ridge Height: 26'10"

Exterior Walls: 2x4

Ceiling Height:

Standard Foundations: Slab

Special Features: CAD Available, PDF

|         |           |            |              |          |         |
|---------|-----------|------------|--------------|----------|---------|
| One Set | Five Sets | Eight Sets | Reproducible | PDF File | CAD     |
| \$735   | \$775     | \$825      | \$915        | \$915    | \$1,830 |

## Main Level

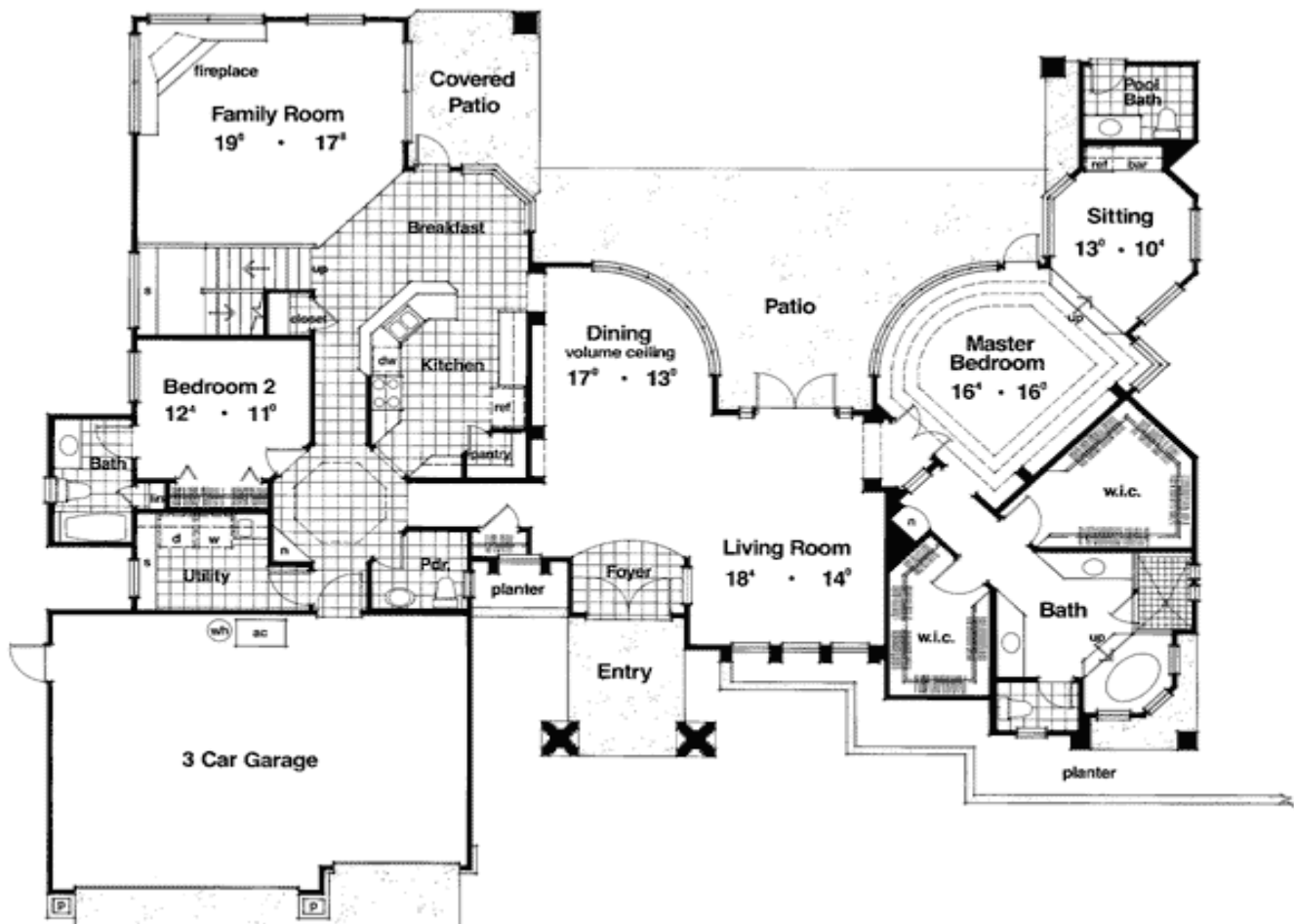

## 2nd Level

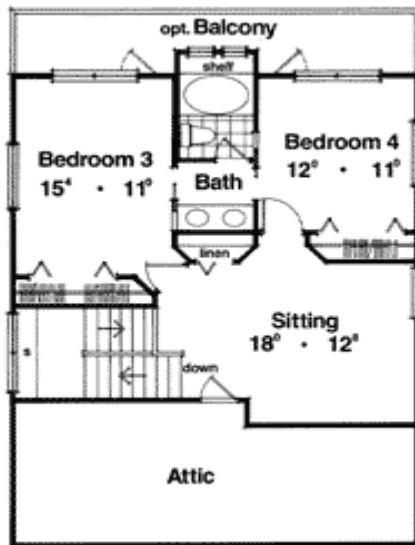

# Architectural Designs ...selling quality house plans for over 30 years.

Photo



Rear View

