

Architectural Designs ...selling quality house plans for over 30 years.

Plan W1920GT: Flexible Turn-of-the Century Design



House plans are Copyright © 2009 by our architects and designers.

- This classic Queen Anne-style cottage, with its wide wrap-around porch and expansive windows, can take advantage of a building site that offers views in every direction. Also, the detached two-car garage can be relocated to adapt to an extremely narrow lot.
- Inside, nine-foot ceilings are found throughout. The kitchen overlooks both the living and dining areas. The bayed-out living area features a fireplace, while the dining area opens to the porch with French doors. The powder room is located for convenient access from the outside as well as the inside.
- In the rear, the spacious master suite includes a huge compartmented bath with walk-in closet, twin sinks, garden tub and separate shower.
- The sunroom upstairs is reminiscent of the cozy sleeping porches found in many turn-of-the-century homes. The two upstairs bedrooms, one bayed like the living room below and the other with a walk-in closet, share the hall bath.
- Foundation: slab.

Style: Cottage, Country

Total Living Area: 1832

Main Flr.: 1141

2nd Flr.: 691

Deck: 348 sq. ft.

Total Square Feet: 2,660 sq. ft.

Detached Garage: 2 Car, 480 sq. ft.

Bedrooms: 3

Full Bathrooms: 2

Half Bathrooms: 1

Width: 32'6"

Depth: 51'10"

Maximum Ridge Height: 33'

Exterior Walls: 2x4

Ceiling Height:

Main Floor: 9'

2nd Floor: 9'

Standard Foundations: Slab

Special Features: 1st Floor Master Suite, Narrow Lot, PDF, Wrap Around Porch

Five Sets
\$549

Eight Sets
\$599

Reproducible
\$774

PDF File
\$774

Main Level

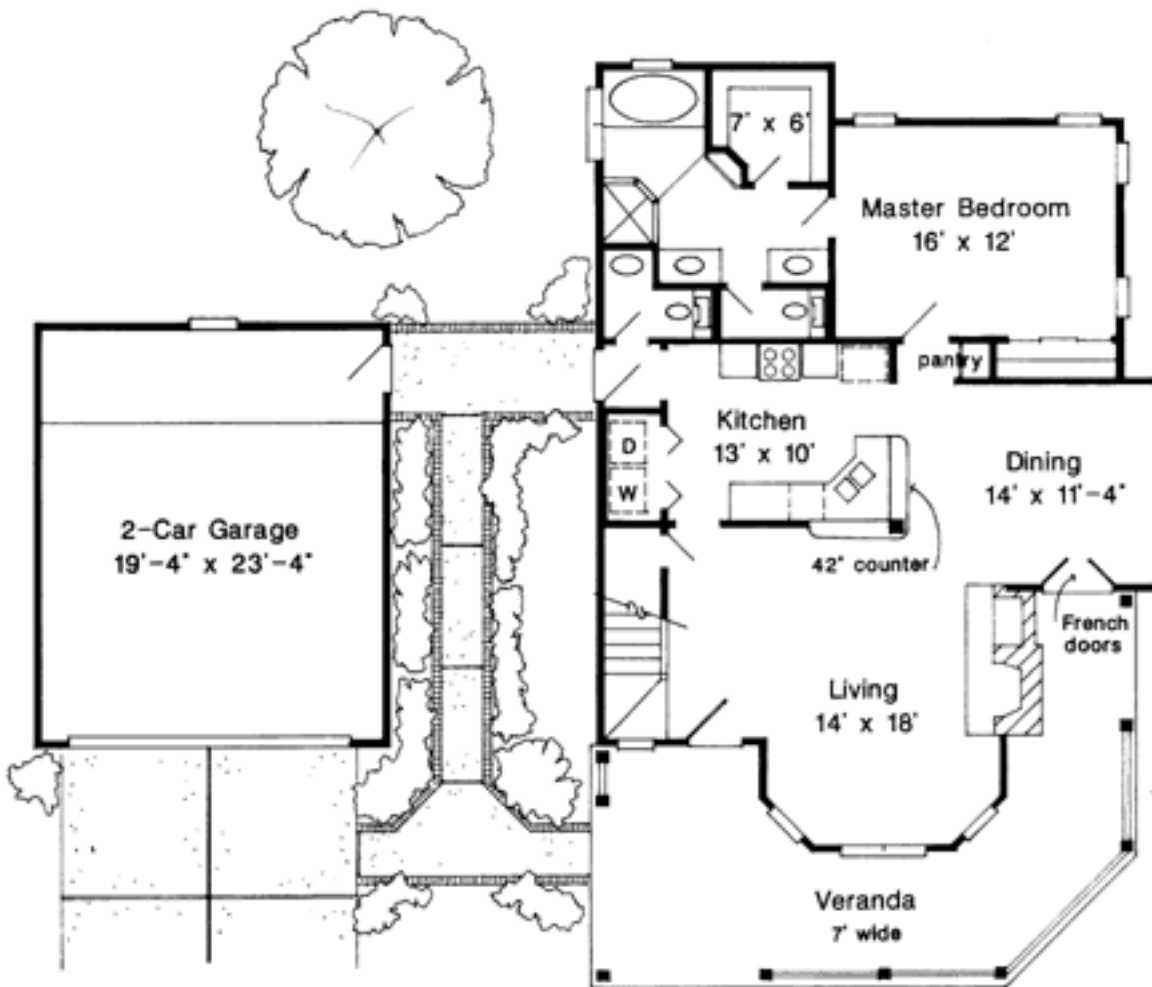

2nd Level

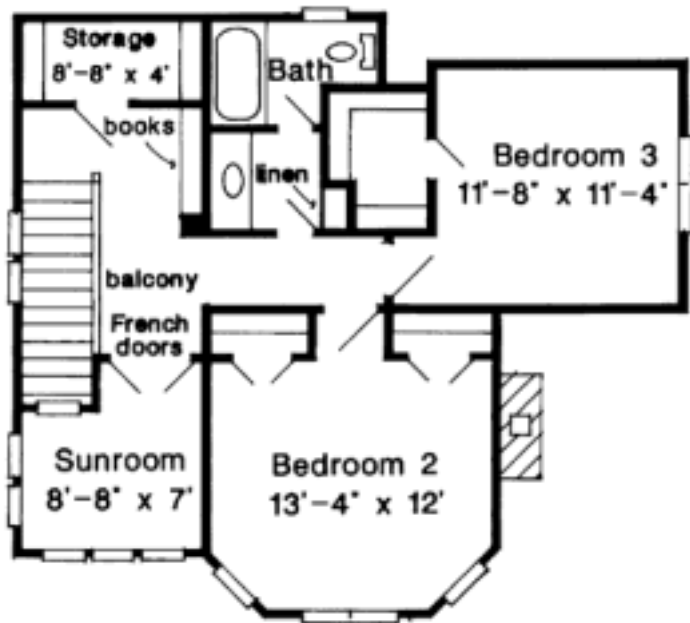

Sides/Rear

