

Architectural Designs ...selling quality house plans for over 30 years.

Plan W9554DM: Customizable Cape Cod Classic



House plans are Copyright © 2009 by our architects and designers.

- An endearing and enduring American original design, this Cape Cod classic. This symmetrical 1' story home plan carries clean design to the interior with an open floor plan for convenience and a modern flow.
- A center hall entry, lit from above by a dormer window, opens to the flanking formal living and dining rooms and continues on to a generous family area.
- The kitchen enjoys views of the rear yard and opens to a large breakfast nook and Family room creating an extended family area.
- The master suite features a walk-in closet, a large master bath with dual sinks, and separate shower and tub.
- This customizable Cape Cod classic house plan is easy to build, heat, and maintain which makes it an elegantly practical choice.

Style: Cape Cod, Traditional

Total Living Area: 2483

Main Flr.: 1302

2nd Flr.: 1181

Basement Unfinished: 1,302 sq. ft.

Deck: 200 sq. ft.

Entry: 45 sq. ft.

Total Square Feet: 4,503 sq. ft.

Attached Garage: 2 Car, 473 sq. ft.

Bedrooms: 3

Full Bathrooms: 2

Half Bathrooms: 1

Width: 62'

Depth: 58'

Maximum Ridge Height: 28'9"

Exterior Walls: 2x6

Ceiling Height:

Main Floor: 8'1

2nd Floor: 8'1

Standard Foundations: Slab, Basement, Crawl

Alternate Foundations: Basement (\$100)

Special Features: Bonus Room

One Set
\$649

Five Sets
\$729

Eight Sets
\$789

Reproducible
\$838

Main Level

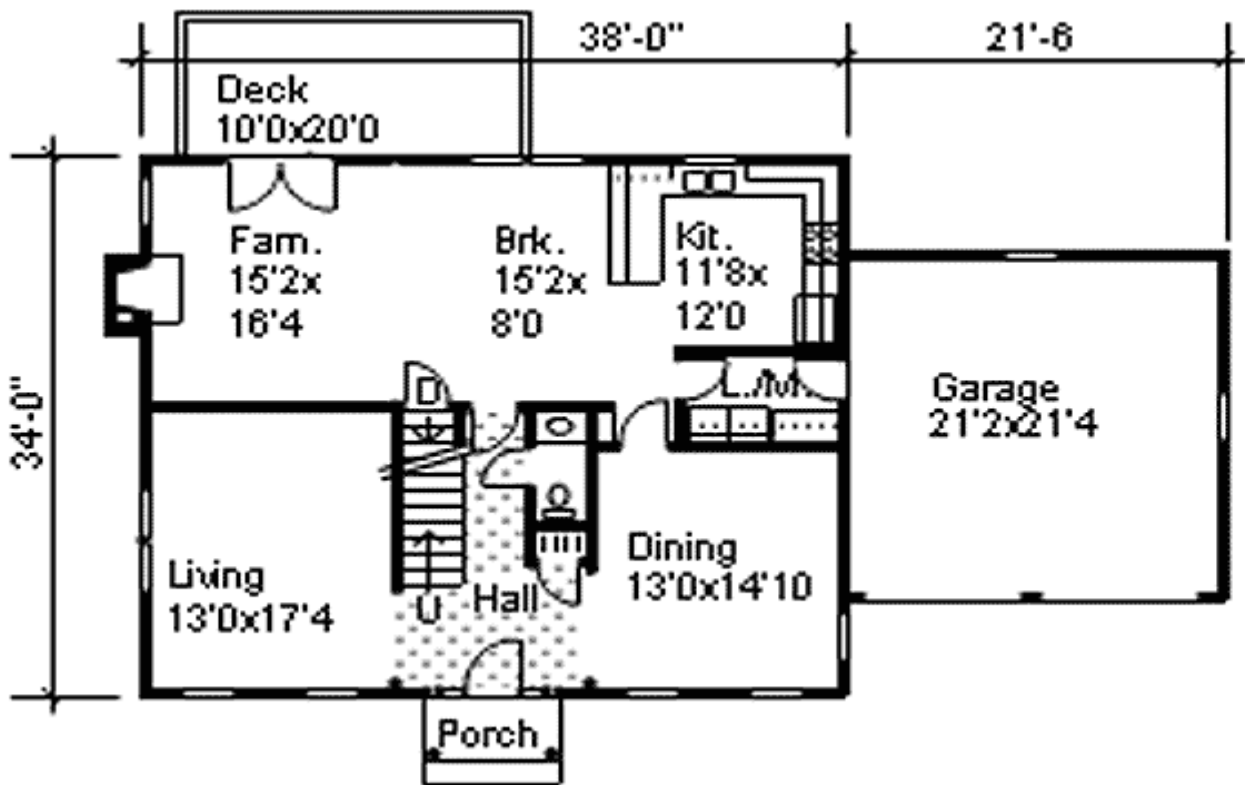

2nd Level

