

Architectural Designs ...selling quality house plans for over 30 years.

Plan W31026D



House plans are Copyright © 2009 by our architects and designers.

Style: Country, Vacation

Total Living Area: 1710

Main Flr.: 1710

Basement Unfinished: 1,710 sq. ft.

Bonus: 1,130 sq. ft.

Front Porch: 363 sq. ft.

Covered Patio: 215 sq. ft.

Attic: 130 sq. ft.

Total Square Feet: 5,258 sq. ft.

Bedrooms: 3

Full Bathrooms: 2

Width: 56'

Depth: 41'4"

Maximum Ridge Height: 23'

Exterior Walls: 2x4

Ceiling Height:

Main Floor: 9'

Standard Foundations: Slab, Basement, Crawl

Special Features: CAD Available, Bonus Room, 1st Floor Master Suite, Butler Walk-in Pantry, Split Bedrooms

One Set	Five Sets	Eight Sets	Reproducible	CAD
\$510	\$565	\$620	\$795	\$1,765

Main Level

56' 0"

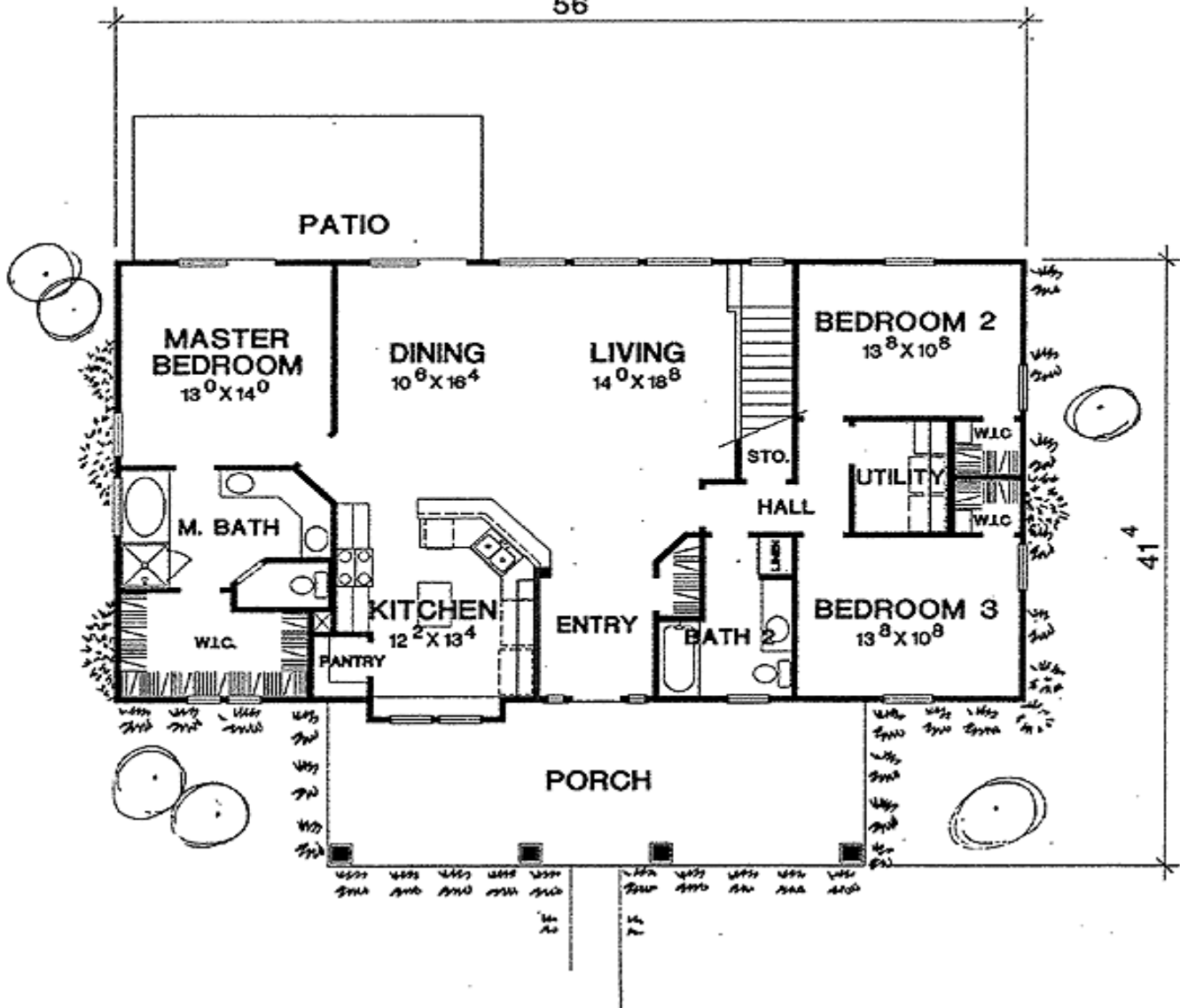

Bonus

