

Plan W80249PM: Victorian Charmer



House plans are Copyright © 2009 by our architects and designers.

- This charming Victorian house plan is perfect for the narrow lot. The exterior is graced by an angular porch matching the octagonal living room inside.
- A coat closet in the entry helps reduce clutter. Step further in and you'll be drawn to the octagonal living room a step up from the rest of the main floor.
- The kitchen has seating at the counter and is open to the dining room. A half bath and laundry are tucked away discreetly on the main floor.
- The master bedroom is something to behold and matches the octagonal form below. It features a large walk-in closet. Two more bedrooms and a bath complete the home plan.
- The basement holds expansion possibilities.
- Related Plan: Get an attached garage with house plan 80240PM.

Style: Canadian, Metric, Victorian

Total Living Area: 1396

Main Flr.: 698

2nd Flr.: 698

Total Square Feet: 1,396 sq. ft.

Bedrooms: 3

Full Bathrooms: 1

Half Bathrooms: 1

Width: 22'

Depth: 36'

Maximum Ridge Height: 37'5"

Exterior Walls: 2x6

Ceiling Height:

Main Floor: 8'

2nd Floor: 8'

Standard Foundations: Basement

Special Features: PDF, Narrow Lot, CAD Available

One Set	Five Sets	Eight Sets	Reproducible	PDF File	CAD
\$550	\$645	\$655	\$850	\$850	\$1,290

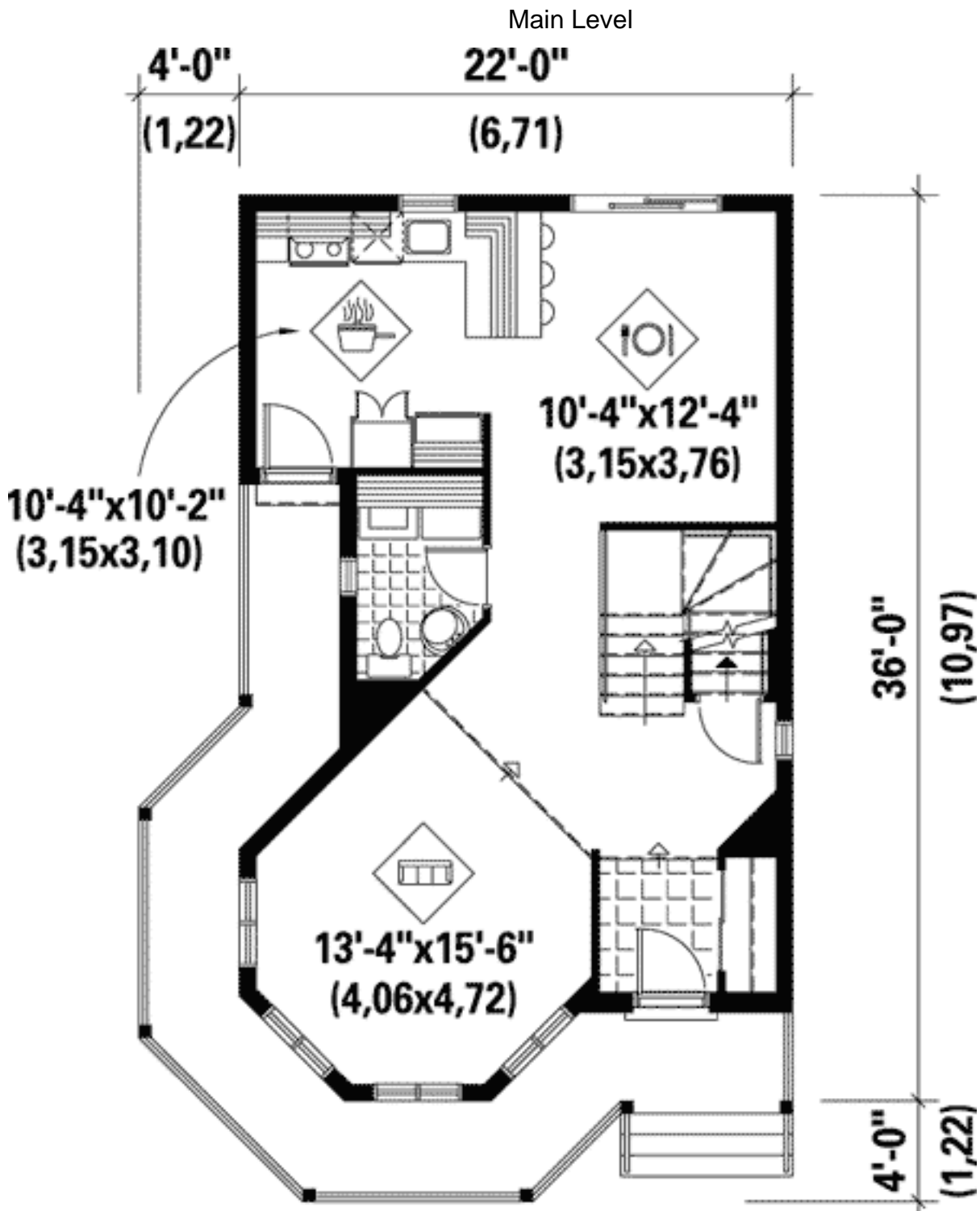

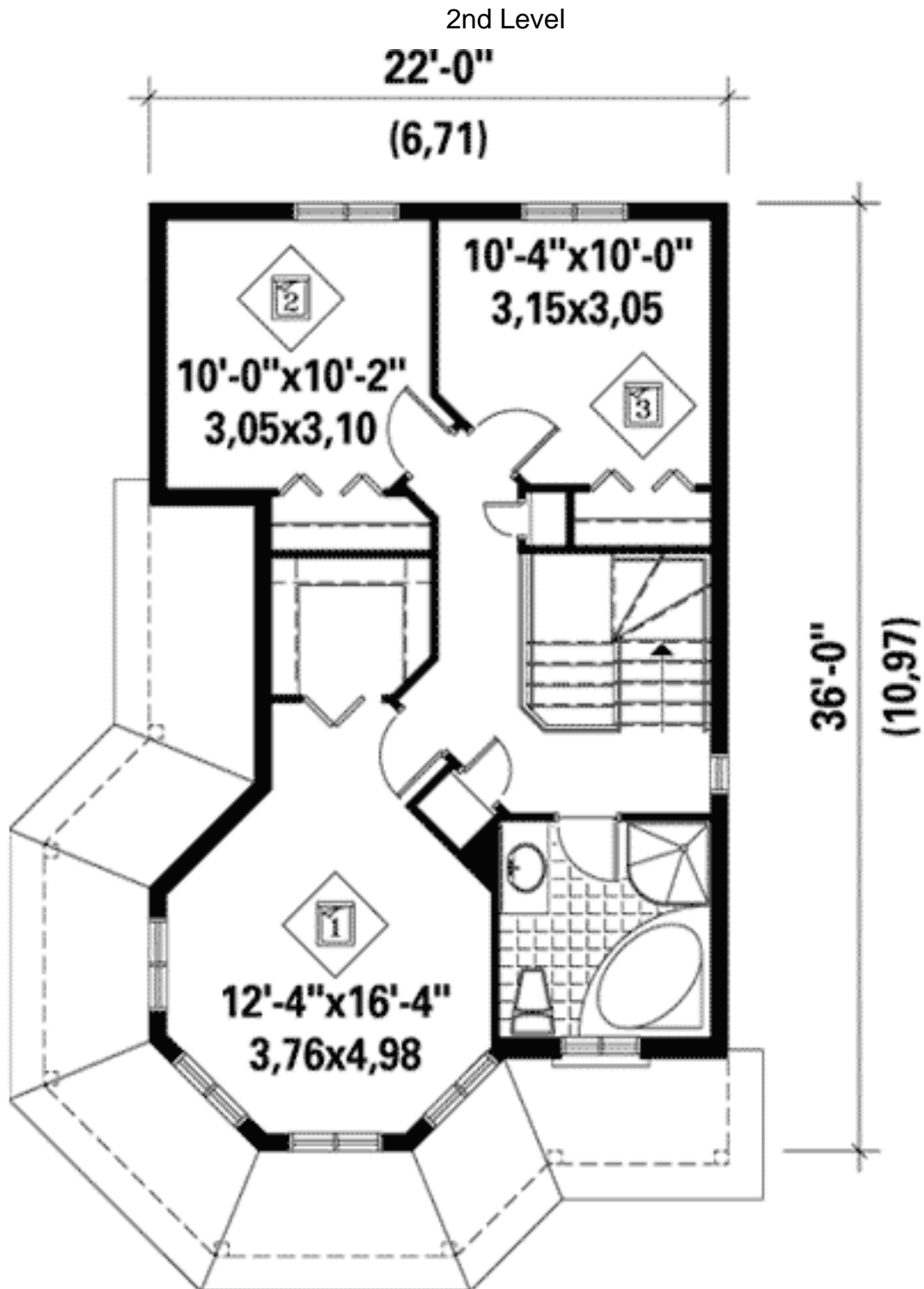

Sides/Rear

