

Architectural Designs ...selling quality house plans for over 30 years.

Plan W11093G: Expandable Home for the Growing Family



House plans are Copyright © 2009 by our architects and designers.

- An efficient kitchen adjoins the dining room that has sliders to the patio.
- The extra-large living room gives a wide-open feeling to all who enter.
- Two bedrooms and a full bath complete the first floor.
- On the second floor, you'll find the spacious master suite with a room-sized walk-in closet and master bath. The other bedroom and full bath can be used to accommodate visiting guests.
- This house plan is available with a slab, crawl or basement foundation option. Please specify when ordering.

Style: Cape Cod

Total Living Area: 1757

Main Flr.: 957

2nd Flr.: 800

Total Square Feet: 1,757 sq. ft.

Bedrooms: 4

Full Bathrooms: 3

Width: 40'

Depth: 24'

Maximum Ridge Height: 25'

Exterior Walls: 2x4

Ceiling Height:

Standard Foundations: Slab, Basement, Crawl

Special Features: PDF, Narrow Lot

One Set	Five Sets	Eight Sets	Reproducible	PDF File	CAD
\$525	\$605	\$635	\$775	\$775	\$1,225

Main Level

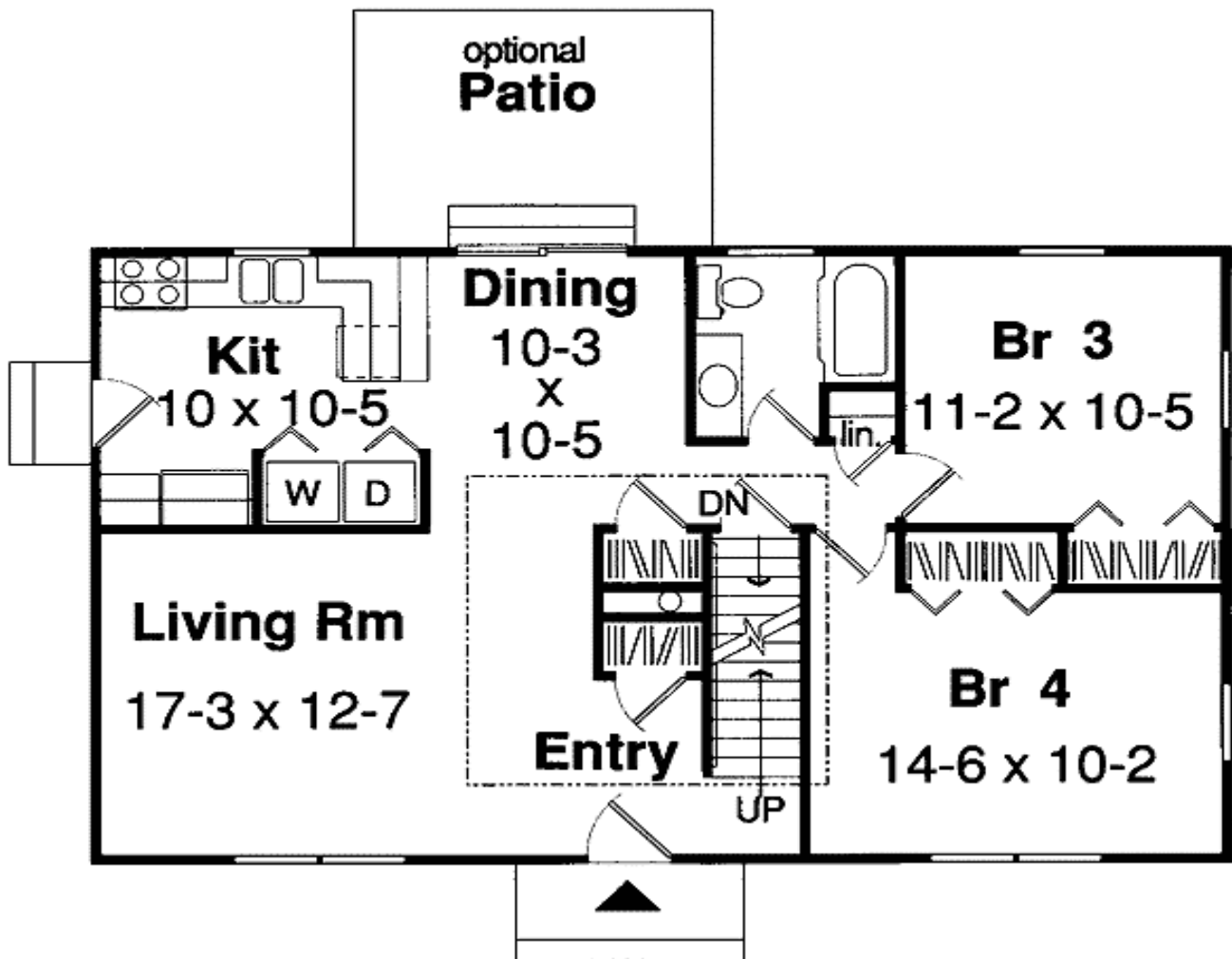

2nd Level

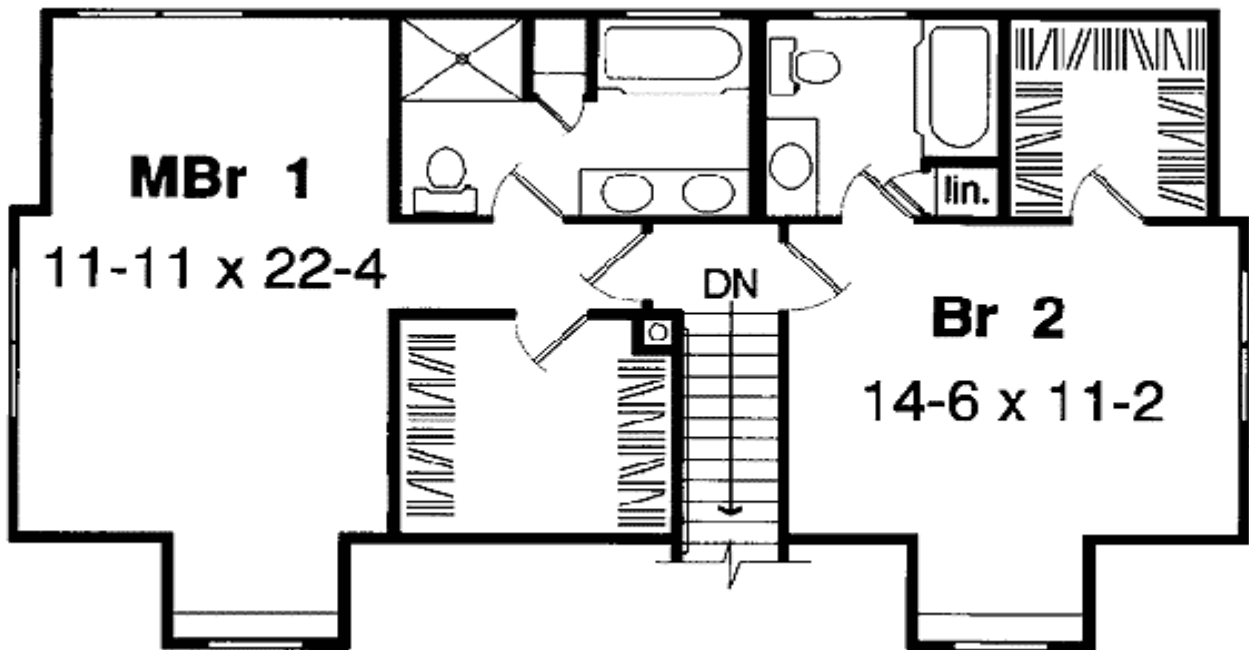

Optional

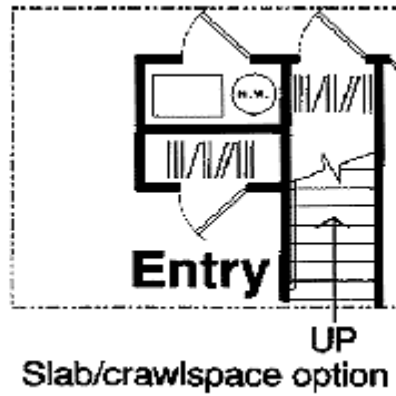

Rear View

