

Architectural Designs ...selling quality house plans for over 30 years.

Plan W3824JA: Classical Ranch



House plans are Copyright © 2009 by our architects and designers.

- Designed with formal references, such as its brick facade and hipped rooflines, this ranch offers an adaptable layout. With minor modifications, the home can be built to meet the needs of a wheelchair-bound person.
- Interesting ceiling treatments, including a 14-foot-high foyer, 10'14"-high stepped ceilings in the dining room and the great room, and vaulted ceilings in the breakfast room and two bedrooms, provide a sense of space and light. Nine-foot ceilings are standard in the other rooms.
- Interior columns delineate the dining room. In the adjacent great room, a fireplace and built-ins are placed side by side. Open to the great room, the kitchen features an angled eating counter. Also note the handy server. Light floods the breakfast room through a bay window.
- In the sleeping wing, a bay window in the master suite makes a wonderful sitting area. There are two linear closets in the master bedroom, plus a walk-in closet in the five-fixture master bath. The secondary bedrooms share a hall bath.
- Wheelchair-Adaptable
- Foundation options: basement, slab or crawl space.

Style: Ranch, Traditional

Total Living Area: 1595

Main Flr.: 1595

Total Square Feet: 2,143 sq. ft.

Attached Garage: 2 Car, 548 sq. ft.

Bedrooms: 3

Full Bathrooms: 2

Width: 70'

Depth: 37'4"

Maximum Ridge Height: 22'

Exterior Walls: 2x4

Ceiling Height:

Main Floor: 9'

Other: 10'9" Vaulted MBR; 14' Step Dining Room; 10'4" Step Great Room; 14' Foyer; Vaulted Breakfast & BR#3"

Standard Foundations: Slab, Basement, Crawl

Special Features: PDF, Photo Gallery, CAD Available, 1st Floor Master Suite

Five Sets
\$545

Eight Sets
\$580

Reproducible
\$695

PDF File
\$695

CAD
\$1,195

Main Level

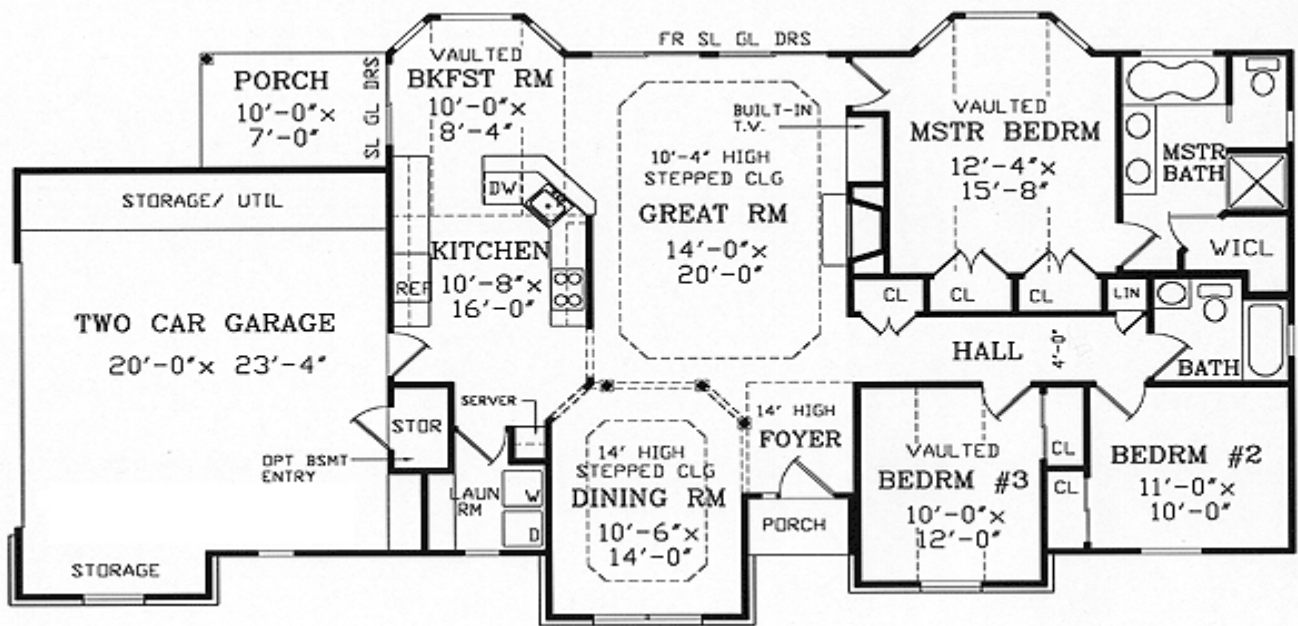

Photo



Rear View



Interior



Interior Vw2



Dining Room

