

Plan W5366Q: Classic Getaway



House plans are Copyright © 2009 by our architects and designers.

- This classic getaway home plan offers all the comforts of home.
- An expansive deck wraps around the dramatic great room providing extra space for entertaining or relaxation.
- A large two-story fireplace dominates the great room.
- A viewing loft looks over the main space and enjoys the same views afforded below.

Style: Contemporary, Vacation

Total Living Area: 1932

Main Flr.: 1129

2nd Flr.: 803

Basement Unfinished: 1,129 sq. ft.

Total Square Feet: 1,932 sq. ft.

Attached Garage: 2 Car, 400 sq. ft.

Bedrooms: 3

Full Bathrooms: 3

Half Bathrooms: 1

Width: 46'

Depth: 56'

Maximum Ridge Height: 33'

Exterior Walls: 2x6

Ceiling Height:

Standard Foundations: Basement, Crawl

Special Features: Narrow Lot

One Set
\$450

Five Sets
\$505

Eight Sets
\$550

Reproducible
\$670

Main Level

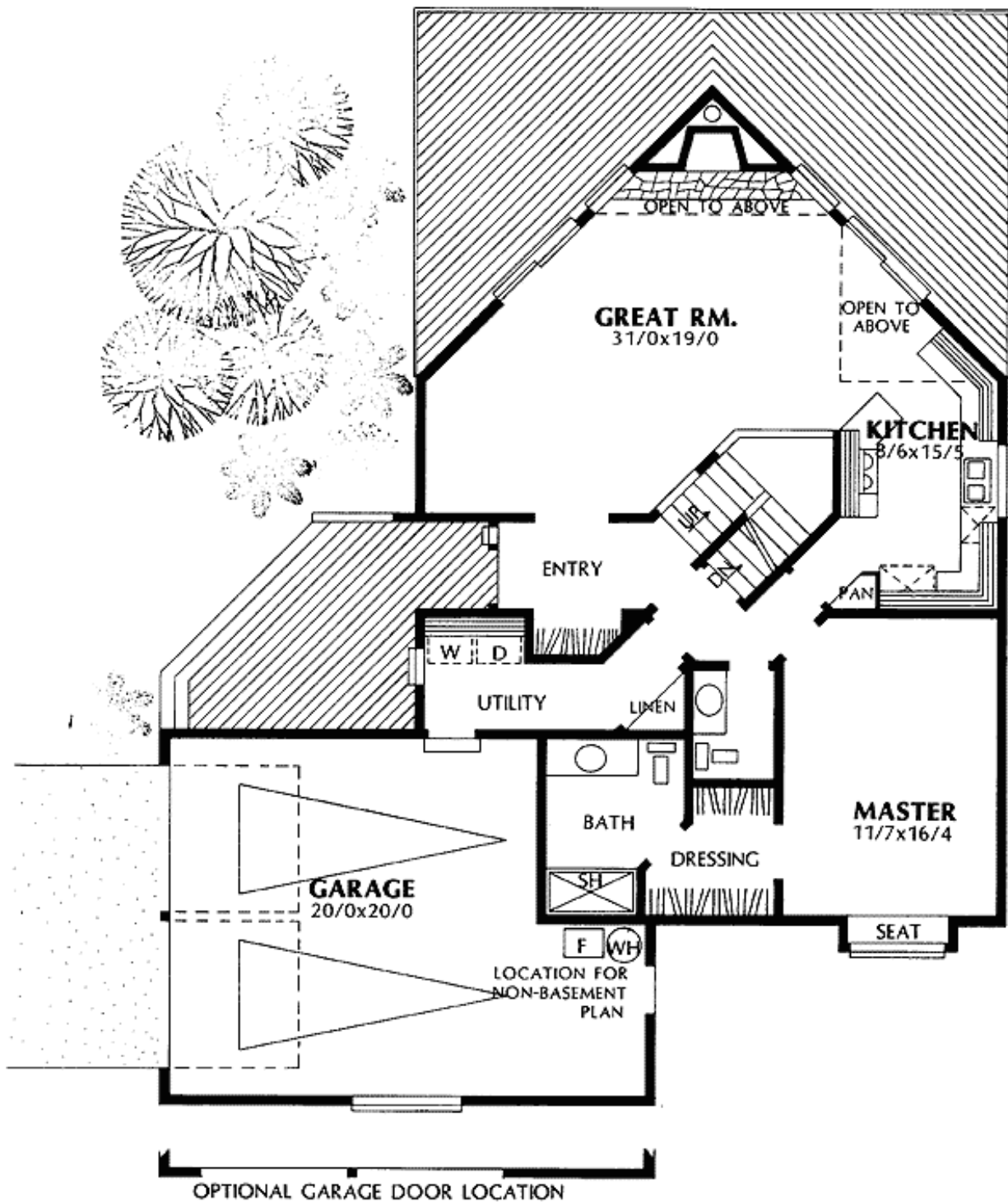

2nd Level

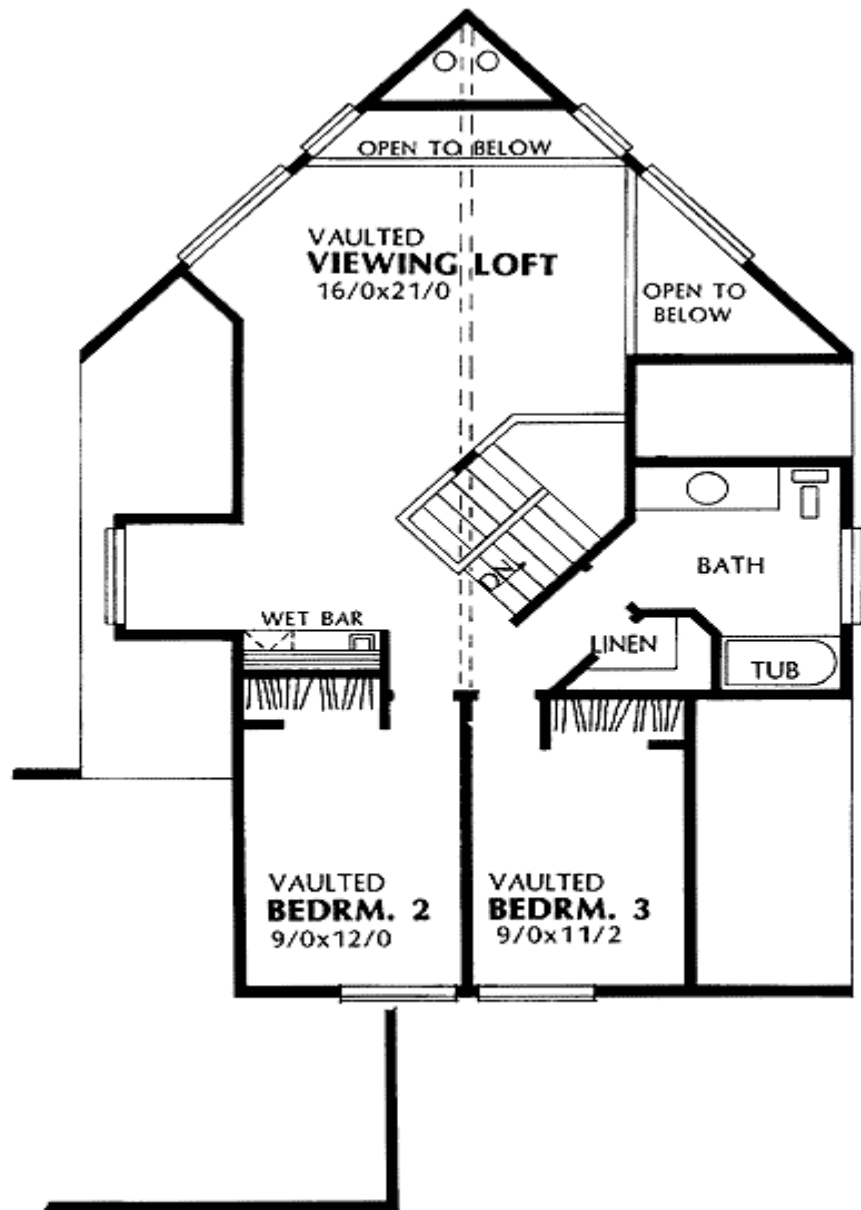

Lower Level

