

Plan W14334RK: Vaulted Sunroom and Open Family Room



House plans are Copyright © 2009 by our architects and designers.

- A delightful open floor plan enhances this spacious Craftsman house plan with a vaulted sunroom and great rear deck perfect for enjoying the views.
- From the foyer, you can see the formal dining room with tray ceiling or step right to the quiet study. A coat closet in the foyer minimizes clutter.
- In the rear, the family room is open to the huge kitchen with island. A door takes you to the expansive deck and the vaulted sunroom with windows on three sides is steps away. In the family room, the fireplace is flanked by built-ins.
- More clutter reducing is accomplished in the locker room off the garage entrance. A built-in bench there and inside the door are nice touches. A large laundry room, half bath and pantry complete the floor.
- The master is vaulted and there is a spa-like bath with dual vanities, bath, walk-in shower and walk-in closet. Two of the three remaining bedrooms have a sitting area. And a built-in desk in the hall is a great use of extra space.
- Related Plans: For an alternate elevation and a reverse layout, see house plan 14337RK.
- Need more space? See house plan 14344RK (3,289 s.f.).
- Need a side-entry garage? See house plan 14327RK (2,734 s.f.).

Style: Country, Craftsman, Northwest

Total Living Area: 2982

Main Flr.: 1563

2nd Flr.: 1419

Basement Unfinished: 1,419 sq. ft.

Front Porch: 280 sq. ft.

Deck: 192 sq. ft.

Total Square Feet: 5,715 sq. ft.

Attached Garage: 3 Car, 842 sq. ft.

Bedrooms: 4

Full Bathrooms: 2

Half Bathrooms: 1

Width: 80'

Depth: 49'8"

Maximum Ridge Height: 29'6"

Exterior Walls: 2x6

Ceiling Height:

Main Floor: 9'

2nd Floor: 8'

Other: 11'9" Vaulted MBR; 9' Basement; 12' Vaulted Sun Room

Standard Foundations: Walkout

Alternate Foundations: Slab (\$350), Crawl (\$350)

Special Features: Photo Gallery, PDF, CAD Available, Den-Office-Library-Study, Sloping Lot

One Set	Five Sets	Eight Sets	Reproducible	PDF File	CAD
\$550	\$600	\$690	\$800	\$800	\$995

Main Level

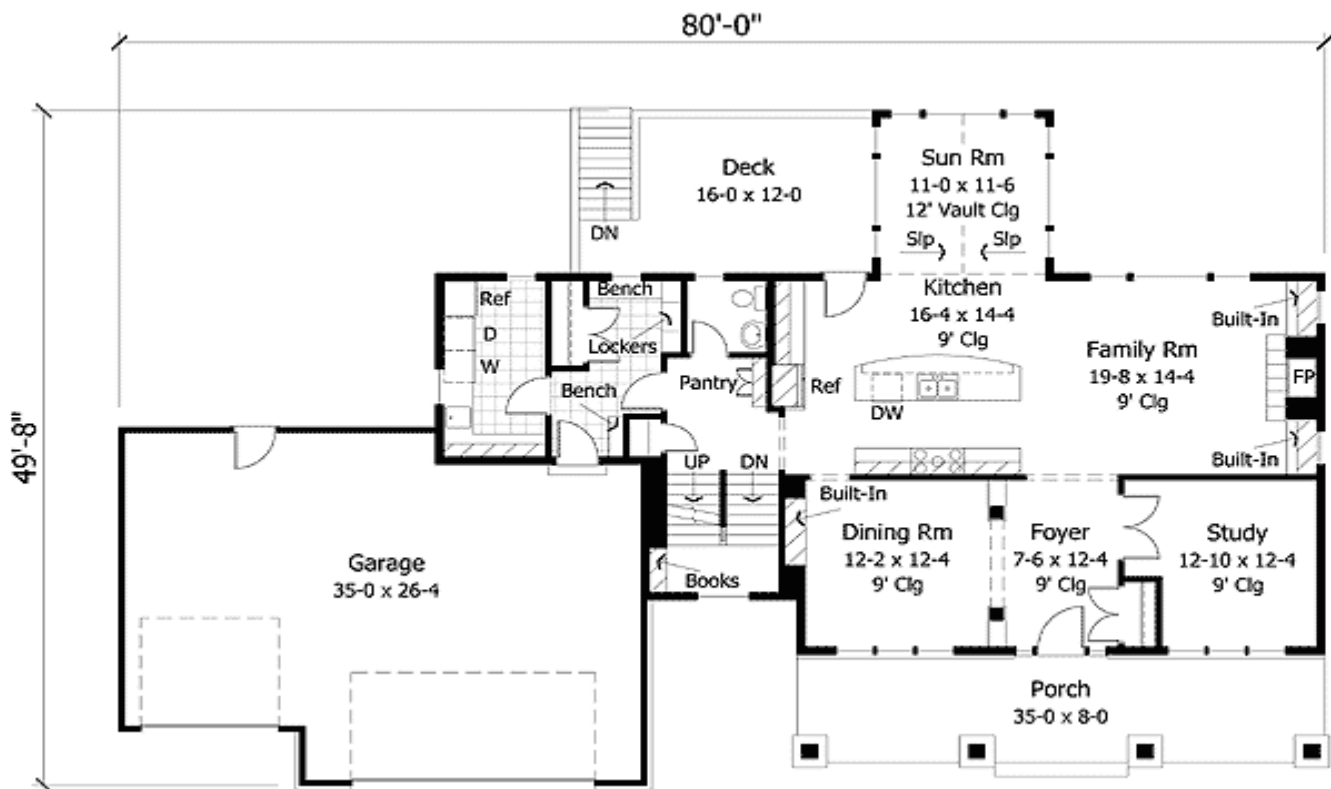

2nd Level

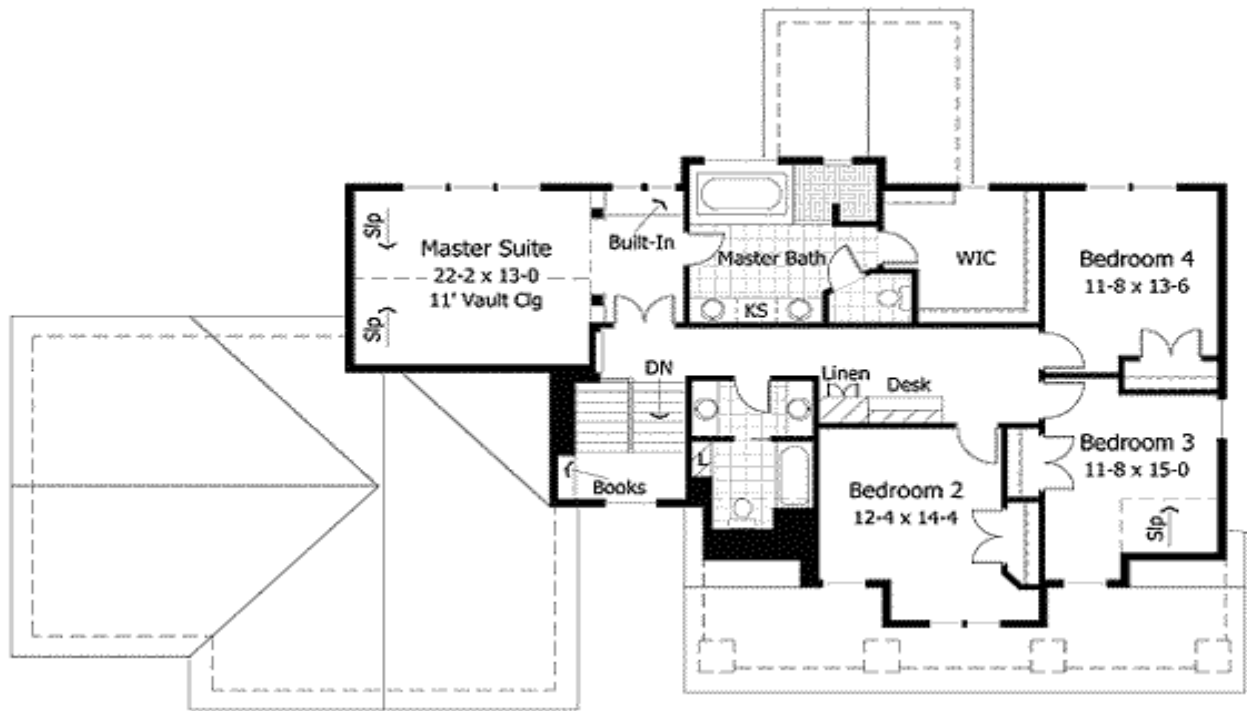

Architectural Designs ...selling quality house plans for over 30 years.

Photo



Architectural Designs ...selling quality house plans for over 30 years.

Elevation #2



Rear View



Dining Room



Kitchen



Kitchen Vw2



Family Room



Family Vw2



Sunroom

