

Architectural Designs ...selling quality house plans for over 30 years.

Plan W51035MM: Full-Featured Duplex Plan



House plans are Copyright © 2009 by our architects and designers.

- This is a full-featured duplex plan that is both simple and cost-effective to build. This plan provides an excellent value in space planning, and includes several key features that help to minimize the overall cost-to-build, including the shape of the building, hip roof, and 8 ft. ceiling heights.
- Other unique features of this home design include: highly-effective use of space for the amount of square footage (2 bedrooms, 1.5 baths); plenty of built-ins, patio for grilling, covered front porch, and great street appeal. A winner for both builders and owners!

Style: Multi-Family

Total Living Area: 1890

Main Flr.: 990

2nd Flr.: 900

Front Porch: 72 sq. ft.

Total Square Feet: 1,017 sq. ft.

Bedrooms: 2

Full Bathrooms: 1

Half Bathrooms: 1

Width: 33'

Depth: 30'

Maximum Ridge Height: 25'3

Exterior Walls: 2x4

Ceiling Height:

 Main Floor: 8'

 2nd Floor: 8'

Standard Foundations: Slab

Special Features: CAD Available, PDF, Narrow Lot

One Set	Five Sets	Eight Sets	Reproducible	PDF File	CAD
\$585	\$645	\$780	\$805	\$805	\$1,305

Main Level

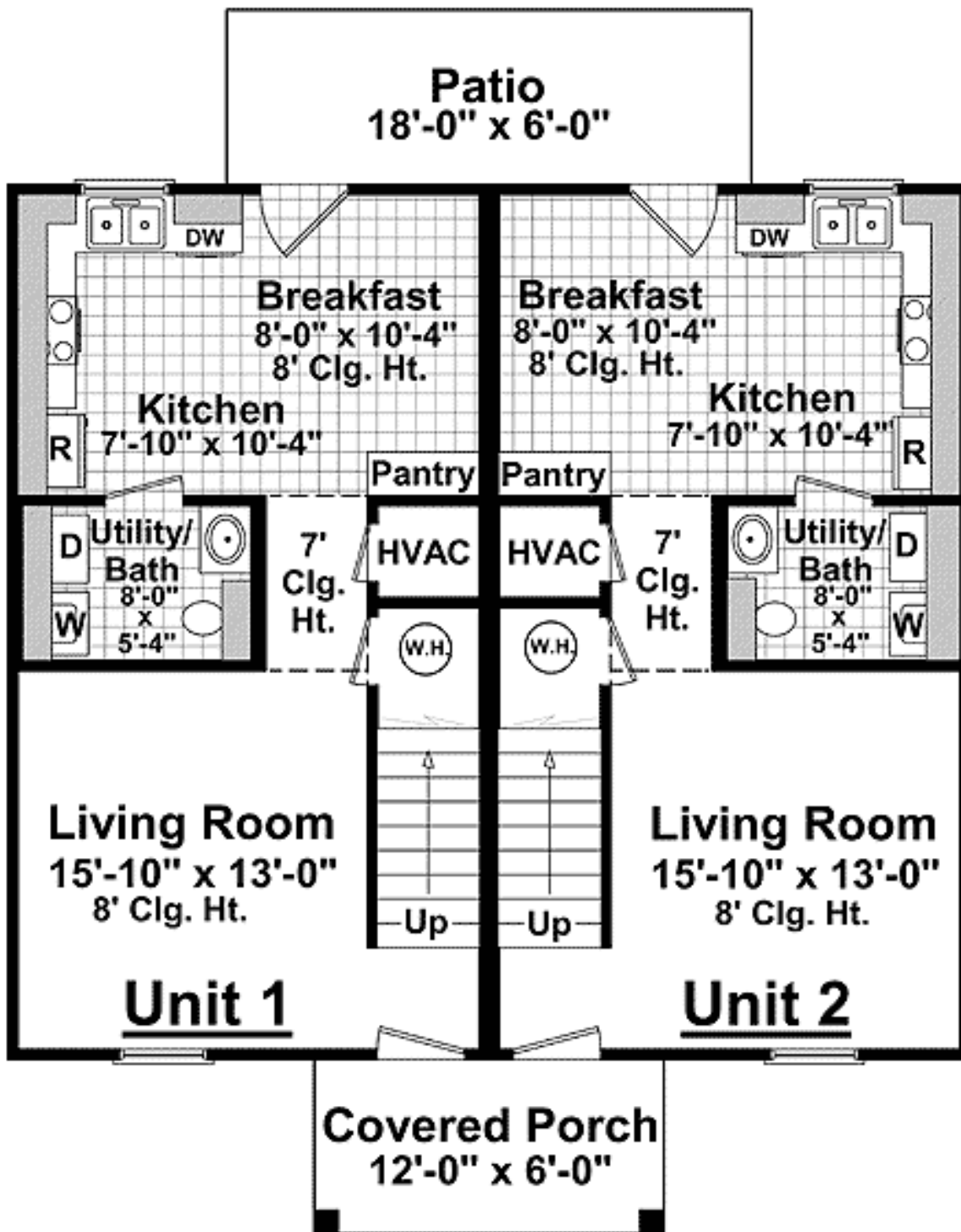

2nd Level

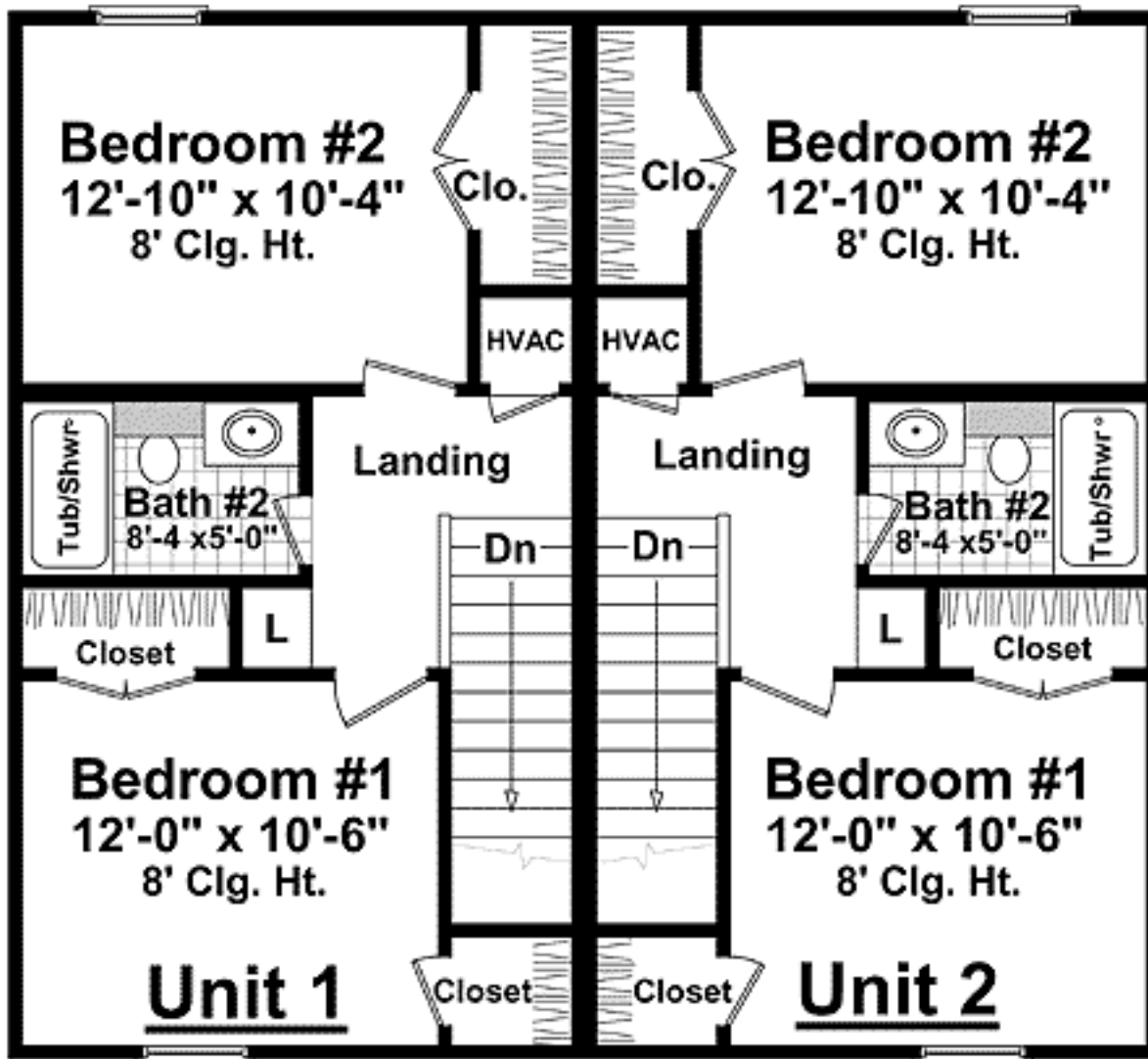

Rear View

