

Architectural Designs ...selling quality house plans for over 30 years.

Plan W24006BG: Mediterranean Design



House plans are Copyright © 2009 by our architects and designers.

- Part of the Premium Collection, this gorgeous Florida-Mediterranean design is filled with imaginative and luxurious touches.
- A charming courtyard leads guests to the entry porch and the foyer. From here, they see the formal dining room, the parlor and the study, all with distinctive ceiling treatments.
- To one side, the master suite has it all: his and her walk-in closets and vanities and a magnificent spa tub introduced by columns.
- The kitchen is convenient to the formal dining room, informal dinette and gathering room.
- There are two guest suites, one off the gathering room and the other on the second floor.

Style: Florida, Luxury, Mediterranean, Premium Collection

Total Living Area: 3831

Main Flr.: 3380

2nd Flr.: 451

Balcony/Veranda: 285 sq. ft.

Lanai: 732 sq. ft.

Entry: 181 sq. ft.

Courtyard:

Total Square Feet: 6,184 sq. ft.

Attached Garage: 3 Car, 897 sq. ft.

Bedrooms: 3

Full Bathrooms: 3

Half Bathrooms: 1

Width: 119'8"

Depth: 102'6"

Maximum Ridge Height: 29'

Exterior Walls: Block

Ceiling Height:

Main Floor: 12'

2nd Floor: 9'

Other: 10' Master Bath & Garage; 10'-11'-12' MBR; 12'-13'-14' Parlor & Study; 12-13' Dining Room; 9-11' 2ns Floor Suite
Standard Foundations: Slab
Special Features: Photo Gallery, In-Law Suite, PDF, Court Yard, CAD Available, 1st Floor Master Suite, Den-Office-Library-
Study

Five Sets	Reproducible	PDF File	CAD
\$2,800	\$3,000	\$3,000	\$3,250

Main Level

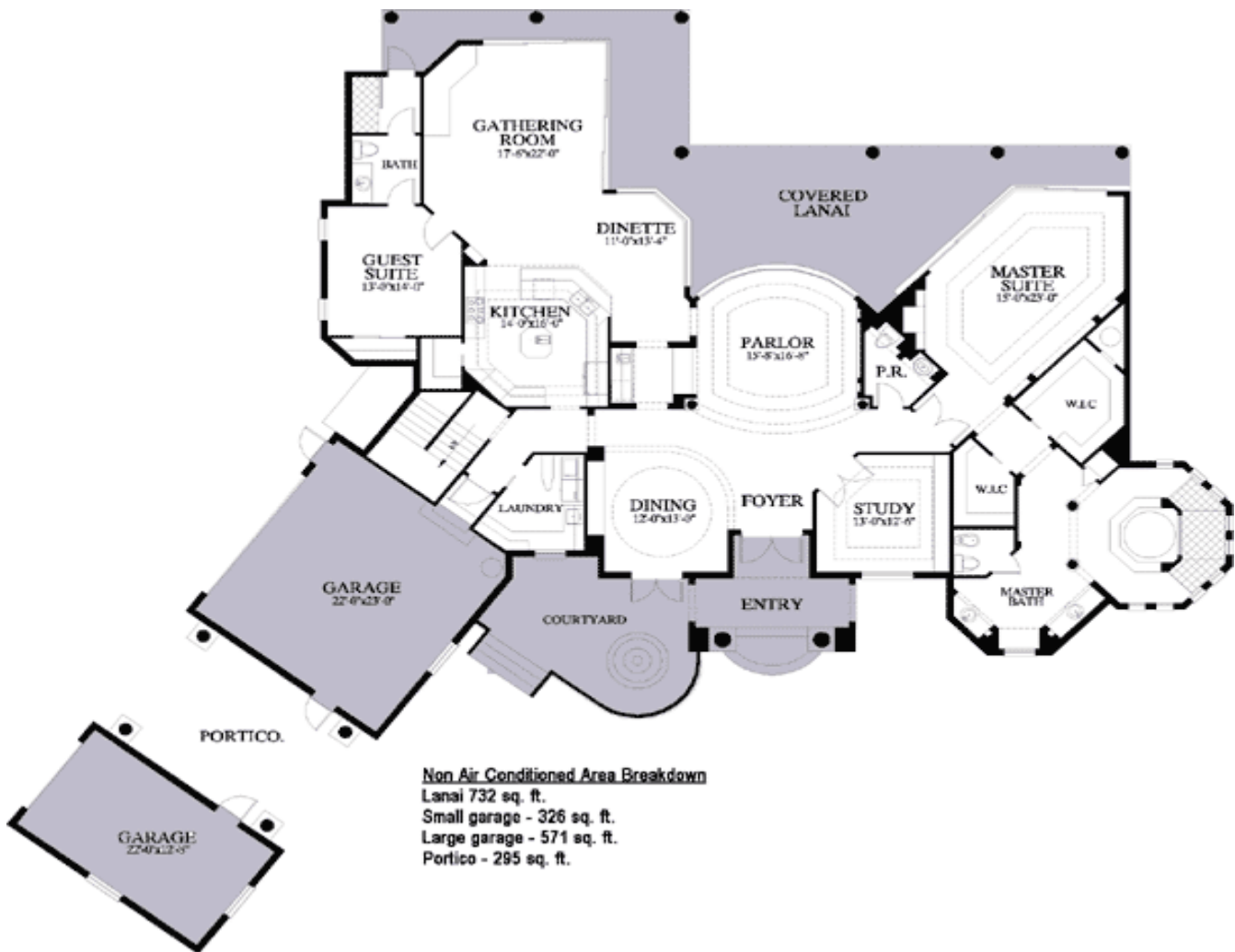

2nd Level



Rear View



Dining Room



Kitchen



Nook



Family Room



Master Bath



Mstr Bath V2



Lanai

