

# Architectural Designs ...selling quality house plans for over 30 years.

Plan W55058BR: Minimum Hall Space, Maximum Living Space



House plans are Copyright © 2009 by our architects and designers.

- This compact one-story design with an attractive exterior is constructed for energy efficiency.
- Minimizing hall space, most rooms are grouped around the living room. The living room rises to 10' and has a fireplace.
- The open dining area and kitchen are adjacent, separated by a peninsula with an eating bar and a pantry closet.
- The master suite includes a designer bath, a walk-in closet and a sitting area. On the other side of the house, two family bedrooms share the other bath. One of these bedrooms has a ceiling sloping to 9'.
- Ceilings: 8' standard.
- Foundation options: slab or crawl space. Please specify when ordering.
- For a 2x4 framed version of this house plan, see 5526BR.

Style: European

Total Living Area: 1470

Main Flr.: 1470

Front Porch: 22 sq. ft.

Rear Porch: 104 sq. ft.

Storage: 75 sq. ft.

Total Square Feet: 2,112 sq. ft.

Attached Garage: 2 Car, 441 sq. ft.

Bedrooms: 3

Full Bathrooms: 2

Width: 54'

Depth: 50'

Maximum Ridge Height: 25'

Exterior Walls: ICF

Ceiling Height:

Main Floor: 8'

Other: 10' Living Room

Standard Foundations: Slab

Alternate Foundations: Basement (\$50), Crawl (no charge)

Special Features: 1st Floor Master Suite, PDF

One Set	Five Sets	Eight Sets	Reproducible	PDF File	CAD
\$489	\$554	\$594	\$694	\$694	\$1,388

## Main Level

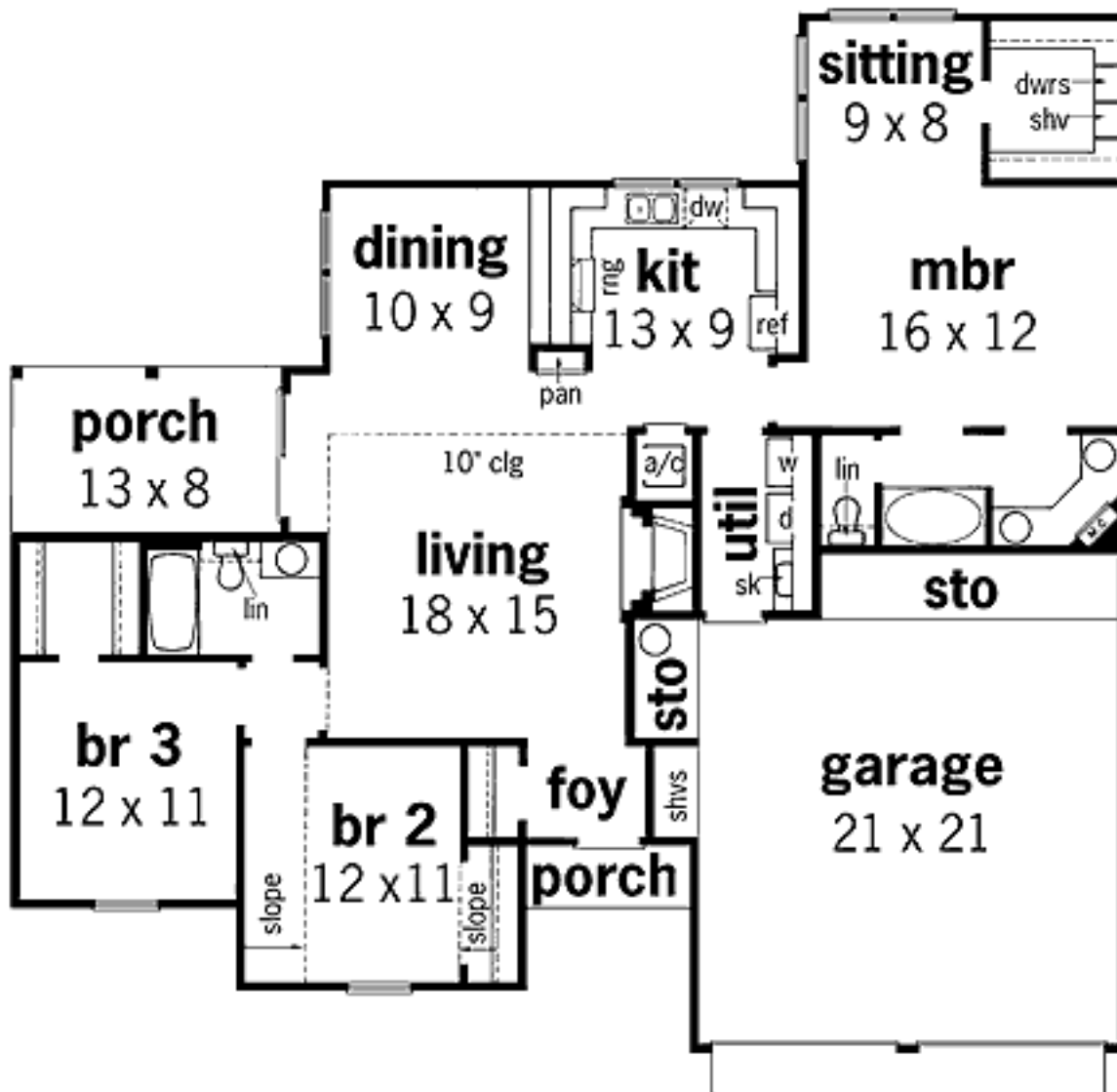

# Architectural Designs ...selling quality house plans for over 30 years.

Photo

