

# Architectural Designs ...selling quality house plans for over 30 years.

Plan W1704LV: Luxury Galore



House plans are Copyright © 2009 by our architects and designers.

- A covered skylit lanai and a deck (available only with the basement version) extend the living area to the outdoors of this transitional home plan.
- The foyer leads to the central grand room and the formal dining room, which is marked by columns. The open family area comprises the fireplaced gathering room, a breakfast area and a good-sized gourmet kitchen with an angled snack bar.
- On one side of the house, the master suite is filled with luxuries, including a morning bar, a sitting area, generous his and her walk-in closets and a deluxe bath. On the other side, the two bedrooms each access a shared bath.
- Ceilings: 9' standard; 10'6" in master bedroom and dining room; 11' foyer, master bath; 13'10" in vaulted great room; 13' vaulted gathering room.

Style: European

Total Living Area: 2452

Main Flr.: 2452

Basement Unfinished: 1,473 sq. ft.

Bonus: 427 sq. ft.

Total Square Feet: 4,826 sq. ft.

Attached Garage: 2 Car, 474 sq. ft.

Bedrooms: 3

Full Bathrooms: 2

Half Bathrooms: 1

Width: 58'

Depth: 76'

Maximum Ridge Height: 23'6"

Exterior Walls: 2x4

Ceiling Height:

Main Floor: 9'

Other: 11' Foyer; 9'-10' Tray MBR & Dining Room; 9'-11' Cathedral Master Bath; 9'-12'3" Cathedral Great Room

Standard Foundations: Crawl

Special Features: Split Bedrooms, CAD Available, Jack & Jill Bath, 1st Floor Master Suite, MBR Sitting Area, Photo Gallery, PDF, Bonus Room

Five Sets	Reproducible	PDF File	CAD
\$1,000	\$1,350	\$1,350	\$2,700

## Main Level

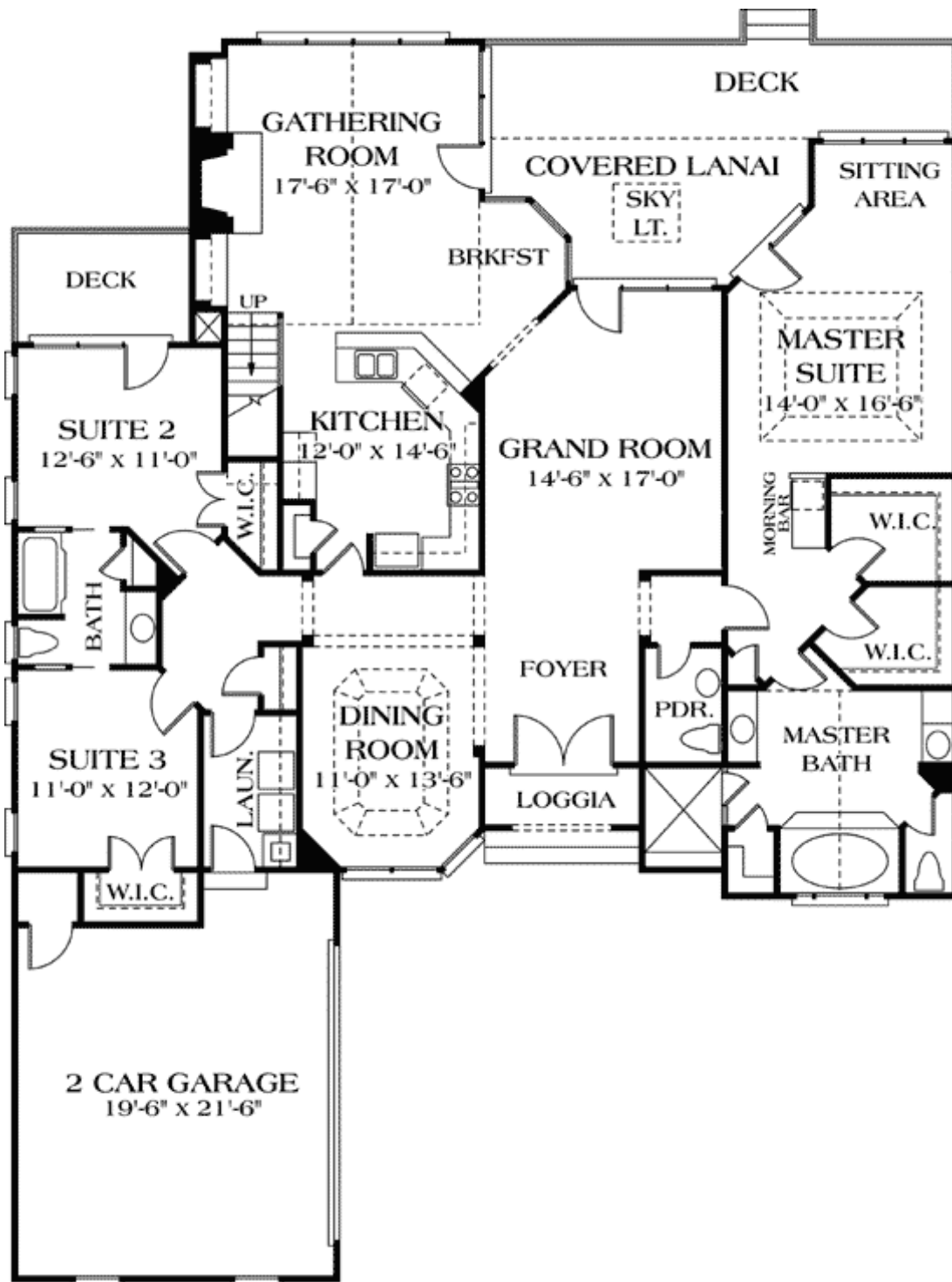

Bonus

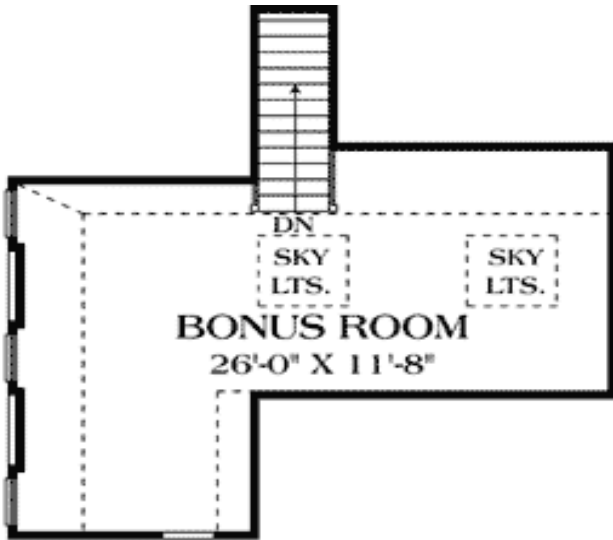

# Architectural Designs ...selling quality house plans for over 30 years.

Photo



Rear View

