

Architectural Designs ...selling quality house plans for over 30 years.

Plan W23314JD



House plans are Copyright © 2009 by our architects and designers.

Style: Country, Luxury, Premium Collection, Traditional

Total Living Area: 5315

Main Flr.: 2412

2nd Flr.: 2903

Bonus: 865 sq. ft.

Total Square Feet: 7,105 sq. ft.

Attached Garage: 3 Car, 925 sq. ft.

Bedrooms: 5

Full Bathrooms: 4

Width: 88'

Depth: 72'

Maximum Ridge Height: 35'11"

Exterior Walls: 2x6

Ceiling Height:

Main Floor: 9'1"

2nd Floor: 9'1"

Other: 2-Story Foyer

Standard Foundations: Crawl

Special Features: PDF, CAD Available, Bonus Room, Butler Walk-in Pantry, Jack & Jill Bath, Wrap Around Porch, Photo Gallery, Corner Lot

One Set	Five Sets	Eight Sets	Reproducible	PDF File	CAD
\$1,150	\$1,195	\$1,250	\$1,450	\$1,450	\$2,450

Main Level

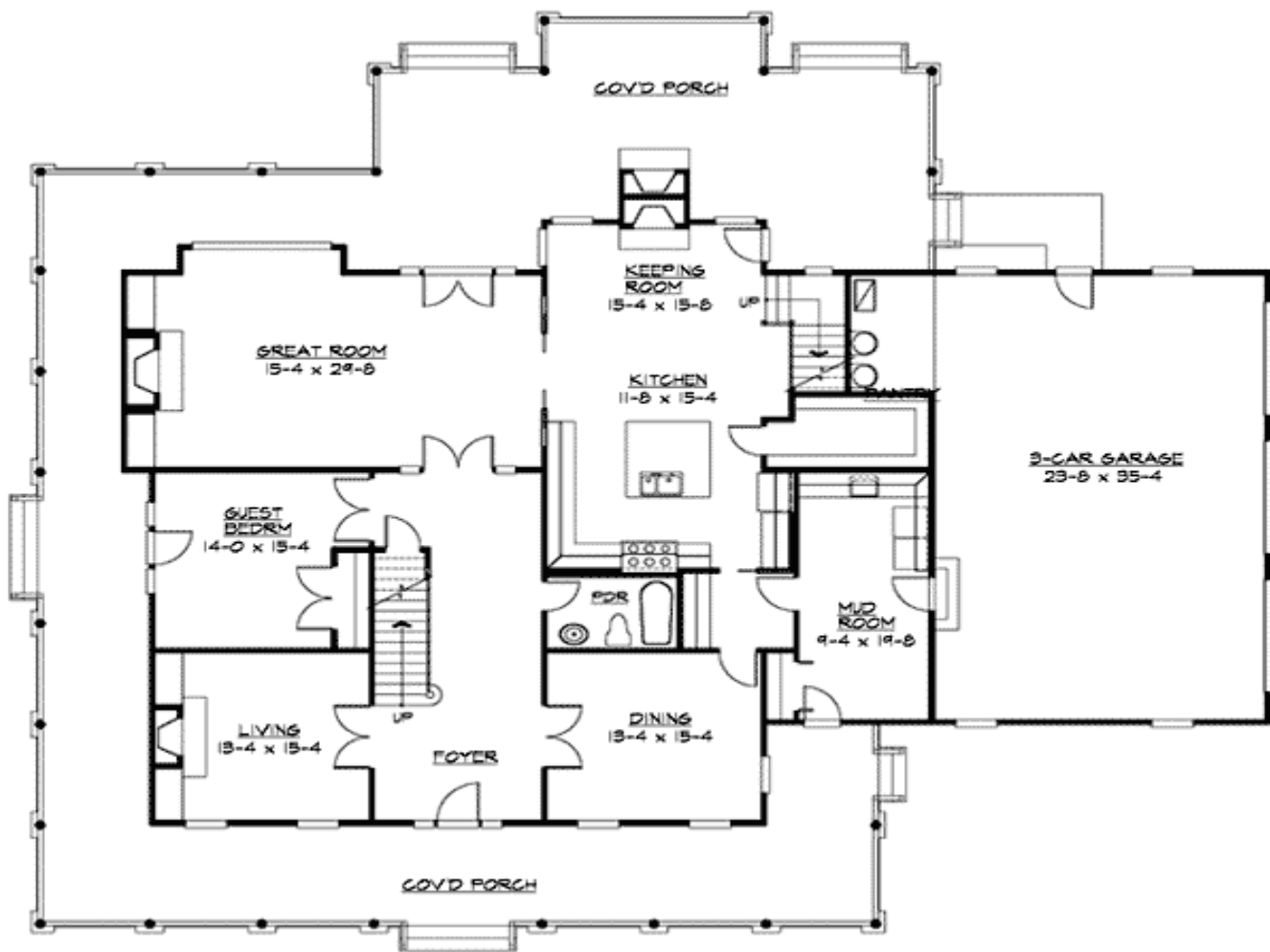

2nd Level

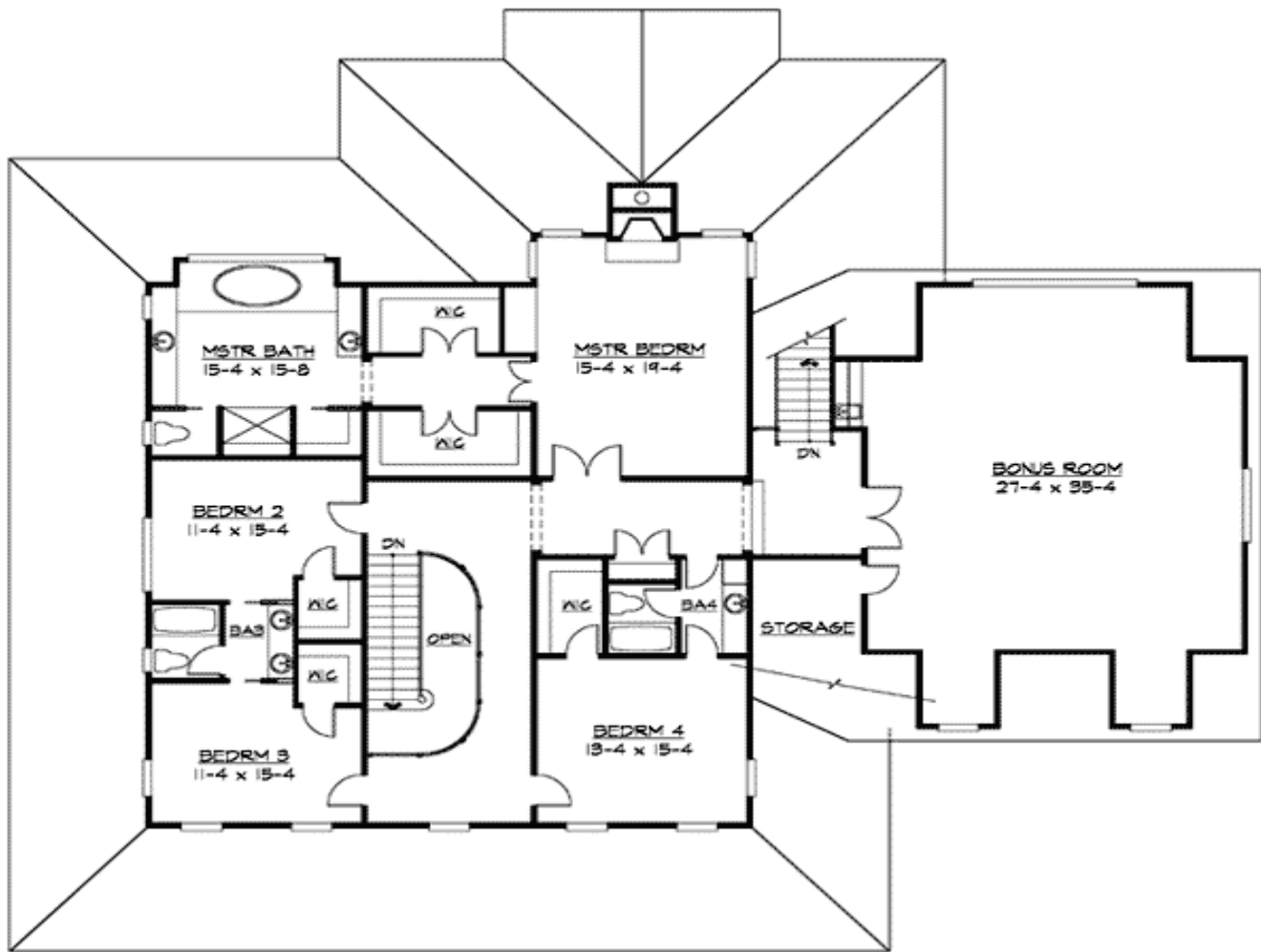

Architectural Designs ...selling quality house plans for over 30 years.

Photo



Architectural Designs ...selling quality house plans for over 30 years.

Photo #2



Photo #3



Elevation #2



Rear View



Foyer



Kitchen



Stairway

