

Architectural Designs ...selling quality house plans for over 30 years.

Plan W32102AA: Luxurious Mediterranean



House plans are Copyright © 2009 by our architects and designers.

- This luxurious, one-story, Mediterranean-style home plan features four bedrooms, four and one-half bathrooms, a cabana bath and two-car garage featuring workspace and golf cart parking.
- Exquisite French doors with arched transom accent the entrance.
- The living room is spacious and perfect for entertaining.
- There is a simply luxurious master suite welcoming you with two sets of double French doors. From there taking you to the pool deck.
- The master bathroom is amply spacious.
- You will love this design if you seek a home offering a spacious feeling and possessing many private places.

Style: Florida, Luxury, Mediterranean, Spanish

Total Living Area: 5480

Main Flr.: 5480

Front Porch: 319 sq. ft.

Covered Patio: 458 sq. ft.

Total Square Feet: 6,969 sq. ft.

Attached Garage: 2 Car, 712 sq. ft.

Bedrooms: 4

Full Bathrooms: 5+

Half Bathrooms: 1

Width: 132'3"

Depth: 98'5"

Maximum Ridge Height: 23'3"

Exterior Walls: Block

Ceiling Height:

Main Floor: 10'

Other: 12'-12'8" Entry; 10'11' Living Room; 12'-13'4" Library; 12'-13'4" Dining Room; 10'-11'4" Retreat

Standard Foundations: Slab

Special Features: PDF, CAD Available, 1st Floor Master Suite

One Set	Five Sets	Eight Sets	Reproducible	PDF File	CAD
\$1,100	\$1,300	\$1,450	\$1,600	\$1,600	\$1,950

Architectural Designs ...selling quality house plans for over 30 years.

Main Level

132'-3"

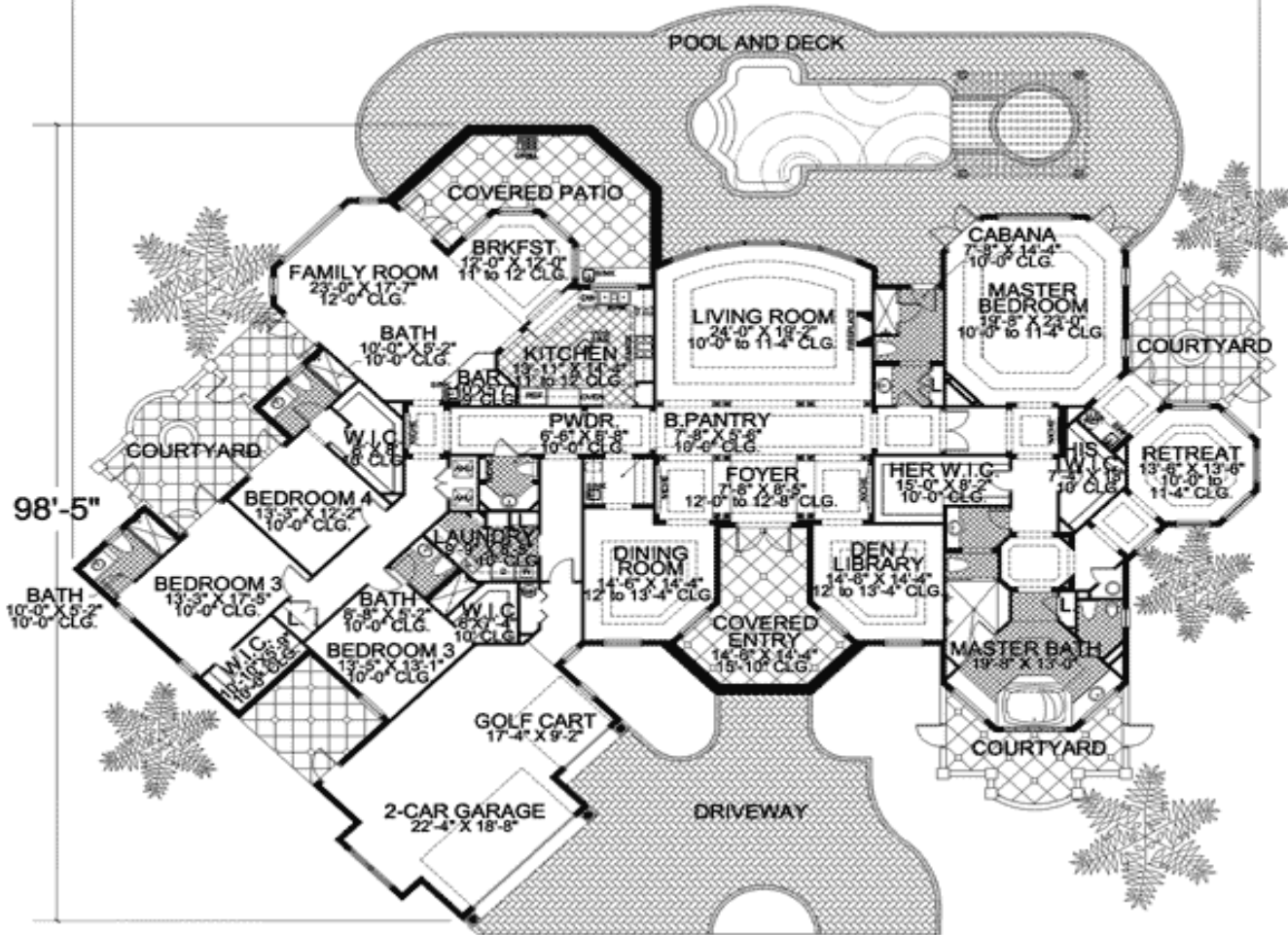

Architectural Designs :: 57 Danbury Road :: Wilton, CT 06897

USA & Canada 1-800-854-7852 or 1-877-229-2447 :: International 262-521-4596

Fax 1-203-761-8600 :: Email: info@architecturaldesigns.com

Architectural Designs ...selling quality house plans for over 30 years.

Elevation #2



Sides/Rear



REAR ELEVATION



LEFT ELEVATION



RIGHT ELEVATION