

## Plan W51080MM: Craftsman House Plan with Options



House plans are Copyright © 2009 by our architects and designers.

- A foyer, formal dining room, fourth bedroom, and half bath are all extras that you would expect to find in a much larger home. The great room includes vaulted ceilings, built-in cabinets and a gas log fireplace. The kitchen is well-equipped and is located within close proximity to the breakfast area, dining room, and garage entrance.
- The master suite includes a trayed ceiling, dual lavatories, compartmented toilet, whirlpool tub, separate shower, and his and hers closets. Three other bedrooms also feature individual walk-in closets and share a bath with separate tub and toilet room.
- The front and rear porches provide perfect outdoor living space. The bonus room is also a great place for a playroom / gameroom and even has space for a future bath.
- The many available features and flexibility of this home make it the perfect choice for you and your family.
- Related Plans: Need a basement? See house plan 51084MM. Downsize to three bedrooms with house plan 51079MM.
- For alternate exteriors. see 51062MM (Traditional styling) and 51061MM (European styling).

Style: Craftsman, Northwest

Total Living Area: 2100

Main Flr.: 2100

Bonus: 348 sq. ft.

Front Porch: 192 sq. ft.

Rear Porch: 237 sq. ft.

Total Square Feet: 3,547 sq. ft.

Attached Garage: 2 Car, 670 sq. ft.

Bedrooms: 4

Full Bathrooms: 2

Half Bathrooms: 1

Width: 69'

Depth: 57'

Maximum Ridge Height: 24'2"

Exterior Walls: 2x4

Ceiling Height:

Main Floor: 9'

Other: Vaulted Great Room; 9'-10' Dining & MBR

Standard Foundations: Slab, Crawl

Alternate Foundations: Basement (\$275)

Special Features: 1st Floor Master Suite, Split Bedrooms, Photo Gallery, CAD Available, PDF, Bonus Room

One Set	Five Sets	Eight Sets	Reproducible	PDF File	CAD
\$645	\$705	\$840	\$865	\$865	\$1,415

## Main Level

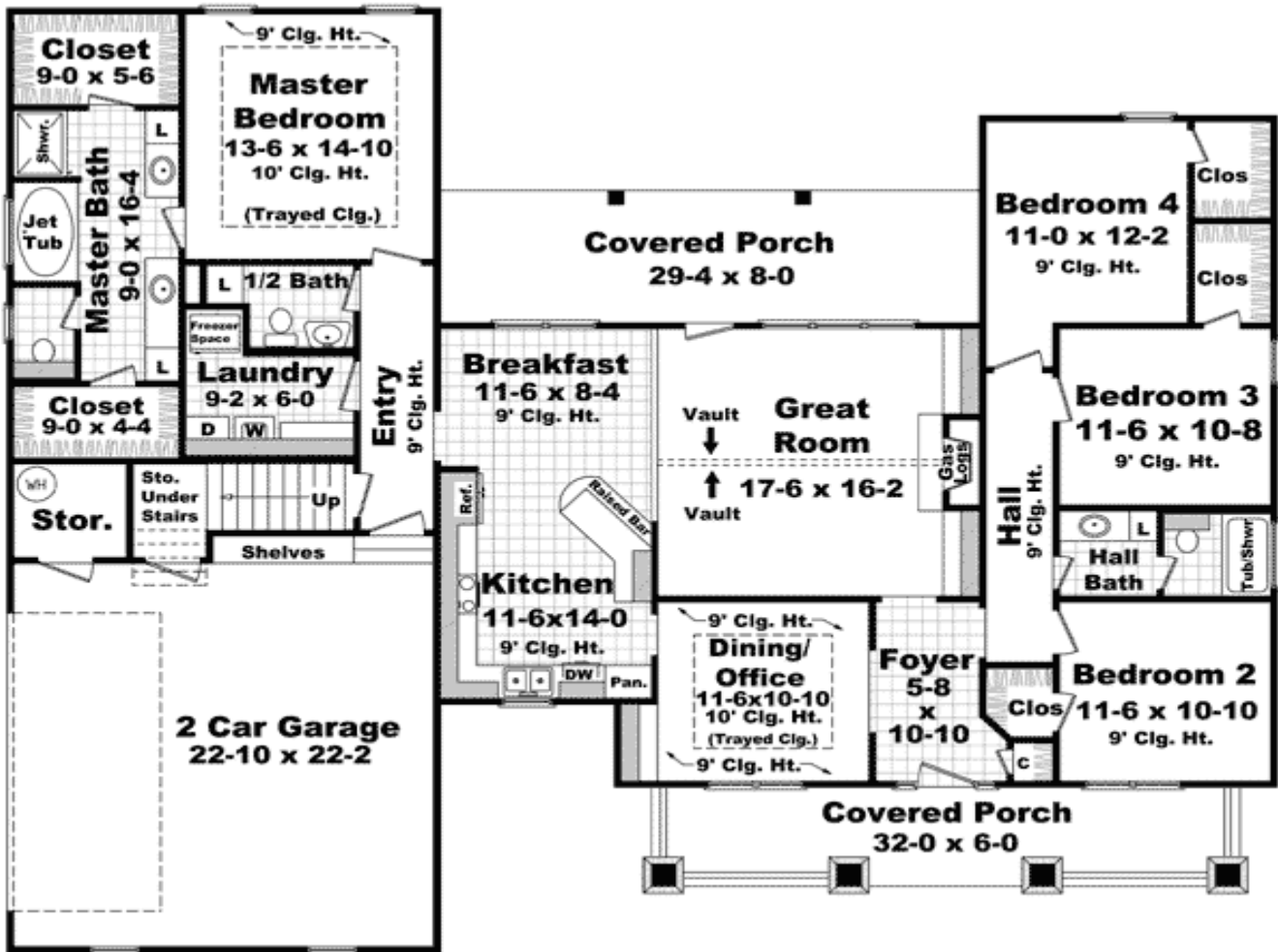

## Bonus

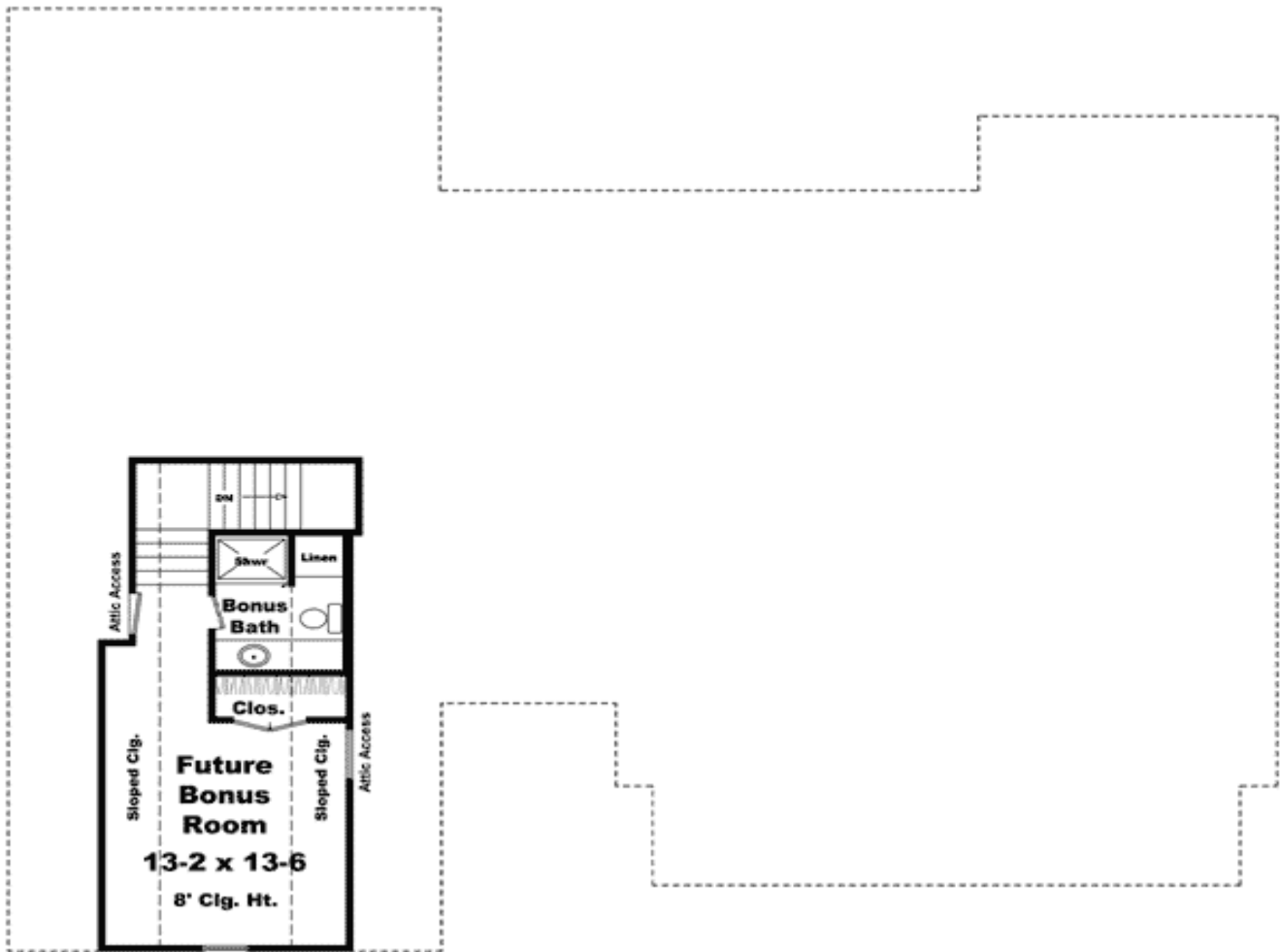

Rear View



Great Room



Master BR



Master Bath



Mstr Bath V2

